

# Woodworkers Club of Houston

Volume 12, Number 9, September, 1996

## August Meeting

The directories have been mailed out. There are seven left which will go to new members on a first come basis, so join soon. Name tags and membership cards are coming.

### Visitors:

Bill Wright from Conroe,  
Charles Lewis from Conroe,  
Roger Chisholm from Houston,  
Marcus Brun from Houston,  
Miles Hobdy from Sharpstown,  
Joe Eaglin from Missouri City

Membership dues are \$24 a year, or prorated to \$2 a month for the rest of the year. Thank you for visiting. We invite you to join the club.

### New Members:

Marcus Brun  
5462 Birdwood Road  
Houston, Texas 77096  
Home (713) 668-9131  
Work (713) 263-2186

Hugh D. Parker  
3108 Lafayette  
Houston, Texas 77005  
(713) 668-5898

Bill Wright  
121 Stephen F. Austin  
Conroe, Texas 77302

Dan Knapheide  
15234 Ensenada  
Houston, Texas 77083

J. C. Stewart  
15321 Mauna Loa  
Houston, Texas 77040  
Home (713) 466-4354  
Work (713) 735-4626

J. C. Stewart joined in May. Welcome to the club.

### Want Ads:

Padouk - 7/8" x 1 1/4" x 7" - 10 pieces per bag - \$5 per bag. See Sharon Buckley. Sharon wants to buy a 12" riser for a Delta Bandsaw.

### Book and Video Libraries:

The book and video library is available, free of charge, to all members. A late fee of \$1 a month is charged on all past due books, and \$5 a month on all past due videos. If you see a book or video that you would like to have in the library (must pertain to wood, woodworking, or tools, etc.) make your suggestions to your friendly librarians.

Andy Anderson will take over the video library for Denis Muras for the next two months. If he comes to the meeting with black rings under his eyes, we will know that he personally checked every video.

### Show and Tell:

Bill Hochmuth had a folding book stand that a friend of his brought from India. It was all hand made from a single piece of wood. No glue or fasteners were used in the construction. The scroll work was hand cut. It was resawn to the hinge which was chiseled out by hand. It was unique.

Dan Shaklovitz brought his rosette jig which was featured in "Woodworker's Journal, Feb. 96". It would index every 15 degrees. It is used with a router and a v-bit. He explained its use and his improvements to it.

### **Problems and Solutions:**

A good substitute for foam brushes is carpet padding and a piece of wood for a handle.

Joe Cook bought a Delta tenoning jig and it would not fit properly on his Powermatic Saw. One solution was to build your own. Joe took his jig to a machinist who repositioned the key so it would line up properly. It must have worked. He hasn't come back yet.

A source was needed for cork board for bulletin boards. The suggestion was Home Depot. Andy uses builders board from Stahlmans.

Use frost board for marker board.

A substitute for slate chalkboard is masonite painted with chalkboard paint.

Saul Harris needed brass bushings for a jig to drill shelf holes. Woodworkers Supply was recommended as a source. He uses peg board for spacing.

### **Raffle:**

A dovetail saw, a hold down clamp, candle cups, a hone guide, and 8 bags of pencil kits were donated by Brad Hartman, Manager of Woodcraft Supply.

A sanding drum kit, a saw blade storage container, and a zero clearance table saw insert were donated by Steve LeGrue, owner of The Cutting Edge.

The proceeds from the raffle go to the libraries.

The best way to thank the sponsors of the raffle is to shop at their stores and spend money.

### **Charity Project:**

A charity project was discussed and unanimously approved. Mike Turner read a list of charities and their needs. The Board is looking at making outdoor benches and footlockers. A final determination will be made at the next meeting. Be ready to volunteer. You will be richly rewarded.

### **Program:**

Don Richardson gave an excellent program on The Dynamics of Joints. He started the program by explaining the differences between flat and quarter sawn boards and the three different types of shrinkage.

In his hand out, he had drawings of different kinds of joints. He went into great detail to explain the advantages and weaknesses of each joint and how to orient the growth rings so that the shrinkage of the wood will actually tighten the joint. Don had samples of the joints pictured in the handout and passed them around for all to see.

I really enjoyed this informative program. A beginner woodworker, like myself, would have never thought of these things when building a project. Don, and other members, have vast knowledge of wood-working and are willing to share it with others. This is what makes membership worthwhile.

There are extra handouts in the library for those who need a copy.

---

## **Bar-B-Que**

The Woodworkers Club annual Bar-B-Que will be on October 26, 1996 at Jimmie and Brian's Shop at 848 1/2 West 24th Street in the Heights. Admission will be \$5.00 per person. This includes delicious food and soft drinks. Bring your own chairs.

Jet Machinery will be supplying major door prizes. Saw blades and hammers will also be given as door prizes. You must be a member and you must be present to win.

Charlie Sylvester should have more details on door prizes at the meeting. See Jimmie Harp to pay for the bar-b-que.

---

### **Safety:**

Every shop should have a first aid kit. Most kits have an antiseptic and various dressings for your cuts. The most used dressing is a Band-Aid. Have you ever wondered who invented them and when? Well here is the answer.

In 1921 Earle Dickson, an employee of Johnson & Johnson, married a woman who kept injuring herself in the kitchen. As Earle carefully bandaged her cuts and burns with gauze and adhesive tape numerous times, he became frustrated; the clumsy bandages kept falling off. So he decided to create something "that would stay in place, be easily applied, and still retain its sterility.

So Mr. Dickson stuck some gauze in the center of a piece of adhesive tape, and covered the whole thing with crinoline to keep it sterile. It worked. He made up a bunch for his wife, and took a few in to show his co-workers.

The company's owner, James Johnson, heard about it and asked for a demonstration - which convinced him to begin manufacturing the product.

By the 1980s, over 100 billion Band-Aids had been sold. Dickson, who became an executive at Johnson & Johnson was amply rewarded.

## July Meeting

- When:** September 14, 1996 9:00 AM
- Where:** Bayland Community Center  
on Bissonnet at Hillcroft
- Program:** Lewis Vallette - Make your own tools
- Raffle:** 2- 7 piece forstener sets donated by Brad Hartman of Woodcraft Supply and items to be announced.

### Items Of Interest:

The Cutting Edge has "Free Saturday Tool and Technique Basics Seminars" - 11:00 am to Noon. Unlimited attendance, Free to the public.

Woodcraft has "Sawdust Sessions" on Thursday nights from 7:00 - 8:00 PM. Free to the public.

Ceramic Show will be at the Astroarena September 27-29.

Texas Holiday Home & Vacation & Leisure & Texas Home & Personal Computer Shows will be at the Astrodome North Expo Hall on October 11-13.

Southern Lady Arts & Crafts Show will be at the Pasadena Convention Center October 12- 13.

International Gem and Jewelry Show will be at the Astrodome North Expo Hall October 18-20.

Back To Grandma's Attic Craft Show will Be at the Pasadena Convention Center October 19 - 20.

Camper Show will be at the Astroarena on October 23-27

Country at Heart Arts and Crafts Show will be at the Pasadena Convention Center November 16-17.

Autorama at the Astrohall/Arena Nov.28 - Dec.1.

Back to Grandma's Attic Craft Show will be at the Pasadena Convention Center Nov. 30 - Dec. 1.

Boy Scout Fair at the Astrohall on December 7.

Southern Lady Arts and Crafts Show at the Astroarena on December 7-8.

The Antique, Collectibles & Crafts Market at the Astrohall on December 14-15.

Country At Heart Arts and Crafts Show will be at the Pasadena Convention Center December 14-15

The Wooden Boat Festival at Madisonville Louisiana September 28-29. The largest gathering of historic, antique, classic, and contemporary wooden sail, power, rowing, and steam watercraft in the South.

Bayou Bend is a must see if you like antique furniture, antiques and gardens. A color bulletin of the collection, plus other information is in the library.

## Jimmie's Corner

The **Northside Splinter Group** meets on the first and third Monday of each month from 7:00 - 9:00 P.M. at Jimmie Harp's shop, at 848 1/2 west 24th street. 862-7222.

We will start working on the charity project on September 16, 1996. Come join us.

Official WwCH Knit Shirts can now be ordered in small quantities. If you order your shirt at the August meeting, It should be ready at the September meeting.

Prices are:

Small, Med., Lg., XLg. \_\_\_\_\_ \$24.36

XXLg. \_\_\_\_\_

\$25.38

XXXLg. \_\_\_\_\_

\$25.98

XXXXLg. \_\_\_\_\_

\$27.06

These shirts are embroidered, not printed.

### Officers

President	Saul Harris	341-5373
Vice President	Charles Sylvester	774-6551
Sec.'y/Treas.	Clara Pitts	694-7195

### Services

Book Library	Bob Gilbertson	869-7081
Video Library	Dennis Muras	943-7745
Literature Search	Don Richardson	661-1365
Name Tags	Mike Turner	988-1485
Coffee	Loretta Buckley	944-6739
	Bill Hochmuth	774-1733

### Directors

Andy Anderson	723-1030
Art Chester	469-1990
Jimmie Harp	683-9033
Lee Palfreyman	497-7085
By Reed	980-9793
Mike Turner	988-1485

### Newsletter Editor

Bob Gilbertson	869-7081
----------------	----------

### Newsletter Distribution

Thad Brown	522-8364
------------	----------

# The Dynamics of Joints

## And Repairing the "Oops" in a Joint

Longitudinal shrinkage - Shrinkage along the length of the wood.

Radial shrinkage - Shrinkage in a direction across (perpendicular to) the growth rings.

Tangential shrinkage - Shrinkage along or in the direction of the growth rings.

Wood type	Radial shrinkage	Tangential shrinkage
Mesquite	2.2%	2.6%
Red Oak	4.7%	11.3%
Hickory	7.7%	11.0%
Pecan	4.9%	8.9%
Yellow Pine	4.8%	7.4%
Maple	4.8%	9.8%
Cottonwood (Poplar)	3.9%	9.2%

Ring length tends to shrink more than ring thickness. (Tangential shrinkage is greater than radial shrinkage).

If mortise cheeks are parallel to the growth rings, using flat sawn wood for the rail will result in a stable joint.

If mortise cheeks are parallel to the growth rings, using quarter sawn wood for the rail will result in a loosening joint.

If mortise cheeks are perpendicular to the growth rings, using quarter sawn wood for the rail will result in a stable joint.

If mortise cheeks are perpendicular to the growth rings, using flat sawn wood for the rail will result in a tightening joint.

The **Slip Joint (3)** is very strong because of its large gluing area and it is easy to make

The **Haunched Joint (4)** is easier to glue up and still provides lots of gluing area.

The **Mitered Haunched Joint (5)** is like the haunched joint but the tenon is not visible at all.

The **Four Shouldered Joint (6)** is not recommended.

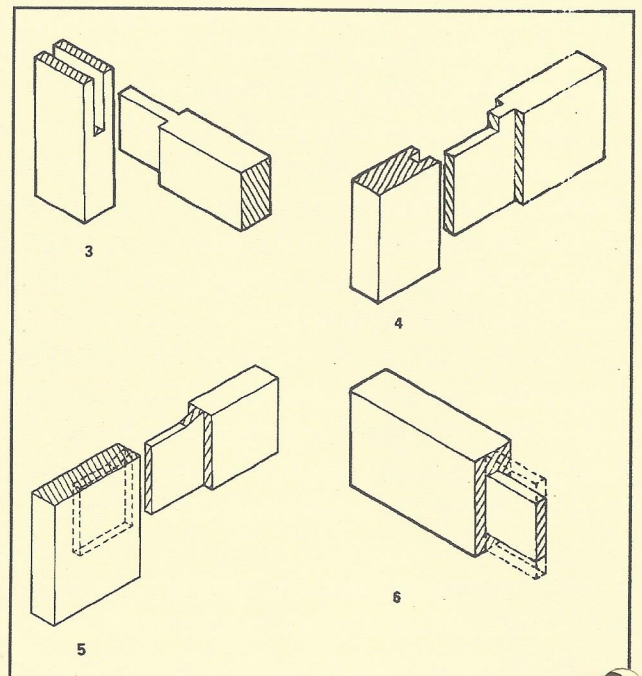

Tenons that meet in a corner must use the maximum possible gluing area to be strong.

**Mitered Tenons (Top right)** are mitered on the ends so they can share common space in the dual mortise.

**Stepped Tenons (Top right)** are stepped on the ends so that common space in the dual mortise is used by the top of one tenon and the bottom of the other.

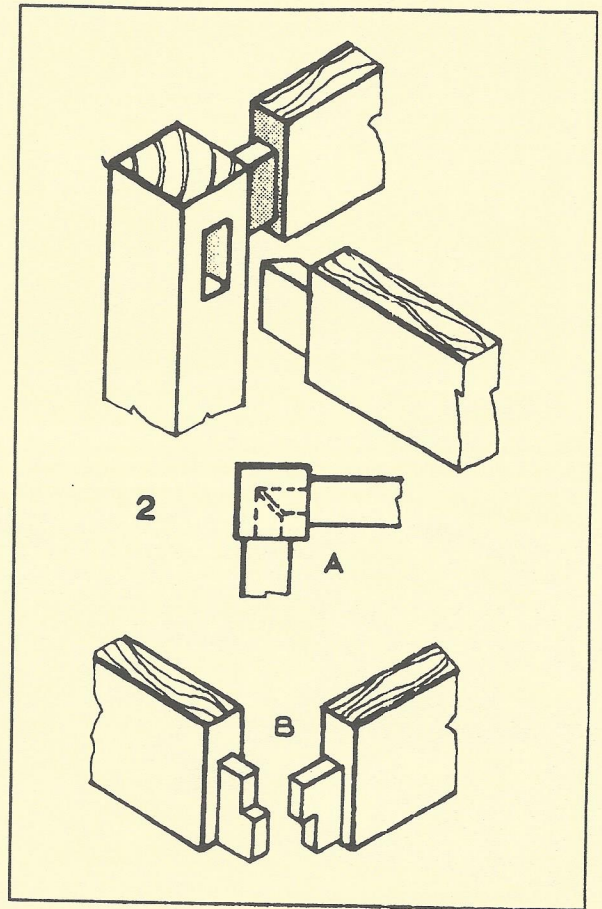

## Drawers

The **Tongue and Rabbet (12)** and the **Half Blind Tongue and Rabbet (13)** are not as strong as the dovetail joint but may be used with a light duty drawer front.

The **Through Dovetail (14)** and **Half Blind Dovetail (15)** are the strongest and best joints for attaching drawer fronts.

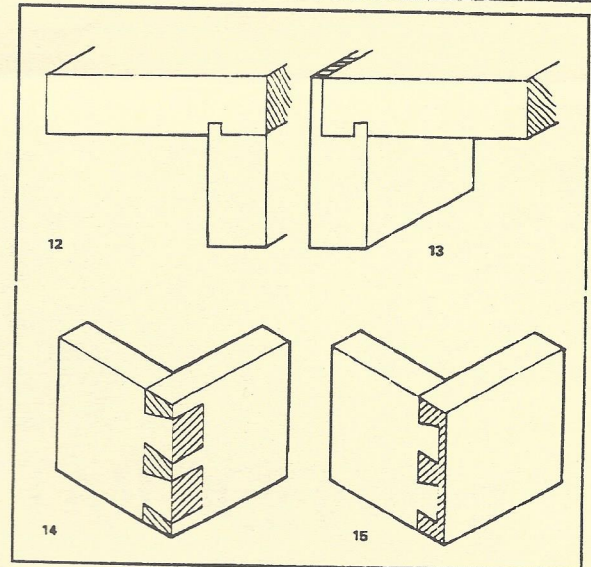

## References

Frid, Tage. Tage Frid Teaches Woodworking. "Book 1 - Joinery": Newtown, Ct: Taunton Press, 1993.

Note: "Book 1 - Joinery" and "Book 2 - Shaping, Veneering, Finishing" are included in a single bound volume.

Jones, Bernard E. The Complete Woodworker. Berkeley: Ten Speed Press, 1980.

Joyce, Ernest. Encyclopedia of Furniture Making. New York: Sterling Publishing Co. Inc. 1987.



**686-6176**

FAX: 686-3217

4910 West 34th St, Houston, Texas 77092  
Hours: M-F 7:30-5:00 SAT 8:30-12:30

**DOMESTIC & IMPORTED HARDWOODS**

Ash, Aspen, Basswood, Birch, Aromatic Cedar, Cherry, Cypress, Lacewood, Mahogany, Maple, Oak, Padouk, Pecan, Poplar, Purpleheart, Redwood, Sycamore, Teak, Walnut and more.

- \*Quality Domestic & Imported Plywood (Interior & Marine)
- \*Edgebanding & Veneer
- \*Butcher Block Tops
- \*MDF & Melamine
- \*Moulding
- \*PERSONAL SERVICE
- \*PROMPT DELIVERY
- \*ON-SITE CUSTOM MILLING

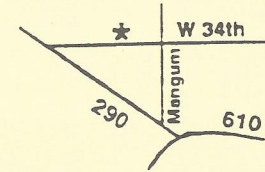

**Call 1-800-403-9736 Today!**

**FREE!  
CATALOG**

You'll find over 4,500  
woodworking products —  
including many exclusive  
and hard-to-find items!

Filled with hardware, wood,  
tools and know how from cover to cover.  
Call for your FREE catalog today!

Rockler Companies Inc.

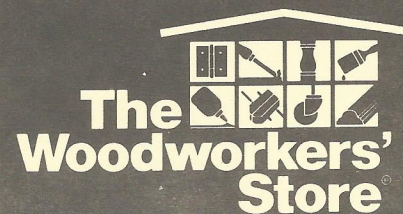

Hardware, Wood, Tools & Know How



**WOODCRAFT® Your Most Complete Woodworking Store!**

Hand & Power Tools  
Sanding & Scraping  
Planes  
Cabinet Making Supplies  
Vises & Clamps  
Saws

Carving Tools & Chisels  
Wood Boring Tools  
Woodburning  
Woodturning  
Project Kits & Supplies  
Shop Accessories  
Books & Videos

Hardware  
Finishing Supplies  
Safety Equipment  
Sharpening Supplies  
Workbenches  
Picture Framing Tools  
Classes

Routers & Accessories  
Hardwoods & Exotics  
Marking & Measuring  
Power Tool Accessories  
Files & Rasps  
Clock Supplies



**WOODCRAFT®**  
Woodworking Tools ■ Books ■ Supplies ■ Since 1928

Woodcraft ■ Northbrook Shopping Center ■ 5360 West 34th Street  
Houston, TX 77092 ■ Phone: 713-681-5200  
M-W & F: 9AM-7PM ■ TH: 9AM-9PM ■ Sat.: 9AM-6PM ■ Sun.: Noon-5PM

**Pasadena Industrial Supply**

**Porter Cable #9853S 12V Cordless Drill Kit**

- Adjustable clutch 10 to 230 in. lbs.
- Two speed ranges: 0-350 & 0-1,000 RPM
- Variable speed, reversing
- Extra battery
- Includes steel carrying case

**\$159**

List \$330

Must Show Ad  
Prices Good For Club  
Members Only



222 West Pasadena Freeway, Pasadena Texas 77506 472-5588

# HARDWOOD LUMBER CO.

700 E. 51/2 St. (In The Heights)  
 Houston, Texas 77007  
 (713) 862-6628  
 Hours: M-F 7:30-5:00, Sat. 8:30-1:30

We stock over 65 species of lumber including hard to find exotics!

**Also:** Plywood, Veneer, Moulding, Formica, Custom Milling, Woodworking Tools, Books, etc.

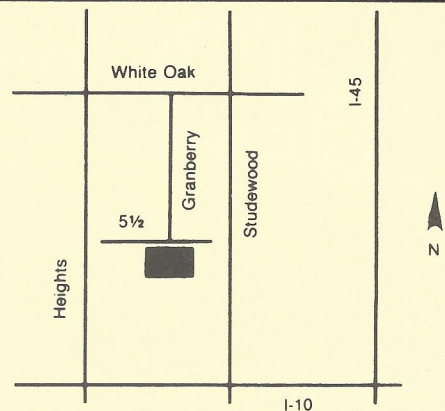

## Featuring the Finest Tools The World Has To Offer

English Hand Tools By Record, Stanley, Henry Taylor, & Robt. Sorby.  
 Japanese Saws, Chisels & Stones By Gyokucho, Matsumura, and King.  
 Biesemeyer, Makita, Bosch, Starrett, Irwin, Olson, Jorgensen,  
 Magna-Set, Freeborn, Lie-Nielsen, & Incra: All Made In The USA.  
 Canadian Chucks and Hand Tools By OneWay & Veritas.  
 European Tools by Freud, Tormek, Sjöberg, Stern, & Footprint.

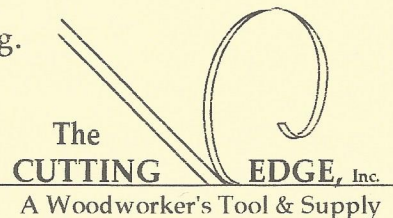

**PLUS: The Best Prices On JET Machinery Every Day!**

We are an Authorized JET Service Center.

7123 SouthWest Fwy, Just North of Bellaire Blvd. (713) 981-9228

Mon. - Fri. 9 am to 6 pm  
 Sat. 10 am to 5 pm  
 Sun. Noon to 4 pm

## WwCH Membership

To Join the Woodworkers Club of Houston for 1996, bring this form to a regular meeting or send your dues to:  
 WOODWORKERS CLUB OF HOUSTON, P.O. BOX 34481, HOUSTON, TEXAS 77234

Make checks payable to Woodworkers Club of Houston.

Renewal Membership \$24.00

New Membership is prorated if 1st year is less than 1 year.

## WwCH Membership Form

Last Name \_\_\_\_\_ First Name \_\_\_\_\_

Address \_\_\_\_\_ Spouse's Name \_\_\_\_\_

City \_\_\_\_\_ Home Telephone \_\_\_\_\_

State \_\_\_\_\_ Zip \_\_\_\_\_ Work Telephone \_\_\_\_\_

Renewal Membership \$ \_\_\_\_\_ New Membership \$ \_\_\_\_\_

Interests \_\_\_\_\_

# WOODWORKER'S CLUB OF HOUSTON

Post Office Box 815, Sugar Land, Texas 77487-0815

Saul Harris, President  
Charles Sylvester, Vice-President  
Clara Pitts, Secretary/Treasurer

## President's Message

by Saul Harris

**FRESH BLOOD.** These words should not conjure up thoughts of another O.J. Simpson joke or visions of me not using my handtools properly and safety. This is something that has been of concern to me for many months. It is the perpetuation of our craft; the continuation of what we love; the passing on of our knowledge and experiences. Every chance I get, I want my 7-year-old son, Daniel, to make sawdust with me. He really looks forward to wearing his safety glasses. Our busy schedules should not keep us from spreading the word about the Woodworker's Club of Houston.

When I go to Home Depot, I talk to the guys in the hardware and tool departments about the club. One of them works on Saturday but is interested in becoming a member for the newsletter and the information it holds. When one of our local supply companies gives my telephone number to someone and they call for information about the club, I actually *want* to talk to them. I eagerly return their call. I feel like this group is something worthwhile -- something worth selling.

If it were not, I would not be here. Like you, I have better things to do with my time than go to a worthless meeting and walk away with nothing. This group is nothing like that. Each and every month, the same 50 or so members come to the meetings. It's not because they want to see what I'm wearing that day, it's because they know they will walk away with something of value. They may come for the raffle. They may come for the show and tell discussions. They may come for the presentations. They may have a problem they need a solution to. They may come for the friendship and camaraderie of getting together with others of common interest. No matter what the reason, they keep coming back. Until his health kept him from coming, Ken Wallis used to drive 3 hours from Nacogdoches to attend the meeting -- and another 3 hours to get back home. There had to be *something* that kept him coming back time and time again for years.

What is it for you? If you think it is worthwhile being a member, don't you want to share that joy with another person interested in working wood? If we don't keep working to bring in new members, 10 or 20 years from now there may not be any of us left to come. I will have probably drilled a hole in my hand for the thousandth time. Chuck Maxwell may have run out of jig ideas. Brian Owens and a few others may be so far ahead of the rest of us that they don't need us any more. What then? Who are we going to teach and stimulate? Who are we going to pass our techniques onto if not our kids? If we love doing what we do so much, why not take each and every opportunity to bring someone else into the group and help them to make their woodworking experiences more enjoyable.

Until next month, may you cut straight.



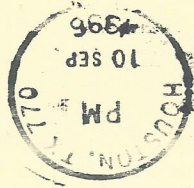

Woodworkers Club of Houston  
P.O. Box 34481  
Houston, Texas 77234

Printed By: *Speedy Printing Service of Texas*, 3433 West Alabama, Suite C, Houston, Texas, (713) 877-8466

# Calendar

(a calendar editor is still needed)

- September 14, 1996 Meeting at Bayland Community Center, 9:00 A.M.
- September 16, 1996 Northwest Splinter Group at Jimmie and Brian's Shop
- October 7, 1996 Northwest Splinter Group at Jimmie and Brian's Shop
- October 12, 1996 Meeting at Bayland Community Center, 9:00 A.M.
- October 21, 1996 Northwest Splinter Group at Jimmie and Brian's Shop
- October 26, 1996 WwCH Bar-b-Q at Jimmie and Brian's Shop
- November 4, 1996 Northwest Splinter Group at Jimmie and Brian's Shop
- November 9, 1996 Meeting at Bayland Community Center, 9:00 A.M.
- November 18, 1996 Northwest Splinter Group at Jimmie and Brian's Shop