

Woodworkers Club

OF HOUSTON

VOL. 7, NO. 10

OCTOBER, 1991

Officers

Zatis Murphy - President 469-3563
Denis Muras - Vice President 943-7745
Leo Orinderff - Sec./Treasurer 445-5460
Sharon Buckley - Newsletter Editor 944-6739

Board of Directors

Claude Emory - 861-3495
Ted King - 351-6808
Don Richardson - 661-1365
Lewis Vallette - 643-2014

SEPTEMBER MEETING

Well as it sometimes happens we had to rustle up a program at the last minute. We have such a wealth of talent among the club members that we just had to come up with an idea for a program. After polling a few of the members Don Sloan suggested that we have a program of Shop Tricks and Techniques. Don Sloan, Chuck Maxwell, Bill Hochmuth and Sharon Buckley shared with us some interesting ideas.

Chuck started off with a Dado jig that he had just made, which he calls his Silly Millimeter Dado Jig. If you have tried to make dados to fit some of the plywoods out there, you know that a 3/4" is not exactly a 3/4" thick piece of plywood. With Chucks' dado jig you can make a dado almost any width using a router and a straight cutting bit. He also had a sandpaper jig for sizing and cutting sandpaper. Chuck demonstrated how to fold a full sheet of sandpaper without cutting it but making it small enough to use comfortably. If you are not going to work in your shop for a while or going on a trip, Chuck suggests that you sprinkle Johnson's Baby powder of all table tops to keep them from rusting. The next time you need guides for a sliding jig use Poly-Vinyl Chloride plastic--this is an opaque white plastic, which never has to be oiled. You can purchase this item usually at plastic suppliers very cheaply from their drop off bins. Do you have buckets or containers with a variety of hardware and accessories--well Chuck suggests a cabinet with lots of drawers of various sizes, he built one from the plans in Woodsmith 25 Jan/Feb 83, he changed some of the drawers sizes to accommodate his needs. Bill Beggs built the same unit but added casters to make it portable.

Don Sloan was amazed at an article that he read in an woodworking magazine about how this woodworker could not glue up a 45 degree miter. He had to place a staple in each joint to hold it together. Don has a much easier way to

achieve perfect miters every time. First run all of the wood through a planer to make sure that it is all the same thickness. Always check your saw blade and your miter gauges with a right angle triangle--purchase a 45/90 degree plastic draftsman triangle for this purpose. When you check your saw blade make sure the triangle is against the face of the blade and not against a carbide tooth. After you have cut all your miters dry fit all of the pieces and check using your triangle against the inside corners for square. Apply glue to all of the pieces of wood, rub together and assemble using a band clamp--with each of the clamps the clamp manufacture supplies you with metal corners--Don says that these are no good and suggests that you do what he did. He brought from a scrap dealer some Aluminum angle with square inside corners. He places a piece of Aluminum angle at each corner wraps the band clamp around the frame and tightens. Before you tighten completely take a mallet and hit each joint to even the height and recheck the inside corners with the triangle. Have you tried to drill a hole for a hinge only to find out that you didn't center the hole exactly and the hinge moved when you tighten the screws? Vix Bits solve this problem--they are spring loaded drill bits that fit perfectly in the screw hole recess in a hinge, so that you can drill a perfectly centered hole. There are three sizes that cover a 5-6, 7-8, and 9-10 screw, the drill bit inside is replaceable and you can also set the depth of the screw hole. Have you ever had a drill bit wander as you start to drill a hole? Don suggests that you start the drill bit in reverse and then finish drilling in forward. When you sticker wood beware that you use the same type of wood to eliminate sticker stain. Don is a big believer that you must keep your saw blades clean as this can effect your final cut. He uses an old pizza pan and Formula 409. Don places the blade in the pan sprays with 409 uses an old tooth brush to remove the pitch and resin, washes the blade in plain

water and wipe dry. Don also uses Bartley's Gel Stain and Varnish--if you have not used this product it is pretty much idiot proof. It has a consistency of vaseline, very low in odor and dries very quickly. Bartleys is applied with a rag, paper towel or as Don uses a paper designed for applying finishes--available from Finishers Supply. You apply a coat and then gently buff it, it can be recoated in 4 hours. It was designed not to attract dust, the more coats you put on the better it gets.

Bill Hochmuth showed us his extra pair of "hands" that he uses for case work. A very simple piece of plywood with two 90 degree edges, besure to bevel the inside corner. These help to square up the case when assembling and clamping up. Bill also uses some simple jigs for repetitive spacing 3/4", 1" and 2", he use to make them up for a project and then throw them away--now ne marks what size they are and reuses them.

Sharon Buckley showed how she and Lewis Vallette made longer wood bars for the 4-way wood clamps that Shopsmith sells. The clamps come in 2 foot, 3 foot and 4 foot lengths. Sharon had only the 2 foot clamps but Lewis was giuling up a 3 foot wide table top. They used some bowling alley maple, machined the pieces to size, clamped the two pieces together and drilled a 1/2" hole using a Stanley Power bore bit directly in the middle of the two pieces --resulting in a exact half of a 1/2" hole in each edge. On the opposite side of the holes they layed out a crown to the pieces and sanded out the crown on a 6 x 48 sander. If you clamp up table tops or any edge to edge boards these clamps are great because they apply pressure to the edge of the boards and to the top of the boards.

We would like to Thank Don, Chuck, Bill and Sharon for coming to the rescue at the last minute this time and probably sometime in the future. From the attention of the members and comments it was enjoyed by all. And after the meeting we signed up 9 new members.

CHARITY SHOW AND SALE--ITS HEREEEE IIIIIII

We need all those wonderful projects now--so if you can not bring them on Friday to the show please bring them to the October meeting.

We also need some more members to man the booth, work on demonstration, set-up and take down. Please don't be shy, its really fun!!!!!!!

Bill Sallans will also have handouts at the meeting, so that you can give them to your friends and post them in your neighborhood.

OFFICERS FOR 1992

This is the month that we nominate officers for 1992--if you would like to participate or have any nominations now is the time to speak up. We vote on the new Officers in November.

SAFETY----MISSING GUARDS

By Murray Gordon

Murray's first question to the members was how many did not use the guards and splitters on their table saws. It was easier to count how many used their guards--from the show of hands Murray was the only one that used the guard. The first thing that Murray did with his saw was to replace the guard with a Delta Uniquard and splitter, which does not get in the way as most of the guards that are supplied with the saws do. Some of the members recommended the rollers that attach to the saws' fence as a good safety device and they can be used with the Dado blade.

PROBLEMS AND SOLUTIONS

Bill Beggs is having trouble with blade breakage on his scroll saw--mainly with #2 blades. It was recommended that he use only german blades available through Seyco Sales in Arlington or Circle saw in Houston.

Another member was having trouble with the tension spring in his old Cast Iron Atlas jig saw.

Robert Sandlin wanted to know the best way to fasten together a stack of wood to cut on his scroll saw. It was suggested that he nail them together in the areas to be discarded, use double stick tape or with a hot glue gun apply glue to the outside edges of the stack.

Many of the members were having trouble with the shelf life of 3M Scotchguard finish. It will solidify, cake up and turn yellow. The cause is the air left in the bottle--since the bottle is plastic, squeeze the bottle till the liquid come to the top and screw on the cap.

SHOW AND TELL

Jerry Wartko made a box from Oak flooring and a Purpleheart box with Maple and Ebony, after sanding the purpleheart turns brown, to restore the purple color place the piece out in the sun so that the oils will come out and return the purple color. Jerry also shared with us his new tool an Omnijig for making dovetail joints, he said that the video tape that comes with the jig was very useful and helped alot in the set up of the jig. He is very pleased with his results and ease of use and recommends the Omnijig to the members.

Bob Gallant showed us some baskets that he made and his wife painted for the charity show--he has pumpkins, snowmen and santas.

Ted Cooper had a big wheel tractor, crawfish necklace and earrings for the charity show.

One member had Nativity scene puzzles for the charity show finished in Tripps water based finishes.

Another member had bi-planes and a barnstormer made out of walnut, maple and paduke.

Denis Muras made 3-dimensional elephant puzzles for the charity show. He cut the pieces on a table saw and an Inca jig.

Bill Beggs made two lecturn stands for the charity show.

A MEMBERS PASSING

On September 24, 1991 we all lost a good friend and member, William R. "Doc" Forkner passed away. Doc was a very dear friend and promoter of the club. In the early years of the woodworkers club he allowed us to meet at the U of H Industrial Arts Woodworking Shop. Over the years he has shared with us his vast woodworking knowledge, presented many programs and shared with us his great sense of humor. We will all miss him greatly. Contributions may be made to Jonh Knox Presbyterian Church or to the William R. "Doc" Forkner Scholarship (c/o College of Technology, University of Houston, 4800 Calhoun, Houston, Texas 77204, Attn: Jeanie Ralston).

BUY AND SELL

4 Honduras Mahogany boards 15ft long approx. 20" to 25" wide, 5 quarter \$2.50 per brd. ft. Contact Lynn Dillard 771-4520.

AMT Jointer 4 1/2" wide extra set of blades Cost \$90.00 Your cost \$35.00 used less that 1/2 hour Contact Leonard Elkholtm 879-1616.

ANNUAL DINNER MEETING

REGISTRATION

WOODWORKERS CLUB OF HOUSTON

DECEMBER 13TH DINNER MEETING

RICE UNIVERSITY FACULTY CLUB

7:00 P.M.--FELLOWSHIP

8:00 P.M.--DINNER

COST: \$15.00 PER PERSON MEMBERS AND MEMBERS SPOUSE

COST: \$20.00 PER PERSON NON-MEMBERS

MEMBER NAME _____

SPOUSE NAME _____

NON-MEMBER GUEST _____

Please enclose a check with your reservations. Make check payable to WOODWORKERS CLUB OF HOUSTON. Send check to Leo Oringderff 4114 Cherry Oak Circle Houston, Texas 77088 445-5460.

DEADLINE--DEADLINE--DEADLINE--DEADLINE--DEADLINE--DEADLINE

November 18, 1991-----November 18, 1991

ANNUAL DINNER MEETING

Enclosed in this issue is a registration for the Annual Dinner meeting on Friday December 13, 1991. The Regular December meeting will be on the following Saturday December 14th, 1991. For the new members we have one dinner meeting a year, held at the Rice University Faculty Club. This is a chance for the members and there spouses or friends to get together for fellowship and fun.

We start at 7:00 PM with a Fellowship and a pay Bar for anyone wishing to Indulge. At 8:00PM we have a sit down dinner--next month we will publish the menu. We also have a big Show and Tell which will be loosely judged with very nice ribbons presented. This year we have the ribbons so you will be able to take them home with you and not have to wait a couple of months. Refer to the registration for cost and deadline. Please include your spouses or guest's name so we can make up name tags ahead.

OCTOBER MEETING

WHEN: OCTOBER 12, 1991 9:00 A.M.

**WHERE: BAYLAND COMMUNITY CENTER
 ON BISSONNET AT HILLCROFT**

**DON'T FORGET TO BRING YOUR CHARITY
SHOW PROJECTS TO THE MEETING OR TO THE
GREENSPPOINT MALL.**

Pasadena Industrial Presents *Our Fall 91'*

Power & Hand Tool Show

Free Hot Dogs
Drinks

Nov. 22, 23 & 24

Special pricing in
effect for the show
only!

Lots of Door Prizes!

Fri 12 - 5:30 Sat 8 - 5:30 Sun 12 - 5:30

Just Tell em "*Johnny Sent Me!*"

222 West Pasadena Freeway, Pasadena Texas 77536 472-5588

Hardwood Lumber Co. Lawndale Division Imported and Domestic

Marine Plywood
Parana Pine
Teak

Honduran Mahogany
Exotic Hardwoods
Domestic Hardwoods
WALNUT - BIRCH - ASH - CHERRY
CYPRESS - RED AND WHITE OAK
AND OTHERS

Quality
Hardwoods - Softwoods - Plywoods
Mouldings & Squares

A COMPLETE SELECTION OF FINISHING SUPPLIES.

12/91

MON. - FRI. 7:30 TO 4:30
SAT. 8:00 TO 1:00

5401 Lawndale
(713) 921-6131

Your Complete Woodworking Center Check Out Our Hardwoods, Our Prices Are Low

Hours:
Monday to Friday:
10:00 a.m. to 8:00 p.m.
Saturday
9:00 a.m. to 5:00 p.m.

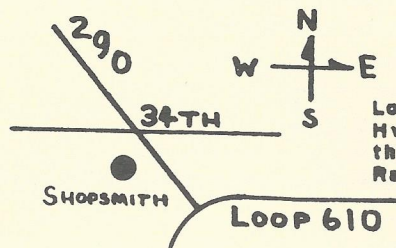

Located at 34th St. &
Hwy. 290 to Austin on
the West side in the
Randalls Strip Center.

Shopsmith Inc.

Northway Shopping Center
10965A Northwest Frwy.
Houston, TX 77092
Phone: (713) 681-5200

1/92

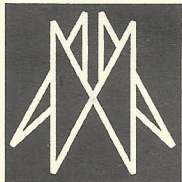

AUSTIN HARDWOODS

13001 VETERANS MEMORIAL DR.
HOUSTON, TEXAS 77014

440-0764

We stock over 80 species of lumber including rare exotics and turning stock. Plywood, Veneer, Moulding, Flooring, Tools, Millwork, Paneling Etc. also available

Exp. 8/89

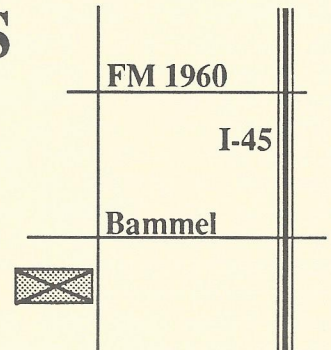

HARDWOOD LUMBER CO.

700 E. 51/2 St. (In The Heights)
Houston, Texas 77007
(713) 862-6628
Hours: M-F 7:30-5:00, Sat. 8:30-1:30

We stock over 65 species of lumber including hard to find exotics!

Also: Plywood, Veneer, Moulding, Formica, Custom Milling, Woodworking Tools, Books, etc.

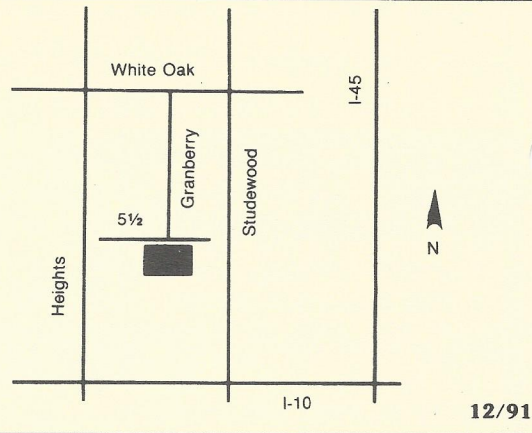

Send Today for the Most Complete Catalog Selection of Woodworking Supplies

Please Enclose \$1.00 (3rd class) or \$2.00 (1st class)

Name _____
Address _____
City _____ State _____ Zip _____

Orders Shipped Within 48 Hours

1/92

21801 Industrial Blvd., Rogers, MN 55374

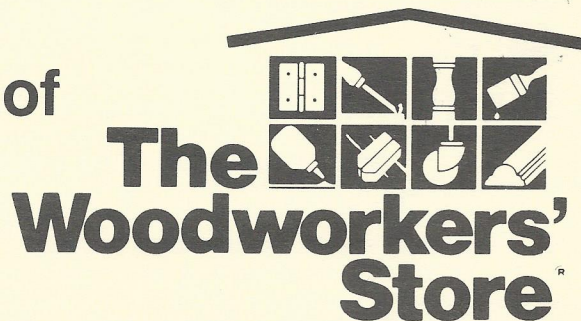

PRINTED BY SPEEDY PRINTING SERVICE OF TEXAS 3727 W. ALABAMA, HOUSTON, TX. 77027 (713) 877-8466



5117 April Lane, Houston, Texas 77092
Hours: M-F 7:30-5:00 SAT 8:30-12:30
(713) 686-6176 Phone
(713) 686-3217 Fax

DOMESTIC & IMPORTED HARDWOODS

Ash, Basswood, Birch, Cedar, Cherry, Cypress, Mahogany, Maple, Red Oak, White Oak, Padouk, Poplar, Purpleheart, Redwood, Sycamore, Teak, Virola, White Pine, Walnut, and More.

High Quality Domestic & Imported
Plywoods, Softwoods, Hardwood Veneer
Edgebanding & Hardwood Veneers
Excellent Service & Competitive Prices!

ON SITE CUSTOM MILLING
TO YOUR SPECIFICATIONS,
S2S, S2S1E, S4S
(No order too large or too small) 10/92

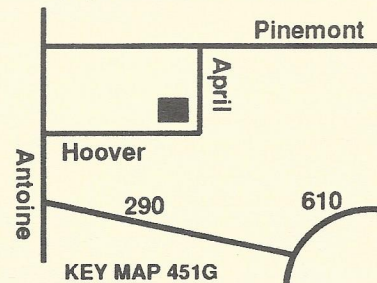

Woodworkers Club of Houston
P.O. Box 34481
Houston, Tx 77234

