

Woodworkers Club

OF HOUSTON

VOL. 5, NO. 11

NOVEMBER, 1989

Officers

Bill Hochmuth - President 774-1733
Bill Sallans - Vice President 465-0291
Bill Baker - Sec./Treasurer 667-8381
Steve Procter - Newsletter Editor 728-1459

Board of Directors

Sharon Buckley - 944-6739
Zatis Murphy - 469-3563
Don Richardson - 661-1365
Gary Wallace - 855-3408

CHARITY SHOW

WOW--- What a Great Show and Sale ! We were all worried when the Mall moved us from the North Court in front of Foley's to the South Court corridor in front of Palais Royal. But we were worried about nothing, as everyone going to the food court had to pass by our sale area.

There still tallying up all the proceeds but we sold over \$4600.00---can you believe?

We thank everyone who donated merchandise, their time, hard work and salesmanship for making this years show such a BIG Success.

Some of the members also donated items of theirs that did not sell to a charitable group which was having their own sale.

OCTOBER MEETING

The October meeting was held at Hardwood Lumber Co.. We would like to thank them for the use of their facility, it really comes in handy--as its very hard to find a large enough building to hold all of the members that attend. If all our members showed up at once we'd be in big trouble.

At the ninth hour the person who was to present a program on commercial woodturning backed out.

Bill Sallans had to scramble to find a program. Luckily we have such vast knowledge among our membership that he was able to find a program from our membership.

Don Richardson's program was on "How to use a Computer to Design a Project--Planning a Project with a computer or just Planning a Project in general.

Don had a nice handout for us to follow.

If you use a computer and CAD package(computer aided design) it simplifies the pen and drawing paper portion of design. But you still have to do the planning stages first:

- 1.) What do you want your project to hold or what is its main function?
- 2.) Will you need electrical boxes or lights?

3.) Should it be movable(one piece or will it need casters) ?

4.) What type of material should it be made out of ?

5.) How much will it cost or How much do I want to spend?

These are just a few questions you must ask yourself before you ever start.

Before you run to the shop and start cutting--You should figure out what type of joints that will affect the different lengths.

Remember its better to measure twice and cut once---or you might be making a lot of trips to the lumber yard.

Whether you use a computer or pencil and paper--Planning is one of the most important aspects of Woodworking.

Thanks Don--for a very interesting program.

NOMINATION OF OFFICERS

The nominating committee presented a slate of officers for 1990. The Railroad got going so fast that we by passed our constitution and By Laws and proceeded to vote.

To make everthing constitutional as we always go by the rules (HA ! HA !) We will officially vote at the November Meeting for the following officers for 1990:

Don Richardson-----President
Ted King-----Vice-President
Claude Emory-----Sec./Treas.
Bob Gallant-----Director at Large
Bill Hochmuth-----Board of Director
Bill Sallans-----Board of Director
Bill Baker-----Board of Director
Sharon Buckley-----Newsletter Editor

BUY AND SALE

Mill-Route For Sale---Chuck Maxwell
Ring Master For Sale--Ronnie Derks
Shopsmith with Accessories for \$800.00
Tracy White 789-8537 M-Th after 5:00.

BUY AND SELL (CON'T)

Set of Lathe Tools For Sale \$10.00 and wood Turning Mahogany over 4" Dia. x 6 feet \$20.00.----Arthur Chester 376-2627.

For Sale 9" Table Saw complete with several Blades, Stand and several jigs, all in good condition. \$100.00 Harry Jacobsen 465-4153.

RBI 20" Scroll saw with many accessories--Sharon Buckley 944-6739.

SHOW AND TELL

Steve Procter had photos of cabinets he's making for a customer in the traditional style. Steve also had some blocks, the old fashion style childrens blocks that he made of drop offs from his mahogany rocking horses.

He had a large box full and asked if any members would like to sand and finish some, as he had many more---Bill Hochmuth and Bill Sallans both finished a box full and every one of these blocks sold at the charity show(like Hot cakes).

So save your drops and you might have a project for next year.

Wayne Kennedy showed some Gum Ball machines made on a router with mason jars to hold the gum balls.

Chuck Maxwell had a spaghetti measure made of oak. He made some xmas candle holders (tree with candle) He made the brass candle inserts from rigid copper tubing, flared on a plumbers flaring tool. The plans are in Wood's Weekend Working Projects.

PYRAMID HOUSE

Leo Oringderff needs volunteers to help teach a very basic woodworking class at the MHMR.

Ed Caesar is helping Leo but they could use a couplr more volunteers to work Tuesday or Thursday.

They work on very simple projects on the scroll saw or bandsaw.

They meet at the MHMR building which is located one block behind the old San Jacinto High School,

Call Leo if you can help !

TOOL SHOW

Pasadena Industrial Supply is having their big Fall Tent Sale. Friday November 10 thru Sunday November 12. The show starts Friday at 12:00 noon--Just tell them Johnny sent you and you get in Free.

Johnny always has some great specials during the show, So don't miss it or you'll miss some good deals, free hot dogs and beverages.

See you there!!!

DUES FOR 1990

Enclosed is an application for paying your 1990 dues. Dues are due January 1st, 1990. Remember the sooner every one pays his or her dues the sooner we can get a new roster and name badges printed.

The dues for 1990 will be \$18.00 for the year.

ANNUAL DINNER

Remember the dinner meeting is Tuesday November 28th starting at 7:00 P.M. at the Rice Faculty Club.

There will be a pay bar during the Fellowship before the Dinner.

We will have a leisurely sit down dinner, followed by a very short business meeting.

We will introduce our new officers.

The Super '89 Show-N-Tell and Presentation of awards which will be judged for several winners in different catagories. Last years items not permitted in this year's contest.

SEE INSERT PAGE FOR MAP TO THE RICE FACULTY CLUB.

NOVEMBER MEETING

WHEN: NOVEMBER 11, 1989 9:00 A.M.

WHERE: ELKS LODGE #151
5230 SOUTH WILLOW DR.
HOUSTON, TEXAS

DIRECTIONS: Take South Loop 610 and exit on South Post Oak. Go past Willowbend to the next intersection with a traffic light. This is South Willow Dr.---turn right approximately 6 blocks and your there!

PROGRAM: Rodney Hill from College Station will tell about Architectural carvings he produces.

FUTURE PROGRAMS

December--yes this december we will have a meeting. The program will be on everything you ever wanted to know about wood, its chemical and physical properties. Interesting session put on by the Texas Forest Service.

NEW ITEM

Just saw a new product advertised in one of the woodworking magazines. Its an attachment that fits most routers and converts it into a biscuit machine. The item is sold by Sears--the ad didn't say how much, but its bound to be less expensive than a single purpose biscuit machine.

ANNUAL DUES

DEADLINE JANUARY 31, 1990

TO JOIN W.W.C. OF HOUSTON FOR 1990, BRING TO THE REGULAR MEETINGS OR SEND YOUR \$18.00 ANNUAL DUES TO WOODWORKERS CLUB OF HOUSTON P.O. BOX 34481, HOUSTON, TEXAS 77234. MAKE CHECKS PAYABLE TO WOODWORKERS CLUB OF HOUSTON.

Cut off and complete

LAST NAME _____ FIRST NAME _____
HOME PHONE _____ WORK PHONE _____
ADDRESS _____ CITY _____
STATE _____ ZIP _____ SPOUSE'S NAME _____
OCCUPATION/CRAFT:** _____

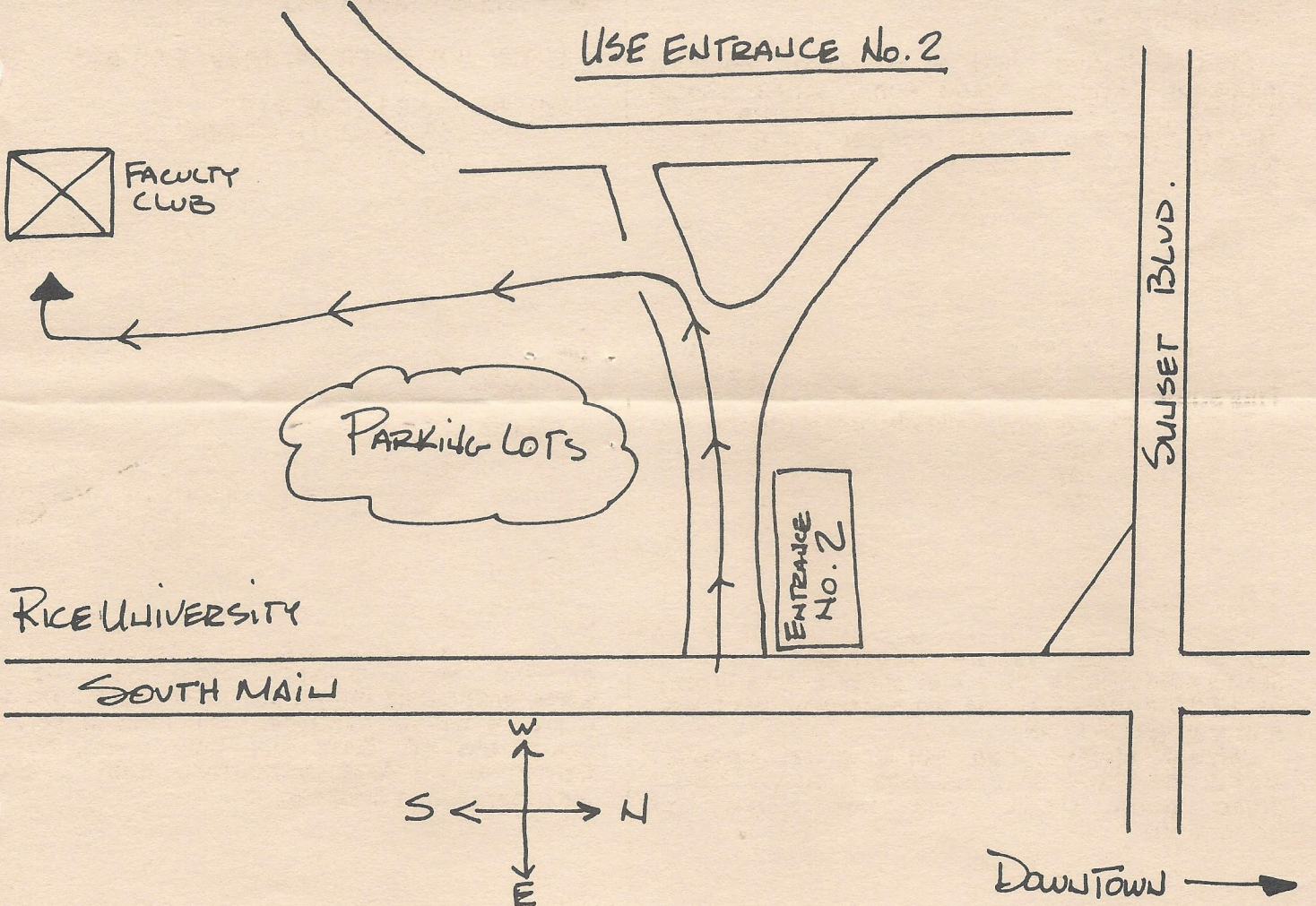

Pasadena Industrial Supply Power & Hand Tool Show

Nov 10, 11, & 12

Live Demos by factory reps. Door Prizes, Free Hot Dogs & Drinks,
Special Pricing for 3 days only!

222 West Pasadena Freeway, Pasadena Texas 77536 472-5588

Come in and checkout our over arm router system.

Check out our hard woods - Bowl and spindle stock - Exotic
hardwoods - Best prices intown.

Hours:

Mon, Tues, Wed, & Fri

9:00a.m. to 6:00p.m.

Thurs: 9:00a.m. to 9:00p.m.

Sat: 9:00a.m. to 5:00p.m.

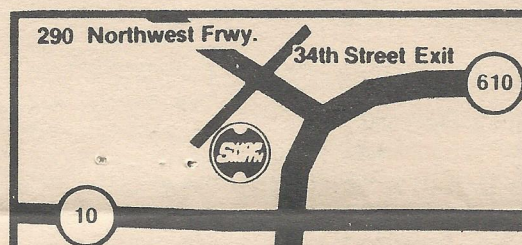

Shopsmith Inc.

Northway Shopping Center
10965A Northwest Frwy.
Houston, TX 77092
Phone: (713) 681-5200

Exp. 1-90



AUSTIN HARDWOODS

13001 VETERANS MEMORIAL DR.

HOUSTON, TEXAS 77014

440-0764

We stock over 80 species of lumber including rare exotics and
turning stock. Plywood, Veneer, Moulding, Flooring, Tools,
Millwork, Paneling Etc. also available

Exp. 8/89

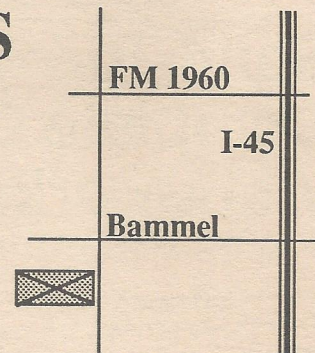



Woodworkers Club of Houston
P.O. Box 34481
Houston, TX 77234

Houston Wood and Tool, Inc.



DAP Weldwood®
Hobby & Craft Glue



DAP Weldwood®
Plastic Resin Glue

- **Classes**
- **Fine Hand Tools**
- **Power Tools**
- **Portable Electric Tools**

Visit our showroom. Open Monday to Saturday
Mon, Tues, Wed & Fri 8 to 5, Thurs 8 to 8, Sat 9 to 4.
Come by or call 680-1744 - City Sales.

Located two blocks west of Highway 290 on 34th Street.
5857 W. 34th Street - Houston, Texas 77092

Exp. 4/90

HARDWOOD LUMBER CO.

700 E. 51/2 St. (In The Heights)
Houston, Texas 77007
(713) 862-6628
Hours: M-F 7:30-5:00, Sat. 8:30-1:30

We stock over 65 species of lumber including
hard to find exotics!

Also: Plywood, Veneer, Moulding, Formica,
Custom Milling, Woodworking Tools, Books, etc.

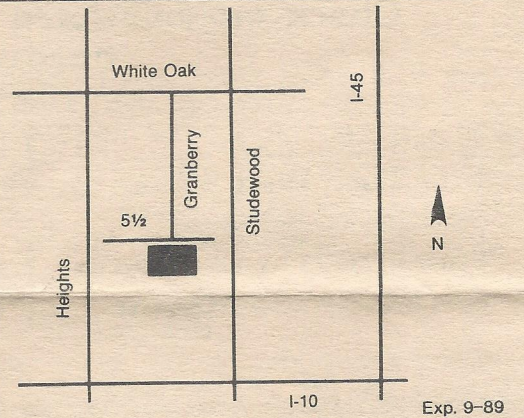

Exp. 9-89

Send Today for the Most Complete Catalog Selection of Woodworking Supplies

Please Enclose \$1.00 (3rd class) or \$2.00 (1st class)

Name _____
 Address _____
 City _____ State _____ Zip _____

Orders Shipped Within 48 Hours

Exp. 5/89

21801 Industrial Blvd., Rogers, MN 55374

