

Woodworkers Club of Houston

Volume 13, Number 3 March, 1997

February Meeting

Dedicated to Ed Burger

The meeting was called to order by Saul Harris. He dedicated the meeting to the memory of Ed Burger.

Don Richardson was sworn in as the new president.

Visitors and new members were recognized and welcomed to the club.

Libraries:

Denis Muras reported on new tapes

Don announced that we needed a new book librarian. Alan Bachrach volunteered and is the new librarian.

Announcements:

Robert Sandlin has a source for 800 directories. If you are interested, call Robert.

Mike Reddrick asked for names of people willing to do projects for pay.

Jimmie Harp said that the charity project would be delivered today.

Tom Talasek announced that is going to Arkansas to get wood. He asked if anyone was interested in going with him, and said you can make some very good buys.

David Stephen Procter was born on February 1, 1997 to Steve and Vicki Procter. Amanda now has competition.

Treasurer's Note:

There is \$6498.10 in the treasury.

Show & Tell:

There was no show and tell at this meeting.

Board Meeting:

A board meeting was held after the regular meeting.

They are looking for a field trip coordinator, and suggestions for field trips.

The Bar-B-Que will be October 18, 1997 at Jimmie and Brian's shop.

Don Richardson will make new name tags.

The names of new members will be put in the newsletter so that you can add them to your new directories.

Problems and Solutions:

A source is needed for a 2" dowel rod 10' long.

It was suggested to try Detering Lumber or make it with a router.

A source was needed for Mesquite and Spaulted Pecan.

For mesquite, call South Texas Hardwoods
Route 1, Box 105
Cost, Texas 78614
(210) 437-2275

For spaulted pecan, call Freeman Anderson at (713) 487-9394.

How to make your band saw blades cut better?

Lubricate them with beeswax. Wax your saw table and other machine tables to make them slide smoothly.

It is recommended that you ground your dust collector with a bare copper wire wrapped around the outside of the pipe.

How do you glue wood to glass?

Try Gorilla glue. Use Insta-Glue made for wood to glass. Use epoxy glues made for this purpose.

February Program:

Greg Long started the program by giving a brief history of Windsor Chairs. They originated from the town of Windsor, England. In the late 1600's and early 1700's, American craftsman in Philadelphia improved the design. They replaced the back splat with spindles and splayed the legs.

The spindles are made from green, riven red oak. He uses a froe to split the wood from a green log and shapes and finishes them with a spokeshave.

The backs are steam bent around a form and are also made of riven wood. Riven wood has great strength because it is split along the grain.

The seats are made of basswood or white pine, and the legs are made from maple or birch.

The joints are made to shrink tight and are glued. The legs go through the seat and are wedged for a tight fit.

The tools used in Windsor chair making are: draw knife, inshave, travisher, tapered reamer, spoon bits, spokeshaves, and chisels.

Greg turns the legs and stretchers on a wood lathe. The rest of the parts are completely formed by hand.

Windsor chairs are traditionally painted because of the different kinds of woods and it brings together the beauty of the lines and design.

Milk paint is available from:

The Old Fashioned Milk Painter
436 Main Street
Groton, MA. 01450-0222
(508) 448-6336
Fax (508) 448-2754

Greg Long gives a good program and we are fortunate that he makes himself available to the club.

Want ads:

David Yiengst has a 10" saw blade and 4 sheets of 4' x 10' x 1" thick exterior fir plywood for sale.

Murray Gordon has a Unisaw guard for sale.

John Barr has a Delta Electronic 18" scroll saw with lamp for sale for \$400.00 (713) 462-0740.

Field Trips

Bill Rhea has the following suggestions for field trips.

Jet Showroom
Houston, TX.

Demonstration of turn
woodworking tools

Southwest Panel
Products
Katy, TX.

Manufacture of custom
plywood with MDF core

???
Nacogdoches, TX.

Milling of bowling alley
lumber

Temple Inland in Diboll, TX.

If you are interested in any of these trips, or if you have some other place you want to see, fill out the form and give it to Bill at the meeting.

Name: _____		
Telephone Number: _____		
Field Trip	Definitely will go	Probably will go
Jet Showroom		
SW Panel Products		
Nacogdoches		
Temple Inland		
Your Suggestion		

PERMISSION SLIP

I, _____, GIVE MY
HUSBAND, _____,
PERMISSION TO GO ON THE FOLLOWING
FIELD TRIP OR TRIPS: _____

March Meeting

When: March 8, 1997 9:00 AM

Where: Bayland Community Center
on Bissonnet at Hillcroft

Program: Steve LeGrue
"Inkra Jig Basics"

Raffle: Items to be announced

Items Of Interest:

The Cutting Edge has "Free Saturday Tool and Technique Basics Seminars" - 11:00 am to Noon.

Unlimited attendance, Free to the public.

March 15, 1997 Pen Turning Basics

March 22, 1997 Router Basics

March 29, 1997 Dovetail Basics

April 5, 1997 Joinery Basics

Woodcraft has "Sawdust Sessions" on Thursday nights from 7:00 - 8:00 PM. Free to the public.

March 20-23 Greg long will have a Windsor Chair Making Workshop. The tuition is \$500.00 and includes all materials. If you are interested, call Woodcraft Supply at (713) 681-5200.

The following is a thank you note from the family of Zatis Murphy.

*The family of
Zatis L Murphy
acknowledges with grateful
appreciation the kind expression
of your sympathy*

The Northside Splinter Group meets on the first and third Monday of each month from 7:00 - 9:00 P.M. at Jimmie Harp's shop, at 848 1/2 west 24th street. 862-7222.

We are currently working on two covered swings for the charity project. The first swing is almost completed. If you would like to help, come on by. You can help with the swings or bring your own project.

The club is making a list of members willing to do woodworking for pay. If you want to be on this list, call Mike Reddrick at 493-6586.

Official WwCH Knit Shirts can now be ordered in small quantities.

Prices are:

Small, Med., Lg., XLg. _____ \$24.36

XXLg. _____ \$25.38

XXXLg. _____ \$25.98

XXXXLg. _____ \$27.06

These shirts are embroidered, not printed.

Officers

President	Don Richardson	661-1365
Vice President	Bill Rhea	266-9412
Sec'y/Treas.	Guy Meaders	771-4875

Services

Book Library	Alan Bachrach	729-7534
Video Library	Dennis Muras	943-7745
Literature Search	Don Richardson	661-1365
Name Tags	Andy Anderson	723-1030
Coffee	Loretta Buckley	944-6739
	Bill Hochmuth	774-1733

Directors

Saul Harris	341-5373
Charles Sylvester	774-6551
Mike Turner	988-1485
Lewis Vallette	643-2014

Newsletter Editor

Bob Gilbertson	869-7081
----------------	----------

Newsletter Distribution

Thad Brown	522-8364
------------	----------

HARDWOOD LUMBER CO.

700 E. 51/2 St. (In The Heights)
 Houston, Texas 77007
 (713) 862-6628
 Hours: M-F 7:30-5:00, Sat. 8:30-1:30

We stock over 65 species of lumber including
 hard to find exotics!

Also: Plywood, Veneer, Moulding, Formica,
 Custom Milling, Woodworking Tools, Books, etc.

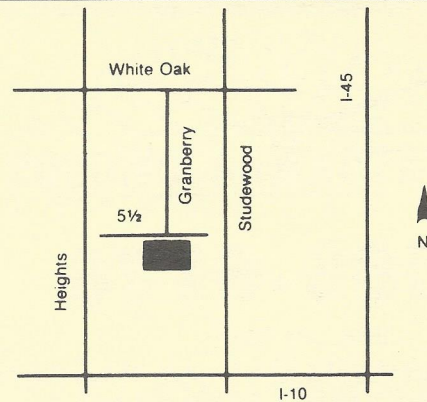

Featuring the Finest Tools The World Has To Offer

English Hand Tools By Record, Stanley, Henry Taylor, & Robt. Sorby.
 Japanese Saws, Chisels & Stones By Gyokucho, Matsumura, and King.
 Biesemeyer, Makita, Bosch, Starrett, Irwin, Olson, Jorgensen,
 Magna-Set, Freeborn, Lie-Nielsen, & Inera: All Made In The USA.
 Canadian Chucks and Hand Tools By OneWay & Veritas.
 European Tools by Freud, Tormek, Sjöberg, Stern, & Footprint.

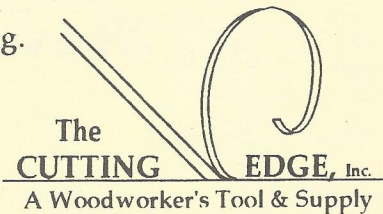

PLUS: The Best Prices On JET Machinery Every Day!

We are an Authorized JET Service Center.
 7123 SouthWest Fwy, Just North of Bellaire Blvd. (713) 981-9228

Mon. - Fri. 9 am to 6 pm
 Sat. 10 am to 5 pm
 Sun. Noon to 4 pm



Greg Long, Windsor Chairmaker
 713-668-1655

Windsor Chair Supplies & Classes

*Complete maple turning sets and blanks, riven wood and steam bendings,
 private and group instruction. Chair restoration and repair.
 Visit my retail website @ frontera.com.*

WwCH Membership

To join the Woodworkers Club of Houston for 1997, bring this form to a regular meeting or send your dues to:
 WOODWORKERS CLUB OF HOUSTON, P.O. BOX 34481, HOUSTON, TEXAS 77234
 Make checks payable to Woodworkers Club of Houston.
 Renewal Membership \$24.00 New Membership is prorated if 1st year is less than 1 year.

WwCH Membership Form

Last Name _____ First Name _____
 Address _____ Spouse's Name _____
 City _____ Home Telephone _____
 State _____ Zip _____ Work Telephone _____
 Renewal Membership \$ _____ New Membership \$ _____
 Interests _____



686-6176

FAX: 686-3217

4910 West 34th St, Houston, Texas 77092
Hours: M-F 7:30-5:00 SAT 8:30-12:30

DOMESTIC & IMPORTED HARDWOODS

Ash, Aspen, Basswood, Birch, Aromatic Cedar, Cherry, Cypress, Lacewood, Mahogany, Maple, Oak, Padouk, Pecan, Poplar, Purpleheart, Redwood, Sycamore, Teak, Walnut and more.

- *Quality Domestic & Imported Plywood (Interior & Marine)
- *Edgebanding & Veneer
- *Butcher Block Tops
- *MDF & Melamine
- *Moulding
- *PERSONAL SERVICE
- *PROMPT DELIVERY
- *ON-SITE CUSTOM MILLING

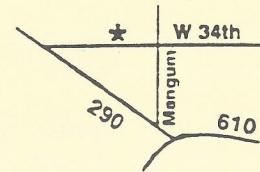

"The Woodworkers' Store is proud to sponsor the Woodworkers club of Houston."

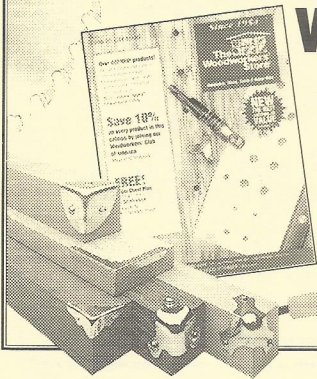

- Thin & Exotic Lumber
- Hand Tools
- Computer Hardware
- Clock Parts
- Box Hardware
- Veneer
- Speciality Hinges
- Accuride Slides
- Router Bits
- Jig & Accessories
- Aniline Dyes
- Shelf Hardware
- Furniture Trim
- Screws
- Drawer Essentials

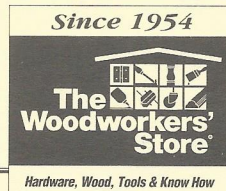

Department 63470

4365 Willow Drive, Medina, MN 55340



WOODCRAFT® Your Most Complete Woodworking Store!

Hand & Power Tools
Sanding & Scraping
Planes
Cabinet Making Supplies
Vises & Clamps
Saws

Carving Tools & Chisels
Wood Boring Tools
Woodburning
Woodturning
Project Kits & Supplies
Shop Accessories
Books & Videos

Hardware
Finishing Supplies
Safety Equipment
Sharpening Supplies
Workbenches
Picture Framing Tools
Classes

Routers & Accessories
Hardwoods & Exotics
Marking & Measuring
Power Tool Accessories
Files & Rasps
Clock Supplies



WOODCRAFT®

Woodworking Tools ■ Books ■ Supplies ■ Since 1928

Woodcraft ■ Northbrook Shopping Center ■ 5360 West 34th Street
Houston, TX 77092 ■ Phone: 713-681-5200

M-W & F: 9AM-7PM ■ TH: 9AM-9PM ■ Sat.: 9AM-6PM ■ Sun.: Noon-5PM

**Looking for great quality Power & Hand Tools?
Pasadena Industrial Supply**

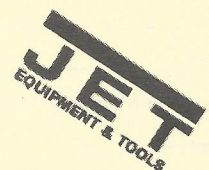

222 West Pasadena Freeway, Pasadena Texas 77506 472-5588



4866
Woodworkers Club of Houston
P.O. Box 34481
Houston, Texas 77234

Printed By: *Speedy Printing Service of Texas*, 3433 West Alabama, Suite C, Houston, Texas, (713) 877-8466

Calendar

(a calendar editor is still needed)

- | | |
|-------------------------|---|
| March 3, 1997 | Northwest Splinter Group at Jimmie and Brian's Shop, 7:00 P.M. |
| March 8, 1997 | Meeting at Bayland Community Center, 9:00 A.M. |
| March 17, 1997 | Northwest Splinter Group at Jimmie and Brian's Shop, 7:00 P.M. |
| April 7, 1997 | Northwest Splinter Group at Jimmie and Brian's Shop, 7:00 P.M. |
| April 12, 1997 | Meeting at Bayland Community Center, 9:00 A.M. |
| April 21, 1997 | Northwest Splinter Group at Jimmie and Brian's Shop, 7:00 P.M. |
| October 18, 1997 | Bar-B-Que at Jimmie and Brian's Shop |