

Woodworkers Club

OF HOUSTON

VOL. 9, NO. 3

MARCH, 1993

Officers

Bud Froelich - President 859-6620
Ted Kurland - Vice President 729-4693
Joe Wainright - Sec./Treasurer 666-8475

Board of Directors

Art Chester - 469-1990
Jack Conry - 463-7352
Denis Muras - 943-7745
Bill Smith - 356-6509

Sharon Buckley - Newsletter Editor 944-6739

FEBRUARY MEETING

Chuck Maxwell presented a program on raised panel doors. To begin with you must purchase lumber as knot free as possible. Run all of the lumber through a planer because it must all be the same thickness, you cannot expect that 3/4 inch thick lumber is all 3/4 inch thick.

You can purchase a single reversible rail and stile router cutter or one router cutter to cut the rails and another cutter to cut the stiles.

Rails and stiles can also be cut on a shaper but alot of us do not own shapers but almost all of us own routers.

Raised panels can be cut on a table saw using a molding head cutter with a cove cutter installed. It will take you about 4 to 5 passes on the table saw to get the desired shape. Always cut the cross grain first then make your cut with the grain, this will help to eliminate tear out.

Chuck started making panels using the table saw method then he purchased one of those large very large raised panel router bits. They are so large that you have to have at least a 3 horsepower router. And because of the speed that the router bit travels at you should only use one of these bits with a variable speed router or wear a bullet proof suit.

Chuck has just purchased a vertical panel router bit, this bit was designed for safety and because the bit is so much smaller you can use a router with only 1 1/2 horsepower. This bit was designed by the owner of Woodhaven, Co. which also sells these through their mail order catalogue. Chuck uses an adjustable fence using three pieces of removable masonite to make the passes across the router bit.

Once you get the setup you want, make yourself a sample of the rails, stiles and raised panel and save to use for your next setup and you can save alot of time and frustration.

When sizing your panels for the doors make them 1/4 of an inch shorter in the width to allow for expansion and contraction.

Glue only the rail and stile joints to allow for expansion--do not glue the panel.

Stain the panels before assembly which will eliminate any gaps do to expansion, etc.

Chuck had an array of jigs and panels to demonstrate how and how not to make panels.

Thanks Chuck for an interesting program and sharing your successes and some of your failures.

WOODWORKING WORLD TOOL SHOW

The show will be in Houston on the same weekend as our regular meeting. That's Friday March 12th from 5:00 P. M. to 9:00 P. M. and Saturday March 13th from 10:00 A. M. to 6:00 P. M. and on Sunday March 14th from 10:00 A. M. to 5:00 P. M. There will be seminars which are included in the price of admission, tool suppliers, the woodcarvers and woodturners will have demonstrations and we will be there promoting the club.

We need items for display and a few more members to work the booth. We would like to get your display items before the show or if you can't get them to Sharon before the show then bring them to the meeting. If you would like to work the show give Sharon a call at 991-3860 and you can pick up your badge at the meeting.

NEW BOARD OF DIRECTOR

Bill Baker will be taking over the duties for Bill Smith as a Board of Director.

FIELD TRIPS for APRIL AND MAY

In May we will have a field trip to the Visseroland Organ shop at we have been there twice in the last 10 years and have always found it very interesting. They are just celebrating their 20th year in business. For our new members they make hugh pipe organs for churches and schools all over the country.

David Marsh of David Marsh Furniture has invited us to visit his shop in Saturday April 17 in the Heights. Next month in the newsletter we

will give you more details and directions.

OLD GROWTH LONG LEAF YELLOW PINE

Bud read in Workshop News about a 95 year old plant in Port Arthur, Texas that is being disassembled piece by piece to save as much of this old growth timber as possible. Some of the members are checking this out and we will let you know what they find out.

SAFETY

By Zatis Murphy

Zatis read in Wood magazine that in 1991 there were 30,000 woodworking injuries with 5% requiring hospitalization.

The Five Rights:

1. Dress right
2. Eye protection
3. Ear protection
4. Dust protection
5. Shoe with rubber soles

Also be right ---don't be tired, no alcohol, no medications, you want to be alert and attentive. Make sure equipment is right--saw blades sharp and clean. Check for loose bearings and worn belts. Good housekeeping clean up as you go along. Good lighting, you can never have enough light. When changing blades always unplug that tool do not depend on the switch to save your body parts. stand to one side of the table saw blade. Always use a miter jig, a rip fence or jigs and your table saw guards. Set that saw blade height correct, use push sticks and feather boards. If you are cutting small pieces--use a bandsaw or a handsaw.

When using a miter gauge add an auxiliary fence with sandpaper on the face for gripping power. You can also use stop blocks on this auxiliary fence to make repetitive cuts.

For precision cuts you can mount Two Inca jigs on a board with a fence and clamp to your table saw.

When cross cutting wide boards your miter gauge will not work so make yourself a panel cutter. Zatis showed us the one that he uses, at past meetings we have seen various panel cutting jigs. They consist of a hardwood strip to fit into the groove on your table saw, a piece of plywood with a straight edge across the front--make sure your jig is 90 degrees to the saw blade. Cut off the excess plywood by running the jig through the table saw and you will have an exact end to use to align your cut off pieces. It was suggested that you make a left and right hand panel cutter--one that you can use on the left side of the blade and one that you can use on the right side of the blade.

Zatis suggests the book Table Saw Techniques.

Always remember:
When in Doubt--Don't Do it !

FEBRUARY'S FEATURE PROJECT--Valentine Items

Ed Smith scroll sawed a silhouetted couple in front of a red heart.

Don Sloan made a heart candle holder and carved heart spoon.

Carlisle Campbell made a redwood heart jewelry box.

Ed Burger made an aromatic cedar bandsaw box with a sliding lid.

FEATURE PROJECT - MARCH--TABLE TOPPERS

Anything that you would find on top of a table. Candlesticks, Napkin rings, Napkin holders, Trivets, Bowls, Plates anything that sits on top of your table. Get those thinking caps working. Lots of possibilities here !

SHOW AND TELL

Guy Meaders made a four drawer shop cabinet on casters.

Jimmie Harp made a four drawer cabinet which his wife designed out of old oak flooring. He sawed off the tongue and groove to make up the panels, used finger joints in the drawer assembly. Purchased his hardware from The Woodworkers Store (one of our advertisers), finished it with five coats of Bartley's stain and four coats of Bartley's varnish and then wax.

Robert Sandlin made an Oak magazine rack table finished in Bartley's.

Bud Froelich showed us an entry table with tapered legs, top finished with Bartley's varnish and rest of table painted.

One member to improve his hand writing purchased a fountain pen only to find out he had to make his own blotters. He had to experiment with various curves on the blotter bottom. You have to purchase ink blotter paper which he found cuts the best with his wife's fabric roller cutter.

Another member made a rosewood box to display his daughters engraved wedding invitation.

MARCH MEETING

WHEN: MARCH 13TH, 1993 9:00 A. M.

**WHERE: BAYLAND COMMUNITY CENTER
ON BISSONNET AT HILLCROFT**

PROGRAM: Open Forum on Your favorite Safety Shop Aid--please bring your favorite push sticks, featherboards, guards, etc. We are doing this because some of the members have to work the tool show and the rest might like to attend the show. See You There!!!!!!!!!!!!!!!!!!!!

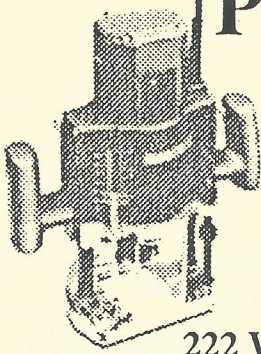

Pasadena Industrial Supply

BOSCH

\$185

*Closeout Special!
Quantities Limited!*

3 hp Variable Speed plunge router gives a "soft start" & delivers constant speed even under load. Provides speed range of 12000-18000 rpm. Plunge base has 3" stroke & can be set at 8 different plunge depths.

We also have single speed & 220 volt versions available at similar savings

222 West Pasadena Freeway, Pasadena Texas 77506 472-5588



5117 April Lane, Houston, Texas 77092
Hours: M-F 7:30-5:00 SAT 8:30-12:30
(713) 686-6176 Phone
(713) 686-3217 Fax

DOMESTIC & IMPORTED HARDWOODS

Ash, Basswood, Birch, Cedar, Cherry, Cypress, Mahogany, Maple, Red Oak, White Oak, Padouk, Poplar, Purpleheart, Redwood, Sycamore, Teak, Virola, White Pine, Walnut, and More.

High Quality Domestic & Imported Plywoods, Softwoods, Hardwood Veneer Edgbanding & Hardwood Veneers
Excellent Service & Competitive Prices!

ON SITE CUSTOM MILLING TO YOUR SPECIFICATIONS, S2S, S2S1E, S4S (No order too large or too small) 10/93

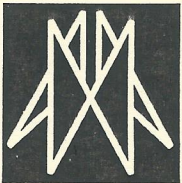
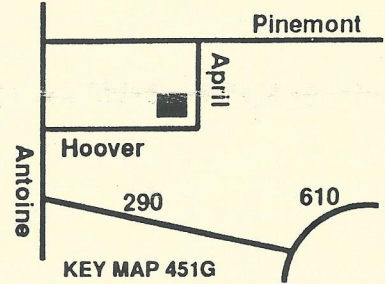

AUSTIN HARDWOODS

13001 VETERANS MEMORIAL DR.
HOUSTON, TEXAS 77014

440-0764

We stock over 80 species of lumber including rare exotics and turning stock. Plywood, Veneer, Moulding, Flooring, Tools, Millwork, Paneling Etc. also available

Exp. 2/93

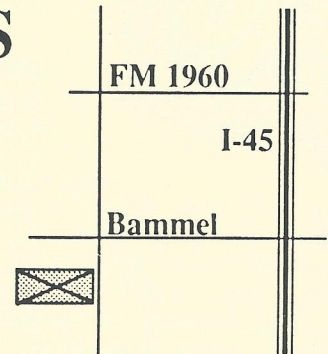

HARDWOOD LUMBER CO.

700 E. 51/2 St. (In The Heights)
Houston, Texas 77007
(713) 862-6628
Hours: M-F 7:30-5:00, Sat. 8:30-1:30

We stock over 65 species of lumber including
hard to find exotics!

*Also: Plywood, Veneer, Moulding, Formica,
Custom Milling, Woodworking Tools, Books, etc.*

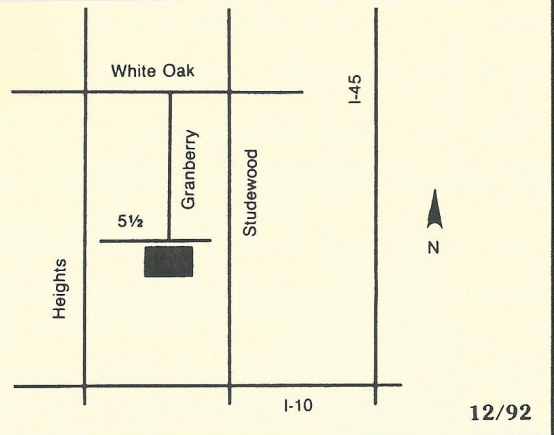

Send Today for the Most Complete Catalog Selection of Woodworking Supplies

Please Enclose \$1.00 (3rd class) or \$2.00 (1st class)

Name _____

Address _____

City _____ State _____ Zip _____

Orders Shipped Within 48 Hours

7/93

21801 Industrial Blvd., Rogers, MN 55374

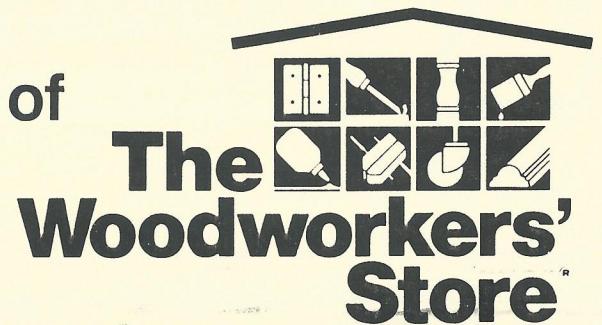

PRINTED BY SPEEDY PRINTING SERVICE OF TEXAS 3727 W. ALABAMA, HOUSTON, TX. 77027 (713) 877-8466

Woodworkers Club of Houston
P.O. Box 34481
Houston, Tx 77234

