

Woodworkers Club

OF HOUSTON

VOL. 6, NO. 3

MARCH, 1990

Officers

Don Richardson - President 661-1365
Ted King - Vice President 351-6808
Claude Emory - Sec./Treasurer 861-3495
Sharon Buckley - Newsletter Editor 944-6739

Board of Directors

Bill Baker - 667-8381
Bob Gallant - 376-0276
Bill Hochmuth - 774-1733
Bill Sallans - 465-0291

FEBRUARY MEETING

Our guest speaker was one of our own members, Denis Muras. If you have been a member for any amount of time you have seen some of Denis's spectacular projects. Some might call his projects toys but that's a gross understatement---his projects are scale models. He makes Trains, Trucks, Farm Tractors, and many more models. His detailed models are really adult toys, as the saying goes the only difference between men and boys is the price of their toys. He does make model toys for young people also. He showed us two types of Caterpillars one of the bug variety and one of the Diesel variety. His caterpillar bug was made of circles cut with a hole saw, the circles of wood strung together with nylon twine with beads in between each circle, and painted a lively non toxic green finish.

He demonstrated a Caterpillar Bulldozer with working tracks, similar to a roller chain. I'm not to sure that many of us would have the patience to attempt a project this involved, but Denis is already starting an improved design.

Denis is an Engineer for Hewlet-Packard, which gives him the background for working out the design problems in the drawing stage before he starts work in his shop. His father is a finish carpenter where he gets most of his material (scrap) which he turns into dream machines. We all better take a closer look at our scrap bins!

Denis does this mainly for fun and not for profit. But he uses many techniques to mass produce common parts. One night he will cut out wheels using a hole saw, to true them up he stacks them altogether on a threaded rod and puts them on a lathe and sands them smooth and true.

A good item to mass produce are Trains, they all use the same chasis, wheels and roof. Also trucks as many can use the same chasis.

Denis gets some of his plans from books by Norm Marshall, Richard Blizzard and David

Wakefield. when he can't find what he wants he draws up his own. Right now he is working on copyrights to his own designs and plans some time next year to market is own plans. A friend wanted him to make an Old Style Fire Engine, when he could not find any plans he worked from a photograph, and drew up his own plans.

He has made almost all of the Strom Design Toys, which he had photos of in an album that he passed around.

Many of the members wanted to know how long it takes to make one of his detailed models and Denis said he really didn't want to know. These are not weekend woodworking projects.

We would all like to thank Denis Muras for sharing his talents with us all and his patience in answering all the questions from the members. He did a great job and we have always said that some of the best woodworkers can be found in our own membership.

PROGRAMS IN THE FUTURE

Ted King is working feveriously to come up with programs to interest the members. If you have any ideas or know of any please let Ted know.

In April the program will be given by Ken McBride--How to Make Drawers. Ken is an excellent woodworker and teacher. A couple of years ago he gave a program on hand tools and I can easily say it was one of the best we have offered for the membership. So adjust your personal plans so you won't miss this Program. REMEMBER BECAUSE OF EASTER THE APRIL MEETING WILL BE THE THIRD SATURDAY NOT THE SECOND. THE DATE WILL BE APRIL 21, 1990 AT 9:00 A. M.

Stuart Murphy is lining up a woodworker from The Texas Renaissance Festival for a program.

Later in the summer Royce Bomar will give a program on Antique tools.

SAFETY

By Murray Gordon

Murray spoke on eye safety. Every one who is in the shop, even if your just watching should have on a good set of Safety glasses. The lens should have a white indicator on the bottom of the lens denoting that they are safety glasses. They should also have side shields as chips don't just attack you from the front. In some operations you should also wear a face shield with your safety glasses. Over the counter safety glasses have glass lenses which are heavy and lenses made of Poly carbonate plastic which is light but easy to scratch, prices range from \$3.00 to \$10.00.

Regular Prescription glasses are not safety glasses. Prescription safety glasses look much like regular glasses these days and if you wear glasses all the time it might be advantageous to get Prescription Safety glasses with detachable side shields.

Goggles can also be used but in this climate they fog up because of condensation.

For lathe work a full face shield should be worn.

To help reduce static dust buildup on your lenses use the paper fabric softener sheets after they have been used in the dryer with your clothes. Do not use new sheets as they are to gummy.

Be careful with your eyes it only takes an instant to seriously injure your eyes.

There was an article a while back in one of the woodworking magazines by an eye doctor who was also a woodworker. In this article he explained the eye safety and eye wear, also he related true cases in which he had treated serious eye injuries from patients that had suffered an eye injury while working on a machine(as in making adjustments, not while woodworking). One person would be under the machine another person above the machine, and this person had dropped a screwdriver accidently into the other persons eye. So around any tools wear thoses safety glasses.

PROBLEMS AND SOLUTIONS

Last month Bob Soderblom had a cast iron part that had been cracked, a tool rest on his lathe--instead of having it welded he used super glue (crazy glue) he tested it with a ball peen hammer, for safety sake he also used a hose clamp. It was suggested that if he used a 2-part Epoxy he would not need the clamp.

Ted King had a problem with how to scarf plywood for a canoe he was building.

Ted also had a problem with a Inca Planer/Joiner. Ted thought he had gear trouble but one of the members said that he had the same problem with his Inca. The problem was the original drive belts were round and they did not work properly, Inca has a conversion kit, so you can use flat belts. I understand Ted contacted Garret-Wade and they sent him a

conversion kit, which has solved the problem.

Stuart Murphy had purchased a box of dado sets, and wanted to know how to tell which set went with which set. Use the combination blades on the out side and the chippers on the out side, just make sure that the chippers are the same length as the blade.

Sam Gainer has a good source for Beveled Glass in Bellville, his name is Jerry Lewis, no not the Jerry Lewis.

Robert Sandlin had a problem with the 2-part plastic used on the face of clocks. It was suggested that you use a hair dryer to eliminate the bubbles. Another suggestion was to first seal the wood, then apply the plastic and you won't get any bubbles.

BUY AND SELL

If you would like to list an item for sale or one that you would like to buy. You must tell me Sharon Buckley three (3) weeks before the next meeting, you can call me or drop a note in the mail. Items sell faster if they are listed before the meeting. Items announced at the meeting will not be listed in the next issue because they are normally sold before the next issue is printed.

This Items are for Sale:

Craftsman 10" Radial Arm Saw \$200.00
contact Skip Lambracht at 550-1221.

Mille-Route contact Chuck Maxwell at
469-0588.

Craftsman 8" Table Saw \$125.00 contact Bill
Baker at 667-8381.

SHOW AND TELL

Zatis Murphy showed us a Shaker step stool. He made the box joints on a Table Saw. Finished in Watco oil.

Chuck Maxwell has started on his charity show projects by making a Giant Clothes Pin, no not for the giants clothes but for messages. Chuck brought the clothes pin spring from Meisel in Mound, Minn.

Chuck is also working on a spindle sander, featured in Woodworkers Journal, Chuck found the knobs locally at Wholesale Tools at 8100 Pinemont. (They are now stocking a wide variety of knobs).

Chuck also had a carved spoon that was featured in Wood's Weekend Woodworking Magazine.

Ed Caesar has also made a spindle sander .

Sam Gainer described how he has made picture frame molding. Some of his ideas

originated from Woodsmith Magazine Issue # 60. Sam uses a Freud Face Moulding Bit 99-015 which he paid about \$50.00 he says Grizzly has one for about \$30.00.

Ken Walls showed us a very simple jig he made to sharpen a scraper on a disc sander. When he gave his workshop on stave bowl construction at Shopsmith, Ted Cooper and Andy Anderson video taped it and the tape will be available for the members to check out.

Router Table--there was some discussion on do you need a router table. To make your router safer, easier to use and much more versatile find a way to mount it. You don't have to have permanent table, some people mount a table top in their workbench vise, one member had the table saw wings machined to accept his router or you can make the table saw wings out of wood, and you can use the fence on your table saw as a fence for your router. In our new video How to Make a Shaker Table Kelly Mehler has his router mounted to table top and sets the table top on top of a 55 gallon drum. On the side of the drum he has cut a door so he can make adjustments to the router. The main thing is to make that router stationary and you will use it a whole lot more.

ANNOUNCEMENTS

Selling on Harris County Property Grounds. Under the rules that we agreed to abide by if we want to use the facilities of The Bayland Community Center, we are not allowed to have money transactions anywhere on the property.

You can announce them at the meeting but it is suggested that you make your transaction across the street in one of the many parking lots. The club is allowed to use this very nice facility free of charge as long as we abide by a few simple rules. We appreciate all the members help in this matter.

Remember lets all have fun.

Stuart Murphy announced that Norman Newberry had an interesting dust collection system in his shop and would like to invite everyone to an open shop on Saturday March 17th. Stuart was going to get back to me with the details, but I haven't heard anymore than what was said at the meeting. We'll just have to ask Stuart at the March 10th meeting if it is still on and the times. Norman lives off the Gulf Freeway, take the Edgebrook exit at, 815 Elton Phone 946-1553.

Leo Oringderff and Ed Caesar have been assisting some people get back on their feet with woodworking classes at the HMR. If you would like to help or would just like to visit call Leo at 445-5460. They meet on Tuesdays.

Dues are \$18.00 for any member who is renewing his membership. To be fair to new

members and to make it easier for our volunteers who have to keep track we prorate the remainder of the year for NEW MEMBERS because they would not have received the newsletter till they join.

NEWSLETTER INFO

Is your newsletter arriving too late? Last month we had a few members who had not received their newsletter or had just barely received their newsletters on time. We try our best to get it in the mail one week before the meeting because we have a lot of members in outlying areas or way out of town. The February newsletter was mailed the Friday one week before the meeting. We send the newsletter out by First Class mail to eliminate any delays that would occur by sending it out bulk.

Thad Brown who mails the newsletter is so on the ball in getting these newsletters in the mail early, sometimes he does the final three fold if they are delayed at the printer (the delays at the printer are usually our fault or mother nature). If you are not getting your newsletter on time first check to see if everything is correct on the label, especially the zip code.

If this is correct and the newsletter is still late check with the Post Office which delivers and find out what's wrong.

We had only one newsletter returned this past month because a portion of the mailing label was ripped off and only the members name survived and not his address.

One good thing about having a permanent meeting place at least you know where the meeting is, and we only have one meeting date change this year which we have told you about in this issue and the last issue.

Remember we have extra issues at the meeting that you may have if something happens to yours or you would like an extra copy.

MARCH MEETING

WHEN: MARCH 10, 1990 9:00 A. M.

WHERE: BAYLAND COMMUNITY CENTER
ON BISSONNET AT HILLCROFT

DIRECTIONS: For map refer to your December Newsletter. Go out the Southwest Freeway (Highway 59 South) take the Hillcroft exit. Go south on Hillcroft, turn right on Bissonnet and the Bayland Community Center is on the right. Follow the signs in the park to the community center.

Program: So you want to sell your craft for money? Where do I start? Do I go the route of the crafts fairs or wholesale?

We hope to answer some of these questions and more.

SAFETY

The following article is from the Power Tool Institute on Jointers.

Operators must be fully alert at all times when using jointer/planers.

Always wear safety goggles or safety glasses with side shields complying with current national standard, and a full face shield when needed. Use a dust mask in dusty working conditions. Wear hearing protection during extended periods of operation.

Do not wear gloves, loose clothing, jewelry or any dangling objects including long hair, that may catch in rotating parts or accessories. Read and understand the warnings and instructions on the jointer/planer itself and in the owner/operator's manual.

Check often to assure that guards return to their normal position quickly. If a guard seems slow to return or "hangs up", repair or adjust it immediately. Never use a jointer/planer without a properly operating blade guard.

Set up knives and tables in accordance with the owner/operator's manual.

Lock knives securely in place to the cutter head before start-up.

Knives must always be kept sharp.

Do not attempt to sharpen knives while they are installed in the cutterhead, unless proper attachment is provided.

Check the cutter guard and tension of the cutter guard springs for proper closure.

Examine your workpiece very carefully. By all means do not joint or plane chipboard, panelboard or any stock containing nails, paint or varnish.

Be very cautious of knots in wood. Knots can fly out or cause kickback. Avoid this.

When edge jointing, planing or bevelling, use holddown pushblocks to keep your hands well away from the cutter head.

Never operate a jointer/planer without belt guards (if so equipped) and cutter head guards in place and working properly.

The portion of the knives of the cutter head that isn't being used should be covered at all times.

Wood narrower than 3/4 in. or thinner than 3/8 in. should not be jointed or beveled. Wood shorter than 12 in. should not be planed, jointed or beveled.

Never reach up an exhaust chute to unclog chips. Stop the tool and unplug it. Clear the chute with something other than your bare hand. The knives up there are razor sharp.

Make certain you support long lengths of stock to maintain "control". Use work supports as needed.

Feed your work with the grain. Always feed against rotation of the cutting knives.

Don't try to take off too much in one cut. Not more than 1/8 in. per cut.

Your hands should never pass over the cutter head when feeding work. The only exception is if both hands are protected by holddown pushblocks that keep hands separated from the cutterhead. Maintain complete alertness.

Always unplug if possible and lock the switch, if a lock is available, before changing blades or knives, making adjustments, performing maintenance jobs and when the tool is not in use. Store the key.

ROSTER OF THE MEMBERSHIP FOR 1990

Enclosed in this newsletter is your roster for 1990. We will update it at least one more time this year. To keep yours current each month we will list in this newsletter any new members and any changes to the current roster. please keep it where you can find it, as the roster can come in handy through out the year.

WOODWORKING WORLD SHOW

By the time you receive this newsletter the show will be over, so far it looks like we will have a good representation of various types of woodworking displayed.

We would like to thank all those who displayed their projects and to all the members who worked the booth.

In the past years we have done very well at recruiting new members.

NEWSLETTER ARTICLES

Have you tried a new product or a new tool? How about sharing what you have learned about the product or tool.

New finishes are coming out daily. Many new non-toxic and much safer finishes are now available. Have you tried any of these and would you share your experiences with any of these new finishes?

Remember to get an article or buy or sale in the newsletter you must get it to Sharon three (3) weeks prior to the meeting.

Pasadena Industrial Supply Power & Hand Tool Show

April 20, 21 & 22

Live Demos by factory reps. Door Prizes, Free Hot Dogs & Drinks,
Special Pricing for 3 days only!

222 West Pasadena Freeway, Pasadena Texas 77536 472-5588

Hardwood Lumber Co.
Lawndale Division
Imported and Domestic

Marine Plywood
Parana Pine
Teak

Honduran Mahogany
Exotic Hardwoods
Domestic Hardwoods
WALNUT - BIRCH - ASH - CHERRY
CYPRESS - RED AND WHITE OAK
AND OTHERS

Quality
Hardwoods - Softwoods - Plywoods
Mouldings & Squares

MON. - FRI. 7:30 TO 4:30
SAT. 8:00 TO 1:00

5401 Lawndale
(713) 921-6131

A COMPLETE SELECTION OF FINISHING SUPPLIES.

Exp. 12/90

Come in and checkout our over arm router system

Check out our hardwoods - Bowl and spindle stock -
Exotic hardwoods - Best prices in town.

Hours:
Monday to Friday:
10:00 a.m. to 6:00 p.m.
Saturday:
9:00 a.m. to 5:00 p.m.

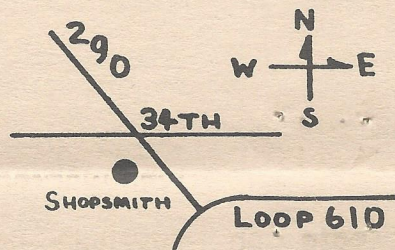

Shopsmith Inc.

Northway Shopping Center
10965A Northwest Frwy.
Houston, TX 77092
Phone: (713) 681-5200

Exp. 1/91



AUSTIN HARDWOODS

13001 VETERANS MEMORIAL DR.
HOUSTON, TEXAS 77014

440-0764

We stock over 80 species of lumber including rare exotics and turning stock. Plywood, Veneer, Moulding, Flooring, Tools, Millwork, Paneling Etc. also available

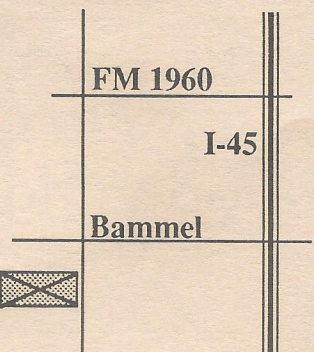

Exp. 8/89

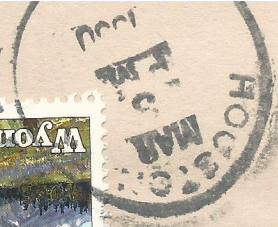

Woodworkers Club of Houston
P.O. Box 34481
Houston, Tx 77234

Houston Wood and Tool, Inc.



DAP Weldwood®
Hobby & Craft Glue



DAP Weldwood®
Plastic Resin Glue

- **Classes**
- **Fine Hand Tools**
- **Power Tools**
- **Portable Electric Tools**

Visit our showroom. Open Monday to Saturday

Mon., Tues, Wed & Fri 8 to 5, Thurs. 8 to 8, Sat. 9 to 4.

Come by or call 680-1744 - City Sales.

Located two blocks west of Highway 290 on 34th Street.
5857 W. 34th Street - Houston, Texas 77092

Exp. 4/90

HARDWOOD LUMBER CO.

700 E. 51/2 St. (In The Heights)
Houston, Texas 77007
(713) 862-6628
Hours: M-F 7:30-5:00, Sat. 8:30-1:30

We stock over 65 species of lumber including
hard to find exotics!

Also: Plywood, Veneer, Moulding, Formica,
Custom Milling, Woodworking Tools, Books, etc.

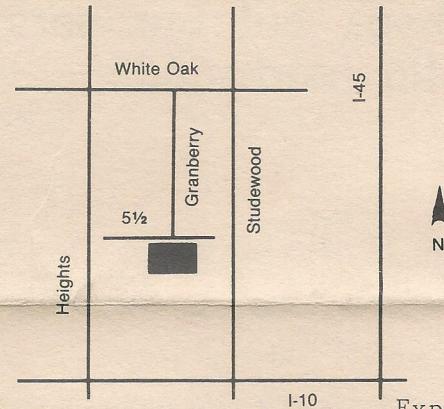

Exp. 9/90

Send Today for the Most Complete Catalog Selection of Woodworking Supplies

Please Enclose \$1.00 (3rd class) or \$2.00 (1st class)

Name _____

Address _____

City _____ State _____ Zip _____

Orders Shipped Within 48 Hours

Exp. 1/91

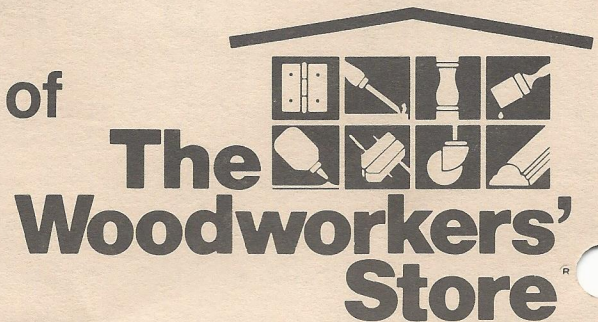

21801 Industrial Blvd., Rogers, MN 55374