

Woodworkers Club

OF HOUSTON

VOL 10, No. 6

JUNE, 1994

Officers

Sharon Buckley - President 944-6739
Art Chester - Vice President 469-1990
Steve Procter - Sec./Treasurer 728-1459

Board of Directors

Bud Froelich - 859-6620
Jimmie Harp - 664-4906
Ted Kurland - 729-4693
Joe Wainright - 666-8475

Sharon Buckley - Newsletter Editor 944-6739

MAY PROGRAM

Our program for May was on abrasives, presented by Kevin Hayes and Brad Wilson of Norton Abrasives. Kevin and Brad passed out two brochures: How to select the right sandpaper and True Grit sanding tips from the world's abrasives leader. Each and every member that attended the meeting received a Norton Paint and Varnish Stripping Pad made of Bear-Tex Nylon Abrasive. Since everyone received a brochure that details what sandpaper is: the different abrasive grains, grits, abrasive bonds, abrasive backings, open-coat vs. closed-coat, the brochure also goes into smoothing drywall compound or plaster, refinishing painted or varnished doors and woodwork, refinishing cabinets made of soft woods and refinishing metal furniture, even has tips for using and storing sandpaper, I suggest you read the brochures.

The butt joint on sanding belts are the strongest--the joint is butted together and fastened with mylar tape, a butt joint can be run in either direction as opposed to a lap joint which is glued under pressure and this type of belt can only be run in one direction.

Is there a shelf life for belts? Yes about one year, but alot depends on how and where that belt is stored. Because of high humidity and high heat in our shops it would be best to store your sanding belts inside your house.

We would like to thank Kevin Hayes and Brad Wilson for an informative program on sandpaper and for the Bear-Tex Nylon Abrasive Pad that we all received and for the Norton Jacket that they donated to our club raffle. Thanks again fellas.

MAY RAFFLE

We had so many things for the raffle that I just didn't get the winners names. The raffle consisted of the Norton Jacket donated by Norton Abrasives. The raffle prizes were a set of Jorgensen 12" bar clamps, a pair of Tony Spring Clamps, Hearing protectors and

safety goggles.

Mark Henry, manager of the Houston Woodcraft store attended the meeting bearing gifts of General Finishes Royal Finish Satin. This is a wipe on oil modified urethane, it has the protection of a polyurethane and is non-toxic after drying. We included these in our raffle, thanks Mark we always take any donations.

JUNE RAFFLE

Don't forget we will have another raffle at the June meeting so get your Dollars ready.

The money goes for Video Tapes and or books for the library.

Denis will have the Five new titles available for check out at the June meeting, there will be Ten tapes available for check out.

SHOW AND TELL

Chuck Maxwell showed us some new jigs that he made: one for making dovetails on a table saw, a very simple jig for making dados with a router and also a depth gauge,

John DeBender showed us a Mahogany Plant stand that he made from Walnut.

Lewis Vallette turned a bowl consisting of 84 pieces made up of Cherry, Mahogany, and Oak, and two bowls of 88 pieces each. Lewis also made some fixtures for his lathe, he salvaged some hex stock from the junk yard and made face plates for his lathe--Lewis also made the lathe from salvaged and new items.

Bill Smith made an Amish Man and Woman in rocking chairs from salvaged pallet material.

Guy Meaders made a Barristers Bookcase from plans in Woodsmith and finished it with Bartleys'.

Jimmie Harp showed one of the three tables that he has made from Long Leaf Yellow Pine salvaged from a grain mill in Beaumont. To make the top Jimmie ripped up 2 x 8 's then glued up three panels to make the top--to accomplish this the joints must be perfect.

Ken Wallis showed a variety of turned bowls made up of Bubinga with lots of sapwood, Corian and wood, which he glued up using yellow carpenters glue and its still holding together and a bowl made up of Bubinga and Maple. All finished in Bartley's.

Bill Hochmuth had a music box made out of old Cherry and Walnut. Bill demonstrated the 72 note movement.

Larry Barnes made a pencil marking gauge out of brass.

Wow what a great assortment of woodworking items from the members keep up the good work.

Don't forget each member that brings a show and tell receives a free raffle ticket.

MAY'S FEATURE OF THE MONTH

May's feature of the month was bookends and magazine racks.

Don Sloan made a sliding set of Oak bookends with dowel rods.

Bill Hochmuth made a magazine rack out of East Texas Maple with a Knotty Pine Panel. He personalized the magazines with the persons initial on each end. Bill got the plans out of Woodsmith.

Joe Wainright made a set of Southwest Bookends. Plans are out of Wood Magazine. Each bookend was made up scrollsawed pieces of an Indian, cactus, grasses, etc.

JUNE'S FEATURE OF THE MONTH

Anything with a drawer or drawers. From tiny drawers to large items, anything goes.

SAFETY-----THE LATHE By Zatis Murphy

Dress properly---long sleeves must either be buttoned or rolled up above the elbow.

Always use sharp tools, with a dull tool you will likely force the tool.

Use the right speed---The bigger the piece the slower the speed.

Cut the corners off a square piece before placing on the lathe except for small items like pens and pencils.

Stand to one side when starting the lathe to make sure the piece will not fly off of the lathe.

When face plate turning, if you use paper as a seperator let the glue dry over night.

Do not force a tool when cutting on a face plate it can go flying across the room.

Long spindles should be supported in the center, you can purchase a roller support or you can make one yourself. Long spindle turning can create harmonic whip.

Use a tool rest appropriate for the piece you are turning.

Unplug machine to change various set ups. Switches can fail sometimes in the on position.

Safety switches the type where the center pulls out for safety, can collect dust and moisture.

You should always wear safety glasses and a full face shield.

Stand comfortably, keep the floor clean of debris.

Pay attention to what you are doing.

Remove all of your jewelry before working in the shop.

Remove the tool rest before sanding.

When applying finish or polish do not have any loose strings or pieces these can be wrapped around the piece or your fingers.

No gloves--some turners use skin tight golf gloves when sanding. The heat from sanding can bring up blisters.

UPCOMING PROGRAMS

JULY--We will have representative from Bostitch discussing compressors and pneumatic tools. He will also be bringing some raffle prizes.

Upcoming months: Art is still working on program on the table saw.

Because so many woodworkers become sensitized to various wood dusts with allergic reactions Art is working with the Airmate/Airlite Mask Co. for a program.

Art is also trying to get a custom woodworker that makes usual furniture to give us a program.

WANTED WOODWORKERS

Woodcraft is looking for skilled woodworkers to conduct demonstrations usually Saturday at Noon, pays \$25.00 an hour. They are also in need of woodworkers to conduct classes. If you have a particular skill and would like to pick up a few extra dollars contact Mark Henry at Woodcraft 681-5200.

CALL FOR SUBMISSIONS

Do you have a toolbox you are proud of? Do you have some nice pictures of it (transparencies hopefully)? Can you describe the history of the box (if it's an antique), its concepts of design and construction (assum.

you created it), and how you use the box in your everyday woodworking? Then Fine Woodworking wants you for a project currently under development!

The scope of this project is quite broad--anything from the most modest carpenter's tote to the most exquisite, furniture-like standing tool chest is welcome for consideration here. All submissions will be acknowledged and returned (enclose a self-addressed, stamped envelope please). It hardly needs to be said that the tool boxes chosen for publication will enjoy a wide exposure to an appreciative audience. Your name will, of course, appear with the photo and you will receive a free copy of the publication.

Send your submission to:

Toolbox Project
c/o Helen Albert
The Taunton Press, Inc.
63 Main Street
Newtown, CT. 06470-5506

FOR SALE

- 1). Craftsman Woodshaper 1/2" spindle with forward and reverse switch. Like new unit is free standing and sells new for \$450.00 Will sell for \$280.00 or best offer.
- 2). Millroute system--mounted on coreboard tabletop, Never used sells for \$295.00 will sell for \$200.00.

Contact Jerry at 586-7283 eves.
864-7800 days.

For Sale: Betty Terry's brother passed away leaving a shop full of various woodworking and metal working tools for sale.

Items include Delta Tablesaw, 12" disc sander, 14" bandsaw, Enco Mill, Bico Drill press, Ryobi scroll saw and an assortment of power tools, a large assortment of measuring devices(calipers, micrometers, squares)

Contact: Betty Terry at 667-3716.

Free cutoffs of construction grade #4 yellow pine 2 x 8, 2 x 10, etc. Phil at 937-1400 location Clay and Gessner in Spring Branch.

FIELD TRIP

Ken Wallis has scheduled a Field Trip to A-1 Manufacturers of Bowling Alleys in Nacogdoches.

We will tour the plant, which should take about an hour.

Maple will be available for the members to purchase, right now it is selling for about 13 cents a linear foot and you will not have to purchase a whole bundle--just how much you need.

We will then go to Ken Wallis's place for a

picnic. Bring your own lunch and chairs, and drinks will be provided.

We will meet at A-1 on July 16 at 11:00 A. M. Its a nice three hour drive, just off of Highway 59. Please invite your spouse and make a day of it. We will provide a map in next month's newsletter.

Some of the members may want to car pool--we will have a sign up sheet for those wishing to drive and if they would be willing to take riders.

PRESIDENT'S CORNER

By Sharon Buckley

Last month I mentioned that we may have to look for another location to have our December Dinner because of the large increase in costs.

I asked for suggestions and received a couple. The one that I have since received prices from will cost approximately \$22.00 per person. I would like some impute from the members at the June meeting as to what you think about having a December Dinner or not having a Dinner. So think about it and if you would like to come, would the \$22.00 per person be to expensive for your pocketbook. I would like to get a fairly accurate count as to how many would be attending.

The date set is Friday December 9th, 1994 the day before our regular December meeting.

At the May meeting Ken Wallis presented me with a very nice Bubinga Bowl that he had turned the day before. I understand that Ken's wife Wilma picked it out of a couple that he had made. I would like to thank Wilma for picking out the best of the group and for Ken's and Wilma's generosity in the gift. Thank you both very much.

Art is still trying to get a firm date from the Rocking Chair Manufacturer in Tomball for a field trip. He was scheduled to visit the last week of May but was able to get an OK to visit. He will keep trying and trying. For any member that has not had to get programs or field trips can not know how difficult it is to get a firm commitment from woodworkers.

Maybe so many of us work in a solitary shop that we don't or afraid to speak to a group.

Aluminum Bar clamps--some of the members have asked if we could order these clamps again?

If we have enough members wanting to order clamps I will be glad to place an order.

We must order at least 10 of each size(one box). On the following page I have included a cost per clamp. Plan on how many and what size you would like to order and we will see if we have enough. Then we will work up an order and then we will need your money.

DUES--Dues are \$24.00 per year--for new members dues are prorated at \$2.00 per month for the remaining months. Year runs from January till December.

QUAN.	SIZE	LIST PRICE	CLUB PRICE	TAX * EACH	UNIT PRICE W/TAX	TOTAL
	24 INCH	22.95	15.37	1.27	16.64	
	36 INCH	24.95	16.52	1.36	17.88	
	48 INCH	28.95	17.60	1.45	19.05	
	60 INCH	N/A	18.83	1.55	20.38	
	72 INCH	33.95	19.98	1.65	21.63	
	UC-76 CLAMP	21.95	13.00	1.07	14.14	
	UC-76C CLAMP	22.95	14.50	1.20	15.70	
	FEATHER BOARD	18.95- 24.95	14.50	1.20	15.70	

We Guarantee The Lowest Price On JET Machinery Every Day!

- Henry Taylor Carving & Turning Tools
- Woodworking Machinery by Jet, Bosch, Porter-Cable, Foredom, Sugingo, Carba-Tec & Others
- Accessories, supplies, books and videos
- European & Japanese-Style Hand & Edge Tools

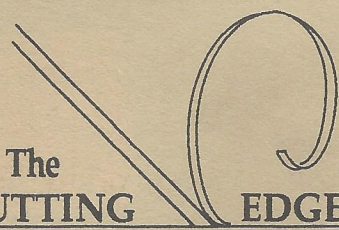

The
CUTTING **EDGE**, Inc.
Woodworker's Tool & Supply

7123 SouthWest Fwy @ Bellaire Blvd. (713) 981-9228

Pasadena Industrial Supply

Oops, we bought too many, Our mistake your gain!

PORTER+CABLE
PROFESSIONAL POWER TOOLS

List \$260

Sale \$129

While they last!

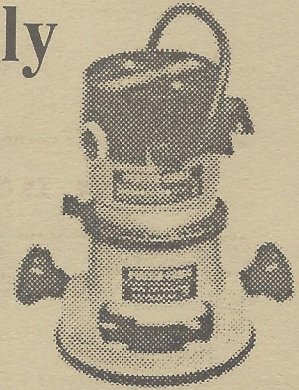

- * Router Model 690
- * 1-1/2 HP
- * 1/4 & 1/2 Collets
- * Flat top design for fast, easy bit changes

222 West Pasadena Freeway, Pasadena Texas 77506 472-5588



4910 West 34th St, Houston, Texas 77092

Hours: M-F 7:30-5:00 SAT 8:30-12:30

(713) 686-6176 Phone

(713) 686-3217 Fax

DOMESTIC & IMPORTED HARDWOODS

Ash, Basswood, Birch, Cherry, Mahogany, Maple, Red Oak, White Oak, Poplar, Walnut Etc.

High Quality Domestic & Imported
Plywoods, Softwoods, Hardwood Veneer

We've Moved

Please Visit Us At Our New Location

4910 WEST 34th STREET

(BETWEEN HWY 290 & MANGUM)

11/94

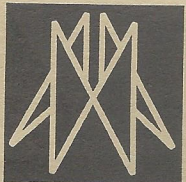

AUSTIN HARDWOODS

13001 VETERANS MEMORIAL DR.

HOUSTON, TEXAS 77014

440-0764

We stock over 80 species of lumber including rare exotics and turning stock. Plywood, Veneer, Moulding, Flooring, Tools, Millwork, Paneling Etc. also available

FM 1960

I-45

Bammel



2/94



WOODCRAFT®

Woodworking Tools • Books • Supplies
Since 1928

Woodcraft offers over 4,500 of the finest woodworking tools, books, supplies, cabinetry hardware, and wood available in the world today! We are committed to woodworkers of every skill level, from beginners to professionals, and every discipline, from carving to woodturning and fine cabinetry! Ask about our classes and demos next time you're in our neighborhood! We are an authorized dealer for Shopsmith, Delta, Porter Cable, Bosch, Record Marples and many more favorite, top quality brands!

**EXCLUSIVE U.S.A.
DISTRIBUTOR
SWISS MADE
CARVING TOOLS**

Northbrook Shopping Center • 5360 West 34th Street • Houston, TX 77092 • 713-681-5200

HARDWOOD LUMBER CO.

700 E. 51/2 St. (In The Heights)
Houston, Texas 77007
(713) 862-6628
Hours: M-F 7:30-5:00, Sat. 8:30-1:30

We stock over 65 species of lumber including
hard to find exotics!

Also: Plywood, Veneer, Moulding, Formica,
Custom Milling, Woodworking Tools, Books, etc.

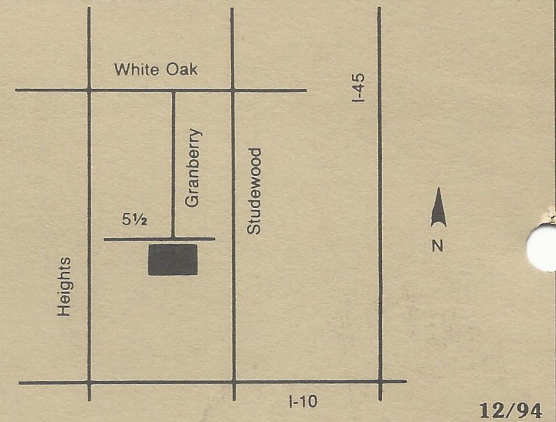

Send Today for the Most Complete Catalog Selection of Woodworking Supplies

Please Enclose \$1.00 (3rd class) or \$2.00 (1st class)

Name _____

Address _____

City _____ State _____ Zip _____

Orders Shipped Within 48 Hours

7/94

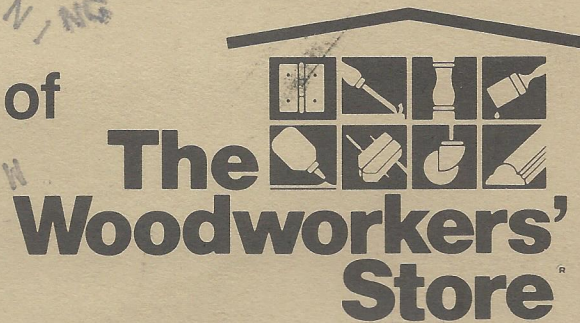

21801 Industrial Blvd., Rogers, MN 55374

PRINTED BY SPEEDY PRINTING SERVICE OF TEXAS 3433 WEST ALABAMA, SUITE C • HOUSTON, TEXAS 77027 • 713-877-8466

Woodworkers Club of Houston
P.O. Box 34481
Houston, Tx 77234

