

Woodworkers Club OF HOUSTON

VOL. 9, NO. 6

JUNE, 1993

Officers

Bud Froelich - President [REDACTED]
Ted Kurland - Vice President [REDACTED]
Joe Wainright - Sec./Treasurer [REDACTED]

Sharon Buckley - Newsletter Editor [REDACTED]

Board of Directors

Art Chester - [REDACTED]
Jack Conry - [REDACTED]
Denis Muras - [REDACTED]
Bill Smith - [REDACTED]

MAY MEETING

The scheduled speaker failed to show up or even bother to call to say that he could not make it. So an impromptu program was put into action--Bud went into an open forum on Good Machines and what would you recommend as your chose of tools.

One member wanted to know what type of lathe would be best, it was suggested that a variable type of lathe would be the best like the Delta Electronic Lathe.

Another member asked about speed controls for routers, first check to see if your router has a universal and not an induction motor. If you intend to do a lot of routing at a slow speed it would be best to buy a variable speed router, but for limited use one of these speed controls will work.

What is the best type of table saw to buy? Some members recommend the Delta Contractors or Unisaw, either one would be a good choice---but all members agree that the most important thing on any table saw is a good fence. When you buy a Delta saw you can save some money by purchasing a Unifence at the same time. If you already have a table saw you can up grade it with a variety of different brands of very efficient fences: The Unifence, Beismeyer, Excaliber, etc. We have a lot of members that own these brands and they can tell you more about that particular type of fence.

If you have a saw that you would like to improve the performance of ---check what type of pulley and drive belt that is on your current saw. If you have cast pulleys get a turned steel pulley and a segmented belt the type sold by Inline Industries. This will cure most of the vibrations on your table saw.

CLUB PURCHASE

The club has purchased a Book and Computer Program for the members use. If you can't remember where that article was or what magazine it was in, you can use the book in the

library, or call Don Richarson and he will look it up on his computer, he will also bring to the meeting his laptop computer and will do a search at the meeting.

Zatis Murphy has also purchased a program and has offered to take calls. If you call Zatis use his business phone as it is next to his computer, the number is [REDACTED].

CHARITY PROJECT

For this year it was decided that instead of trying to sell donated items we would find a Charity that we could help by making something, instead of donating money.

We have had a request from Boys and Girls Harbour for foot lockers about 70 of them. Right now it is in committee and as soon as all the particulars are worked out it will be presented to the members. If you would like to work on the committee or have any suggestions contact Bud.

SAFETY

By Zatis Murphy

RADIAL ARM SAW

When cutting on the radial arm saw besure to hold or clamp the wood against the fence. Keep your fingers out of the path of the saw cut. Besure that blade is sharp, the bearings and tracks are in good condition and you have good extension tables.

You can rip on a radial saw but it is not a very safe procedure.

POWER MITER SAW

Most the same safety procedures apply to using a Power miter saw, keep those fingers out of the path of the blade, make sure the blade is sharp, watch out for those small pieces do not get your fingers too close to the blade. Keep those safety guards in good working order.

Always use normal safety devices--safety glasses and ear protection.

When purchasing a saw blade remember that there are blades made for the table saw, blades made for the radial arm saw and blades made for the power miter saws.

PROBLEMS AND SOLUTIONS

Steve Pinn has had various problems with the Grizzley Bandsaw, he has replaced the guides with Carter ball bearing guides and has found that using bandsaw blades made by Suffolk Machinery of N. Y. to be very good. Suffolk also reminds all users of their blades to be careful not to over tension blades.

Another member wanted to know what was the best Biscuit machines to purchase. That's a hard question because there are so many good biscuit machines on the market that you have to decide what features you would use the most and compare that with the cost. Again the members themselves are a very good source, you can ask their opinion and also try their biscuit machine.

MAY FEATURE PROJECT

JIGS AND TOOLS YOU HAVE MADE

Chuck Maxwell showed us a couple of router circle cutters, one small and one very large for cutting rockers.

He also had a jig that he uses on his table saw for zero clearance when cutting laminate.

Chuck also brought along his jig for cutting various size circles on his bandsaw. If you ever have to cut circles this is the best jig around and is very easy to make, Chuck also had copies of the plans.

Bill Baker showed us a jig for cutting a straight edge on a board with no straight edges.

He also made a jig for cutting grooves to make a CD storage box.

Walt Turpening made a mortising jig to fit his Excaliber table saw fence.

SHOW AND TELL

Tom Gathright had two rocking horses, one made of Oak and Mesquite and one made of Pine.

Jimmie Harp showed us a Gun reloading bench that he made of Oak, Bowling Alley Maple and shelves made of MDF.

Denis Muras showed us a bulldozer with his newly designed tracks/rails.

Bill Baker made a tool cabinet out of maple flooring, plans are in Woodsmith.

Zatis Murphy turned letters openers using the same mandrel as for pens and pencils, he says the letter openers take about five minutes.

FOR SALE

Tuara wood from the Mahogany family: clear, knot free stock:

78 pieces of 1 x 6 x 6 foot 1 Lot---\$351.00
42 pieces of 1 x 8 x 6 foot 1 Lot---\$252.00
\$1.50 a board foot or .75 cent a linear ft for the 1 x 6 and \$1.00 a linear ft for the 1 x 8's.

330 plus board feet of Maple, full 1" thick x 4", not 3/4 x 3 1/2". Random length's longest 44" shortest 8". \$300.00

Original Strong Jointmatic with 1/2" Bosch Router includes stand with miter gauge and 45 degree miter gauge and instruction book. Steel and cast Aluminum not the new resin model. \$200.00

20" RBI Hawk Scroll saw on stand with removable Maple stool includes extra blade holders, 2 blade setting gauges and instruction manual. Original cost \$798.00 Selling \$450.00.

Beall Wood Threader, will cut 1/2", 3/4" and 1" inside and outside threads, includes dowel sizing plate. Never used still in original box. \$150.00.

Wagner Safe-T- Planer model DP-1 Never used still in original box. Absolutely safe-impossible to grab or kick back. Can be used on drill press or radial arm saw to cut rabbets, tenons, raised panels and picture frames. \$30.00

Freud Raised Panel Set #94-100 --Used once 1/2" shank 5 bits-- includes Door Lip Cutter, Glue Joint Cutter, Raised Door Panel Cutter, Stile Cutting Bit and Rail cutting Bit---\$125.00
Contact Sharon Buckley at 991-3860 for further information of any of the above items.

For Sale Shopsmith Biscuit Jointer, includes 1/2 sack of #10 and #20 biscuits. \$120.00 value Selling \$50.00 Contact Don Sloan 608-736-6666

For Sale Black Walnut well seasoned 130-150 years old, straight no knots. \$2.00 Board foot Contact Mike Turner 608-736-6666

JUNE MEETING

WHEN: JUNE 12, 1993 9:00 A. M.

WHERE: BAYLAND COMMUNITY CENTER
ON BISSONNET AT HILLCROFT

PROGRAM: The June program will be presented by Steve Procter on the construction of a Victorian playhouse. Steve will show us the special mouldings that he made, he will bring along photos, drawing, sample millwork and handouts.

If you would like to see his work first hand, Steve will host an open house from 12:00 noon to 3:00 PM. See the insert map for directions to Steve's house.

Pasadena Industrial Supply Delta Unisaw Special Edition

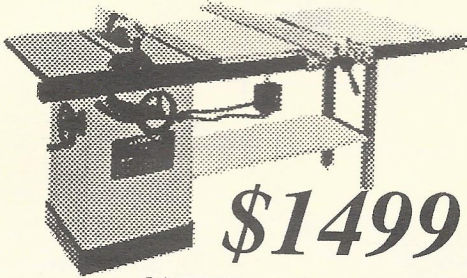

\$1499

LIMITED QUANTITY!! This special edition 3 hp unisaw is the same model we have been selling for year with a small difference, this version **does not** have the LVC control. 52" unifence is std equipment as is the motor cover and all the other quality items that make a Unisaw the most desired table saw in the U.S.

Delta #36-820 3hp unisaw 230v with 52" unifence
Table boards not included

222 West Pasadena Freeway, Pasadena Texas 77506 472-5588



5117 April Lane, Houston, Texas 77092
Hours: M-F 7:30-5:00 SAT 8:30-12:30
(713) 686-6176 Phone
(713) 686-3217 Fax

DOMESTIC & IMPORTED HARDWOODS

Ash, Basswood, Birch, Cedar, Cherry, Cypress, Mahogany, Maple, Red Oak, White Oak, Padouk, Poplar, Purpleheart, Redwood, Sycamore, Teak, Virola, White Pine, Walnut, and More.

High Quality Domestic & Imported
Plywoods, Softwoods, Hardwood Veneer
Edgebanding & Hardwood Veneers
Excellent Service & Competitive Prices!

ON SITE CUSTOM MILLING
TO YOUR SPECIFICATIONS,
S2S, S2S1E, S4S
(No order too large or too small)

10/93

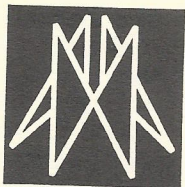
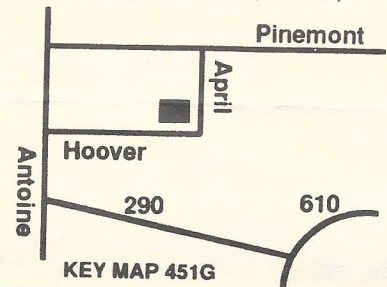

AUSTIN HARDWOODS

13001 VETERANS MEMORIAL DR.
HOUSTON, TEXAS 77014

440-0764

We stock over 80 species of lumber including rare exotics and turning stock. Plywood, Veneer, Moulding, Flooring, Tools, Millwork, Paneling Etc. also available

Exp. 2/93

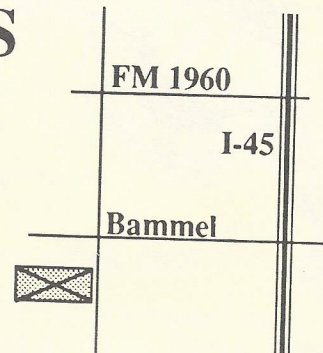

HARDWOOD LUMBER CO.

700 E. 51/2 St. (In The Heights)
 Houston, Texas 77007
 (713) 862-6628
 Hours: M-F 7:30-5:00, Sat. 8:30-1:30

We stock over 65 species of lumber including
 hard to find exotics!

Also: Plywood, Veneer, Moulding, Formica,
 Custom Milling, Woodworking Tools, Books, etc.

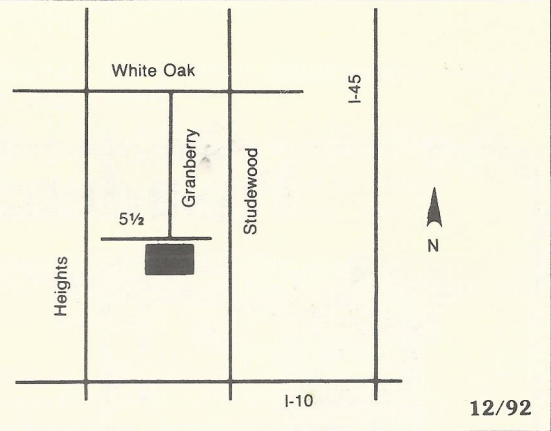

Send Today for the Most Complete Catalog Selection of Woodworking Supplies

Please Enclose \$1.00 (3rd class) or \$2.00 (1st class)

Name _____
 Address _____
 City _____ State _____ Zip _____

Orders Shipped Within 48 Hours

7193

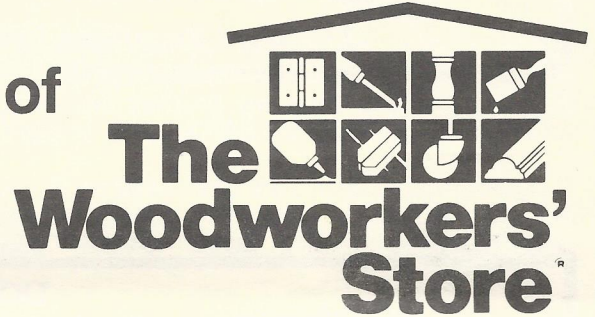

21801 Industrial Blvd., Rogers, MN 55374

PRINTED BY SPEEDY PRINTING SERVICE OF TEXAS 3433 WEST ALABAMA, SUITE C • HOUSTON, TEXAS 77027 • 713-877-8466

Woodworkers Club of Houston
 P.O. Box 34481
 Houston, Tx 77234

