

# Woodworkers Club

## OF HOUSTON

VOL. 8, NO. 6

JUNE, 1992

### Officers

Denis Muras - President 943-7745  
Jack Conry - Vice President 463-7352  
Bill Smith - Sec./Treasurer 695-3827  
Sharon Buckley - Newsletter Editor 944-6739

### Board of Directors

Ed Burger - 497-5718  
Joe Cook - 862-5623  
Zatis Murphy - 469-3563  
Don Sloan - 688-8986

### MAY MEETING

Perry Henderson was our guest speaker for May. He brought us up to date on some of his new designs. He makes models of the Worlds largest loader and dump truck.

Perry says that there is a very good market for working scale models. Companies and schools us them for training and safety.

The worlds largest truck has 12 foot tall tires, a 2000 HP engine, 900 gallon fuel tank and a 24 foot wide bed which holds 100 yards.

The worlds largest loader is 22 foot tall, 22 foot wide and 43 foot long, it uses 68 ply tires and cost a cool 2.3 million.

After the units are assembled at the factory they are field tested for two days, then they are disassembled, hauled to the sight on six trucks and reassembled.

Perry builds his models out of 1 x 12 grade C white pine, finished in Polyurethane. Hidden parts receive one to two coats with the rest receiving about 6 coats.

Perry also had a video tape demonstrating his radio controlled cherry picker.

Perry uses approximately 200 board feet of lumber, each wheel uses 11 board feet of lumber.

We would like to thank Perry for another interesting program.

### VIDEO TAPE LIBRARY

Remember when you borrow a video tape it is your responsibility to get that tape back to the next meeting. If you cannot attend the next meeting, mail it back to the clubs Post Office box or take it to another member who will be attending the next meeting. If you don't get it back on time you will be charged \$5.00 for each month that you keep the tape out. So lets all get those tapes back on time.

### BOOK LIBRARY

The same thing applies to the Book library except the fine is only a \$1.00 for each month.

### SAFETY

Last months newsletter had an article on Wood Dust and Zatis Murphy elaborated on how wood dust is measured. Osha uses TWA Time Weighted Average--Eight hours per day for Five days per week. From this they determine the permissible maximum allowable limit. Some woods are relatively non toxic while some are very toxic. For an example Cherry has a high degree of arsenic.

A lot has to do with particle size, large particles are not as dangerous as fine dust.

Each woodworker reacts differently to each type of wood, just be careful when working in your shop.

### CHARITY SHOW

Bill Hochmuth is working on a location and date for the Charity Show, its never to early to start on those projects.

### MAYS PROJECT OF THE MONTH

Mays project of the month was a toy no larger than 8 x 8 x 8.

Walter Turpening had a puzzle designed by a Danish Nuclear Physicist. Made up of 27 blocks that make 7 pieces.

Zatis Murphy made his first and last tractor. Zatis said that he learned one thing, that toys are not for him.

Leonard Elholm made the Fat Cat Series of trucks and tractors and a waddling duck, Leonard even turned the wheels. He finished his toys with a couple coats of brushed on Deft, then used steel wool to achieve a semi-gloss.

Don Sloan had a circa 1890 toy, a dancing bell boy, made from Poplar and finished in non toxic Rit Dye.

Don also thanked the club for the Get well Card that the club sent him.

---

## PROJECT OF THE MONTH FOR JUNE

The project for the month for June is varied and wide open, with the only restriction being that the project must be made with no more than 8 board feet of lumber, 1 x 12 x 8-0.

You are free to make furniture, toys, household items or items for your shop, as long as the amount of wood in your project does not exceed 8 board feet of lumber.

We have had good participation in this new feature and we would like to see all the members ideas and what they are interested in. This is not a competition just a sharing among the members and a chance to get to know the members better.

## SHOW AND TELL

Bill Smith made a decorative bird house, Bill built the bird house and his wife did the painting.

Chuck Maxwell demonstrated some Wooden Hand Screws that he made from plans out of Popular Woodworking and Woodworkers Journal, complete with threaded wood screws.

Chuck also had some snap shots from the Field Trip we took.

Don Sloan gave us a lesson on how to use Wood Screw Clamps correctly. If you are right handed hold the top screw in your right hand, if you are left handed hold the top screw in your left hand, and the jaws will stay parallel.

Bruce DeHart made a Cherry Stake Truck finished in Watco.

Tom Gathright made a childs desk and stool for his granddaughter. The desk was made out of Oak with Purple Heart Accents.

## MAY FIELD TRIP

In May, 24 members and wives drove to New Ulm to Barbara Cearley's for a demonstration on Intarsia.

She gave us a tour of her shop in the Hill Country and demonstrated how she does the art of Intarsia.

We would like to Thank Barbara for her hospitality and for sharing her talent with us.

## FOR SALE OR WANT TO BUY

FOR SALE OR TRADE--Delta "Turret" 12 inch Radial arm saw with extra carbide blade(\$100 value). This is a powerful professional tool that is frankly too much for me. Sale price is \$750 cash but I would much rather trade for a high quality table saw (Delta contractors saw w/unifence or better), or what have you. I need a good 1/2" router, disk/belt sander, and am always interested in quality power tools to replace the starter stuff I have so much of. The saw can be seen in Bellaire near our meeting sight. Contact George Pierce, work phone 527-6060--home phone 669-9060.

---

**FOR SALE --Craftsman 6 1/8" Jointer on stand  
with casters--used very little--\$225.00. RBl  
Hawk 20" Scroll on stand with attached Maple  
stool, Scroll saw includes extra blade holders  
and blade setting jigs--\$500.00 contact  
Sharon Buckley--99 1-3860.**

## **SAFETY**

By Zatis Murphy

Jointers are considered by some to be among the safer stationary power tools. However, the potential for injury still exists.

Resharpener the knives frequently to maintain the best cutting capability; dull knives may chew up the stock. Check the stock for nails, screws, staples, etc., BEFORE milling the stock. Never try to surface short stock on a jointer. A good rule of thumb (pun intended) is to use a hand plane for stock less than 12 inches long. The leading edge of short stock may catch on the cutters, with your fingertips following.

Be sure that all adjustable parts of the jointer are locked tight and use the safety guard when possible. As with other rotating power tools, be sure to wear safety glasses and avoid loose--fitting clothes which may be pulled into the cutters.

Keep your finger away from the cutters. Never let your fingers hang over the end of a board. Use push blocks when surfacing or jointing thin stock; a grout spreader having a soft rubber pad works well for this. Always stand to the left of the machine. (Sorry lefties, but like many other tools, jointers were designed by right-handed folks!)

Joint with the grain whenever possible. Be very careful if you try to plane the end grain of stock; the stock should be at least 10 inches wide. Use a shooting board and a hand plane on end grain of narrower stock.

Avoid distractions, give the machine all your attention and think before you cut!

## **JUNE MEETING**

**WHEN:** JUNE 13, 1992

**WHERE:** BAYLAND COMMUNITY CENTER  
ON BISSONNET AT HILLCROFT

# Pasadena Industrial Supply

222 West 225 Freeway, Pasadena Texas 77506 472-5588

Introducing the *NEW*  
Porter-Cable *QUICKSAND*  
Random Orbit Finishing Sander

Also ask us about the 5" Velcro model with dust collection

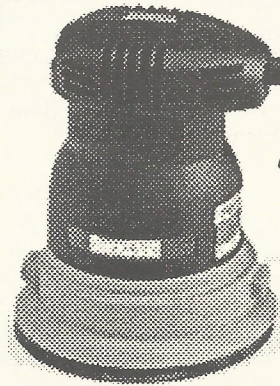

**PORTER-CABLE**  
PROFESSIONAL POWER TOOLS

**\$65** PC# 332

Designed for finish sanding, this tool delivers 12,000 OPM for faster, smoother & swirl free finishing. Uses 5" PSA sanding discs for quick economical grit changes

## Hardwood Lumber Co. Lawndale Division Imported and Domestic

Quality  
Hardwoods - Softwoods - Plywoods  
Mouldings & Squares

A COMPLETE SELECTION OF FINISHING SUPPLIES.

Marine Plywood  
Parana Pine  
Teak

Honduran Mahogany  
Exotic Hardwoods  
Domestic Hardwoods

WALNUT - BIRCH - ASH - CHERRY  
CYPRESS - RED AND WHITE OAK

AND OTHERS

MON. - FRI. 7:30 TO 4:30

SAT. 8:00 TO 1:00

5401 Lawndale  
(713) 921-6131

12/92

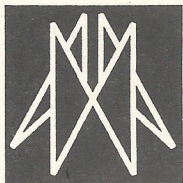

## AUSTIN HARDWOODS

13001 VETERANS MEMORIAL DR.  
HOUSTON, TEXAS 77014

**440-0764**

We stock over 80 species of lumber including rare exotics and turning stock. Plywood, Veneer, Moulding, Flooring, Tools, Millwork, Paneling Etc. also available

Exp. 2/93

FM 1960

I-45

Bammel



# HARDWOOD LUMBER CO.

700 E. 51/2 St. (In The Heights)  
Houston, Texas 77007  
(713) 862-6628  
Hours: M-F 7:30-5:00, Sat. 8:30-1:30

We stock over 65 species of lumber including hard to find exotics!

**Also:** Plywood, Veneer, Moulding, Formica, Custom Milling, Woodworking Tools, Books, etc.

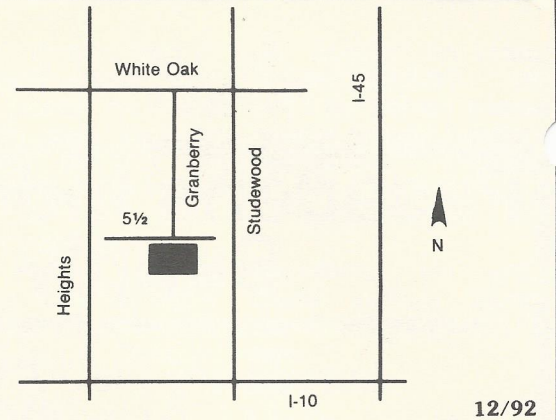

## Send Today for the Most Complete Catalog Selection of Woodworking Supplies

Please Enclose \$1.00 (3rd class) or \$2.00 (1st class)

Name \_\_\_\_\_  
Address \_\_\_\_\_  
City \_\_\_\_\_ State \_\_\_\_\_ Zip \_\_\_\_\_

Orders Shipped Within 48 Hours

7/92

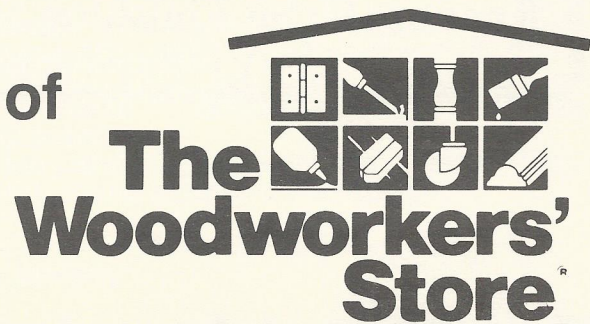

21801 Industrial Blvd., Rogers, MN 55374

PRINTED BY SPEEDY PRINTING SERVICE OF TEXAS 3727 W. ALABAMA, HOUSTON, TX. 77027 (713) 877-8466



5117 April Lane, Houston, Texas 77092  
Hours: M-F 7:30-5:00 SAT 8:30-12:30  
(713) 686-6176 Phone  
(713) 686-3217 Fax

### DOMESTIC & IMPORTED HARDWOODS

Ash, Basswood, Birch, Cedar, Cherry, Cypress, Mahogany, Maple, Red Oak, White Oak, Padouk, Poplar, Purpleheart, Redwood, Sycamore, Teak, Virola, White Pine, Walnut, and More. 1992

High Quality Domestic & Imported Plywoods, Softwoods, Hardwood Veneer Edgbanding & Hardwood Veneers  
**Excellent Service & Competitive Prices!**

ON SITE CUSTOM MILLING TO YOUR SPECIFICATIONS, S2S, S2S1E, S4S  
(No order too large or too small)

10/92

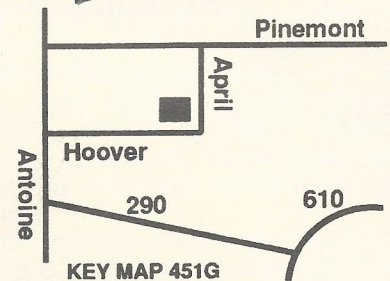

Woodworkers Club of Houston  
P.O. Box 34481  
Houston, Tx 77234

