

Woodworkers Club OF HOUSTON

VOL. 8, NO. 7

JULY, 1992

Officers

Denis Muras - President 943-7745
Jack Conry - Vice President 463-7352
Bill Smith - Sec./Treasurer 695-3827
Sharon Buckley - Newsletter Editor 944-6739

Board of Directors

Ed Burger - 497-5718
Joe Cook - 862-5623
Zatis Murphy - 469-3563
Don Sloan - 688-8986

JUNE MEETING

The June program was presented by one of our members Jack Eidman. Jack wanted a boat that could run full throttle all day long in 4 inches of water. This boat is used in salt water for fishing and floundering.

So in 1978 he built his first Scooter boat. The Scooter has a sled type nosing not pointed, because a pointed nose causes a boat to raise up out of the water.

This boat is designed for shallow water mainly and does not do well in deep water. Running in that shallow of water, you punch a lot of holes in it, from oyster reefs, etc. So the boat is built with air tight compartments that make it unsinkable.

The Scooter is 6 foot wide by 17-4 foot long, this not only fits in a garage but can be flipped over inside a garage.

The boat is built upside down and then flipped over.

The framework starts out with 1x10x16-0 foot pine. After the framework is built a skin of 1/8" marine plywood is applied to the bottom and 3/8" marine plywood is applied to the deck.

Jack said his main tools are a 7" wide belt sander and power screwdriver. He uses brass ring shank nails, brass screws and plastic resin glue for fasteners.

From start to finish it takes about 3 months to complete.

On his first boat he built a cone shaped tunnel, which was difficult to build and did not work as well as the rectangular tunnel that he built for his second boat.

Jack covers all surfaces with epoxy resins because it is waterproof, not caustic, does not smell and looks like varnish. The only problem he has found with the epoxy resin is that cracks appear at the wood joints--he believes that because the epoxy adheres so well that when the wood shifts because of the sun the epoxy cracks.

Jack estimates that his second boat costs

him about \$2,000 with \$1000 in epoxy--he also saved the hardware from his first boat.

Thanks Jack for an interesting program.

CHARITY SHOW AND SALE

Well we have a date and location for this years charity sale. The date is October 23 and 24, that's Friday and Saturday at the Greenspoint Mall.

Now we need lots and lots of items for the sale. We can sell almost anything from the itty-bitty to the very large. So lets start making lots and lots of sawdust and projects.

TELEPHONE COMMITTEE

Guy Meaders is chairman again this year and asked for about 20 members to help him --if you would like to be on this committee--get in touch with Guy.

SAFETY -----Open forum

When cutting a bevel on a table saw it was recommended that you not complete the cut---this was after a member had table saw kick back. The table saw slung his beveled cut 70-0 through an open door.

Always use your push sticks and your head before and during a cut.

PROBLEMS AND SOLUTIONS

Denis wondered if anybody had a Porter Cable 690 router that gets very hot while idling. It was suggested that he check the carbon brushes.

One of the members asked if anybody had any experience with the New Ryobi table saw. One of the members has one but would not recommend it.

A member was looking for a bandsaw mill, one suggestion was marine lumber off McCarty. We also had member looking for a place to get Brass or Bronze castings--some suggestions were the Art Foundation, Shipping

and industrial repairs, there is a foundry doing the lost wax casting in an industrial park in Sugarland.

BUY AND SELL

Shop built 12" Thickness/Surfacing Sander, no motor, \$65.00 contact Jacob Schulzinger at 776-9063.

JUNE'S MONTHLY PROJECT

Any project made from 12 board feet of lumber.

Bill Smith made a Folding stool out of pine.

Jack Conry made a wall mounted slatted magazine rack from pine.

Bob Gallant made a bird house from plans out of Weekend Projects magazine.

JULY'S MONTHLY PROJECT

This month's project is any item associated with the kitchen--such as step stool, spice rack, spoons, or any item from the kitchen.

SHOW AND TELL

Bill Hochmuth made an old fashion adjustable candle stand lamp--no candle just good old electric bulbs. Plans from Woodworkers Journal Mar/April.

Robert Sandlin made a Victorian gingerbread scroll saw plant hanger and two clocks.

Leonard Elkhorn made an 18 wheeler truck cab, plans in Dec. 1986 Fine Woodworking.

HARD TO FIND WOODS ?

We want to pick the members brains for hard to find woods--like long leaf pine, Cypress and Woods for musical instruments. If you have some of these sources please bring us the name, address, phone and their speciality.

Maybe you know of some local saw mills--of course local saw mills in Texas can be next door or 100 miles next door.

LET'S ALL SHARE OUR SOURCES !

Pasadena Industrial Supply

222 West 225 Freeway, Pasadena Texas 77506 472-5588

Introducing the *NEW*
Porter-Cable *QUICKSAND*
Random Orbit Finishing Sander

Also ask us about the 5" Velcro model with dust collection

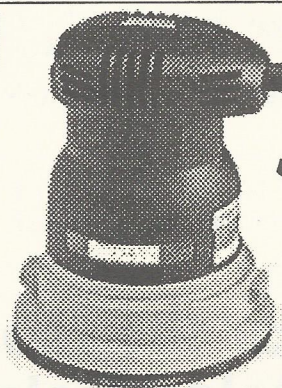

PORTER-CABLE
PROFESSIONAL POWER TOOLS

\$65 PC# 332

Designed for finish sanding, this tool delivers 12,000 OPM for faster, smoother & swirl free finishing. Uses 5" PSA sanding discs for quick economical grit changes

Hardwood Lumber Co. Lawndale Division Imported and Domestic

Marine Plywood
Parana Pine
Teak

Honduran Mahogany
Exotic Hardwoods
Domestic Hardwoods

WALNUT - BIRCH - ASH - CHERRY

CYPRESS - RED AND WHITE OAK

AND OTHERS

MON. - FRI. 7:30 TO 4:30

SAT. 8:00 TO 1:00

Quality
Hardwoods - Softwoods - Plywoods
Mouldings & Squares

5401 Lawndale
(713) 921-6131

A COMPLETE SELECTION OF FINISHING SUPPLIES.

12/92

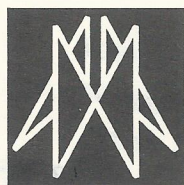

AUSTIN HARDWOODS

13001 VETERANS MEMORIAL DR.
HOUSTON, TEXAS 77014

440-0764

We stock over 80 species of lumber including rare exotics and turning stock. Plywood, Veneer, Moulding, Flooring, Tools, Millwork, Paneling Etc. also available

Exp. 2/93

FM 1960

I-45

Bammel



HARDWOOD LUMBER CO.

700 E. 51/2 St. (In The Heights)
Houston, Texas 77007
(713) 862-6628
Hours: M-F 7:30-5:00, Sat. 8:30-1:30

We stock over 65 species of lumber including hard to find exotics!

Also: Plywood, Veneer, Moulding, Formica, Custom Milling, Woodworking Tools, Books, etc.

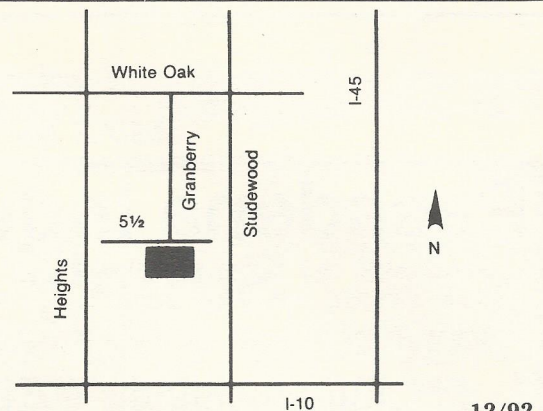

Send Today for the Most Complete Catalog Selection of Woodworking Supplies

Please Enclose \$1.00 (3rd class) or \$2.00 (1st class)

Name _____
Address _____
City _____ State _____ Zip _____

Orders Shipped Within 48 Hours

7/92

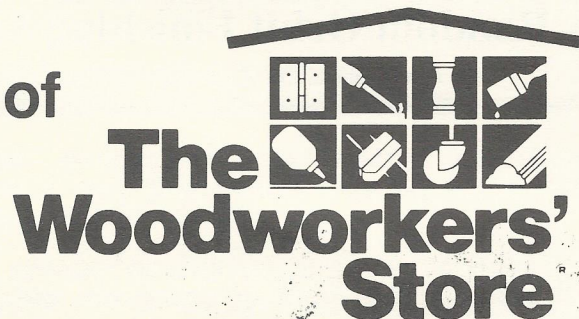

21801 Industrial Blvd., Rogers, MN 55374

PRINTED BY SPEEDY PRINTING SERVICE OF TEXAS 3727 W. ALABAMA, HOUSTON, TX. 77027 (713) 877-8466



5117 April Lane, Houston, Texas 77092
Hours: M-F 7:30-5:00 SAT 8:30-12:30
(713) 686-6176 Phone
(713) 686-3217 Fax

DOMESTIC & IMPORTED HARDWOODS

Ash, Basswood, Birch, Cedar, Cherry, Cypress, Mahogany, Maple, Red Oak, White Oak, Padouk, Poplar, Purpleheart, Redwood, Sycamore, Teak, Virola, White Pine, Walnut, and More.

High Quality Domestic & Imported Plywoods, Softwoods, Hardwood Veneer Edgbanding & Hardwood Veneers
Excellent Service & Competitive Prices!

ON SITE CUSTOM MILLING TO YOUR SPECIFICATIONS, S2S, S2S1E, S4S
(No order too large or too small) 10/92

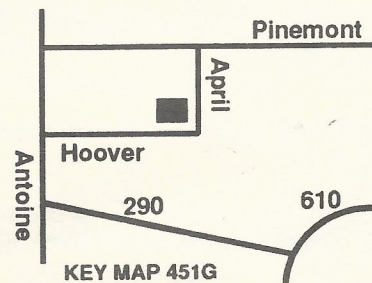

Woodworkers Club of Houston
P.O. Box 34481
Houston, Tx 77234

