

# December Meeting

## New business

The book library is being cleaned out and old out of date books were offered to the membership at the meeting.

The monthly raffle proceeds and book/video fines have given us a nice account balance for new videos and books. Now is the time to suggest woodworking tapes and books you would like to view and read but may not be able to afford.

## Problems and Solutions

Wanted - Heavy duty fold down stairs. It is desired that they have double railings that are strong enough to help balance the user as loads are moved up and down.

## Show and Tell

JessePitts Maple Cradle - the multitude of turned spindles were done using the duplicator on his lathe. The carbide cutter left a rough surface so the final surface was sanded and 4 coats of Bartley's Clear Gel applied. Nice work, Jesse.

Don Sloan Lacewood Shell Box - the original was smaller and were scaled up to the about 8 inch size.

Chuck Maxwell Drum Sander Box - the original design is from the December Woodsmith. The table as a cube insert that has holes for the different drum diameters and a hook up for your dust collector.  
Multi-Hole Jig - from the December Wood Magazine.

Ron Schmitt Texas Game Board - the Texas outline and different icons were routed using a pantograph. It was donated to the Charity program.

## Raffle Winners-

Forstner Bits Set - Clara Pitts  
Marking Guage - Lee Palfreyman  
Rosewood Try Square - Denis Muras

## Program

Houston Lighting and Power - Shop Electrical Systems

- 1) The first and foremost consideration in the shop is GROUNDING. Be sure that the third pin is truly ground on all recepticals. Also be certain that the polarity of all the recepticals is proper. (Denis Muras has a proper Receptical Tester.)
- 2) INSPECT all of the power and extension cords for insulation breaks. If you need to use your tools outside, use outdoor rated cords. Also be sure to use heavy enough guage conductors.
- 3) Keep your tools in good condition to prevent overloading due to binding shafts, etc.

## Fire Hazards

Induction motors draw low current when spinning free but draw much higher current under load. Assuming a 110 volt motor, if the wiring in the shop is less than 12 ga there could be significant heat build up during prolonged continous use. Also if light guage wire is used the tool may not perform as it should and damage the tool. For 100 feet of 16 ga wire there is a 10% decrease in voltage at the tool, a 10% increase in current load, which translates into a 12% increase in temperature and a 20% decrease in torque.

For a professional shop with 220 volt wiring have a Professional Electrician do the wiring to code. HL&P has Power Consultants to evaluate your needs. Contact you local Service Center. Contact the Houston Electrical League for local Professional Electrician.

**WHEN IN DOUBT DON'T.**

## New Members and Changes

### Change

Michael J. Drez  
13005 King Circle  
Cypress, Texas 77429

### New Members

William & Dee Rhea  
10706 Bayou Glen  
Houston, Texas 77042  
(713) 266-9412

Johanna & Joanne Johanson  
5255 Birdwood  
Houston, Texas 77096  
(713) 668-1327  
(713) 744-6356

Volume 12, Number 1 January, 1996

**Woodworkers Club of Houston**

**Membership Renewal!**

**Help A Child...**  
a message from Saul Harris

Every year we spend hours in our shops making toys and other gifts as part of our annual Christmas charity project. What about the rest of the year?

Here is a way we can help youngsters and adults alike learn to work with wood and help a worthwhile charity at the same time.

Big Brothers and Big Sisters of Houston has asked us to help them help a child. At the December WwCH board meeting, we discussed with a Big Brothers and Big Sisters board member the idea of our members mentoring young boys and girls and their adult counterparts to accomplish some special goals:

- to share our knowledge and experience with children and other adults interested in woodworking.
- to provide additional opportunities for the Little Brothers and Sisters to learn from adults in a positive learning environment
- to learn how to safely practice the art of woodworking
- to allow the kids to use their new-found skills in creating small craft items to generate badly-needed funds which will enable the Big Brothers and Big Sisters of Houston organization to better assist additional youngsters year-round.

Several ideas were presented to accomplish these goals. One of the better ideas is to have a club member host a youngster and his/her adult counterpart in their shop working on toys, boxes, picture frames, etc. Building small, simple pieces will allow these youngsters to learn the basics first and move forward from there. Very little, if any, expense will be required on the member's part.

The board agreed that this could be a worthwhile, year-round program that will allow us as woodworkers to teach others our craft and to help a child and a worthy organization all at the same time.

Contact me or another board member to help out.

**For Sale**

Vintage 4" Delta Jointer with motor and stand  
Best Offer

Contact: Dean Hemphill

Delta Unisaw; 3hp, 1 phase, 220 volt, w/ Jet Lock Fence  
Like New- \$1100

Contact: Jim Rude 422-5569

Craftsman 10" Table Saw; belt drive with Accessories  
\$225

Contact: Scotty 723-4648

**Woodworkers Club of Houston**  
**Treasurer's Report**  
**Summary of Income and Expense**  
**December 31, 1995**

Bank Balance January 1, 1995		3222.53
<u>Income</u>		
Dues	3536.00	
Raffle	1066.00	
Advertising	800.00	
Fines	216.00	
Hat Sales	397.50	
BBQ net	20.50	
Other	76.61	6112.61
	Sub-total	9346.14
<u>Expenses</u>		
Printing	2546.31	
Postage (net)	606.12	
Bank Charges	108.28	
Hat Purchases	552.08	
Videos and door prizes	754.04	
Post office box	58.00	
Funeral flowers (Reed)	54.13	
Other	58.90	4737.86
	Sub-total	4608.28
Add: Petty Cash		50.00
	Total Cash	4658.28

**Board Meeting**

**December 9, 1995 at Luby's Cafeteria**

The membership form is being expanded to include areas of interest like furniture, cabinetry, marquetry, faceplate/spindle turning, chairs, reproduction furniture, sculpture/carving, architectural, toys, jigs, etc..

Being added in the February issue of the newsletter will be a Questions, Tips & Tidbits section, where the membership supplies the answers to some of our problems. A volunteer is needed to take on the writing of the section. Initially, it is seen as writing up the Problems & Solutions brought up at each meeting. If there is no solution given at the meeting for a problem, then search out a solution and report it in the newsletter. (I will help get the article into the final form, but I need the help doing the research and basic writing. - ed) Let Saul or Walt know at the January Meeting.

As new additions are made to the Book and Video library each month they will be listed in the newsletter.

On the Libraries, send in your suggestions to Martin Imber and Denis Muras so that we can spend the available funds to help with your needs.

## January Meeting

**Place:** Bayland Park Community Center,  
Bissonett at Hillcroft  
**Date:** Saturday January 13, 1996 at 9:00 AM  
**Program:** Japanese Tools by Steve LeGrue  
**Ke: Ae:** Items provided by Woodcraft Supply

### From the Editor's Bench

In athletics, a training philosophy is to crosstrain in other sports, to become better in your sport.

When we can hear from other craftspeople concerning their craft we should listen and see if we can learn something to apply to our own craft. To this end I have included the following article written by a prominent weaving artist in Texas.

Ask the question, "Woodworking — Art or Craft?"

---

### Weaving — Art or Craft?

by Mabel E. Maxey

from Contemporary Handweavers of Texas, Inc.  
volume 47, Number 2, December 1995

I believe it will be helpful to begin this article with two important words— "art" and "talent." I hesitate to mention the word "art," probably because so often the first response of weavers is to draw back and say "that leaves me out. I am no artist." What do weavers consider themselves? Artists? Craftspeople? Certainly good craftspeople are to be treasured, but that does not exclude them from being artists.

Expert weavers are expected to be masters of their craft. Infact it is often the struggle of a lifetime to become a master craftsman, but craftspeople become artists when they manipulate equipment and use special talents with fibers, colors, equipment and other materials to produce exquisite art objects.

Neither craft nor talent excels without the other. Technique alone is lifeless. Good technique makes the end product more than just another piece of handwoven material.

Individuals with special abilities or who are endowed with a particular natural talent or aptitude of mind and spirit are often referred to as artists. Such persons should allow themselves the freedom to exercise their talents and certainly should never underestimate themselves because in their own minds they do not measure up to the geniuses of the world.

In considering talent and art, the former can be the first to appear as a natural response to normal situations. On the other hand, a person could be timid or retiring and hesitate to assert him/herself. In fact, it is not unusual for an observing third person such as a teacher or a parent to be first to be come aware of a special talent. Such a person with talent could be a weaver who at first is overly concerned with acquiring a knowledge of the mechanics of the loom.

for that reason, it is an advantage if the first venture into weaving requires the opportunity to make choices. This could reveal a person's natural inclinations to such things as color, texture, fibers in general, and other inherent factors that are a part of the weaving process. In this way natural inclinations, talents, become evident and can be come an innate part of the whole process.

To completely separate technique from the process of creating from the very beginning is not natural. For a person to choose a warp and place the fibers side by side to visualize the colors as a potential fabric can be revelation to the person's independent thinking. A feeling for colors and textures in many ways reveals hidden talents. This discovery of natural talents is the unleashing of the creative spark and leads eventually to art expression. A talent is too precious to be left dormant.

Talented individuals may or may not be come to the attention of somebody who recognizes latent talents and gives necessary encouragement. How are weavers to know what their capabilities are unless given the opportunity to try?

As we begin a new two-year period of activity in CHT, it might be stimulating and interesting to be a little adventurous. Perhaps an appropriate question to ponder is: Is your weaving art or craft?

---

## February Newsletter Deadline January 29, 1996

---

### Officers

President	Saul Harris	341-5373
Vice President	Charles Sylvester	774-6551
Sec'y/Treas.	Clara Pitts	694-7195

### Services

Book Library	Martin Imber	292-1606
Video Library	Denis Muras	943-7745
Literature Search	Don Richardson	661-1365
Name Tags	Zadis Murphy	469-3563

### Directors

Andy Anderson	730-1030
Art Chester	469-1990
By Reed	980-9793
Don Richardson	661-1365

Newsletter Editor - Walt Turpening, 879-5640

Newsletter Distribution - Thad Brown,

## HARDWOOD LUMBER CO.

700 E. 51/2 St. (In The Heights)  
Houston, Texas 77007  
(713) 862-6628  
Hours: M-F 7:30-5:00, Sat. 8:30-1:30

We stock over 65 species of lumber including  
hard to find exotics!

*Also: Plywood, Veneer, Moulding, Formica,  
Custom Milling, Woodworking Tools, Books, etc.*

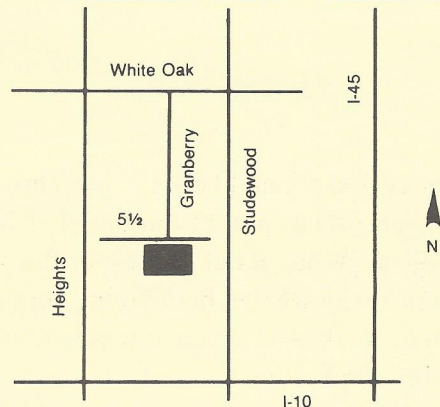

### The Lowest Prices On JET Machinery Every Day!

King Waterstones 1000# : \$18.95 6000# : \$21.95

Lie-Nielson Planes: #1: \$155 • #2: \$195

EXCEL Polyurethane Glue 250ml : \$7.49

Incra 16" Ultra Jig System: \$239

JET Open Stand Band Saw: \$455 after rebate

Record 52 1/2 ED Bench Vise : \$129

We are an Authorized JET Service Center.

7123 SouthWest Fwy, Just North of Bellaire Blvd. (713) 981-9228

The  
**CUTTING** **EDGE**, Inc.  
A Woodworker's Tool & Supply  
Mon. - Fri. 9 am to 6 pm  
Sat. 10 am to 5 pm  
Sun. Noon to 4 pm

## WwCH Membership

To Join the Woodworkers Club of Houston for 1995, bring this form to a regular meeting or send your dues to:  
WOODWORKERS CLUB OF HOUSTON, P.O. BOX 34481, HOUSTON, TEXAS 77234

Make checks payable to Woodworkers Club of Houston.

Renewal Membership \$24.00

New Membership is prorated if 1st year is less than 1 year.



**686-6176**

FAX: 686-3217

4910 West 34th St, Houston, Texas 77092

Hours: M-F 7:30-5:00 SAT 8:30-12:30

## DOMESTIC & IMPORTED HARDWOODS

Ash, Aspen, Basswood, Birch, Aromatic Cedar, Cherry, Cypress, Lacewood, Mahogany, Maple, Oak, Padouk, Pecan, Poplar, Purpleheart, Redwood, Sycamore, Teak, Walnut and more.

- \*Quality Domestic & Imported Plywood (Interior & Marine)
- \*Edgebanding & Veneer
- \*Butcher Block Tops
- \*MDF & Melamine
- \*Moulding
- \*PERSONAL SERVICE
- \*PROMPT DELIVERY
- \*ON-SITE CUSTOM MILLING

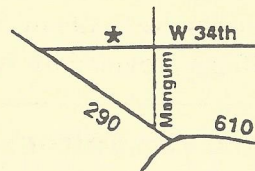

**Call 1-800-403-9736 Today!**



**FREE!  
CATALOG**

*You'll find over 4,500  
woodworking products —  
including many exclusive  
and hard-to-find items!*

*Filled with hardware, wood,  
tools and know how from cover to cover.  
Call for your FREE catalog today!*

Rockler Companies Inc.

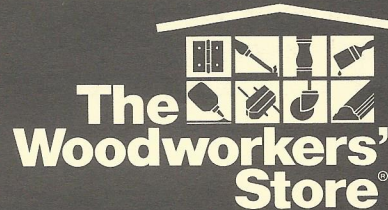

*Hardware, Wood, Tools & Know How*



# WOODCRAFT® Your Most Complete Woodworking Store!

Hand & Power Tools  
Sanding & Scraping  
Planes  
Cabinet Making Supplies

Carving Tools & Chisels  
Wood Boring Tools  
Woodburning  
Woodturning

Hardware  
Finishing Supplies  
Safety Equipment  
Sharpening Supplies

Routers & Accessories  
Hardwoods & Exotics  
Marking & Measuring  
Power Tool Accessories  
Files & Rasps

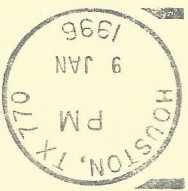

**Woodworkers Club of Houston**  
**P. O. Box 34481**  
**Houston, TX 77234**

Printed by: *Speedy Printing Service of Texas* 3433 West Alabama, Suite C • Houston, Texas • (713) 877-8466

**Happy New Year!**  
**Therefore, it is WwCH Membership Renewal Time!**  
**The membership form is included on the insert!**