

Woodworkers Club OF HOUSTON

VOL. 8, NO. 1

JANUARY, 1992

Officers

Denis Muras - President 943-7745
Jack Conry - Vice President 463-7352
Bill Smith - Sec./Treasurer 695-3827
Sharon Buckley - 944-6739

Board of Directors

Ed Burger - 497-5718
Joe Cook - 862-5623
Zatis Murphy - 469-3563
Don Sloan - 688-8986

DECEMBER MEETING

The December program was a question and answer program on finishing. We all seem to have problems when we get to the finishing stage of a project. Susan Neptune of Neptune Restorations fielded all the questions from the members and was very enlightening with her answers. Susan's background in finishing began while she was growing up in Europe, spending her free time hanging around finishers. She didn't go directly into finishing but took a short detour into the securities business. Realizing that her heart was really into finishing and restorations, she has since spent the last 15 to 17 years doing just that.

One of the questions was which woods were the easiest to finish--her answer was that all woods are just as easy they just all require different techniques.

In her business she uses lacquers and shellacs (old tried and true) because varnishes take just to long to dry.

Polyurethanes make the wood look like glass, they expand but will badly scratch.

When using water based stains prepare the wood with a wipe down of water, then flood the surface with stain, wipe off excess and sand with 320 grit sand paper. Remember water based stains will not go over any type of oil based product.

For a variety of color to woods you can use dyes. Most dyes mix with alcohol and apply with a rag. Japan colors are more translucent, because they are ground very fine--do not use mineral spirits.

When preparing woods for stains do not over sand the wood --if you get it to smooth it will not accept the stain. Susan recomends no finer than 150 grit .

If you are not going to apply a stain then you can use a 400 to 600 grit sand paper because this becomes part of the finish.

Susan says that all paste waxes are not the same. Some waxes are heavy for furniture that will take lots of abuse and some waxes

are light weight for light duty. Some of those antique pieces that look like they have 300 coats of wax are actually a two part finish. Most English and French waxes area very heavy two part system. Brush on two coats and wait 6 to 8 hours and then buff.

To cover up blemishes in the finish you can use touch up powder and touch up your mistakes.

For end grain dilute shellac or varnish and apply to the end grain before you stain.

Our eyes are trained to see the periphery of an object because as furniture ages it darkens around the edges which makes it look softer.

If you have a small divot in a piece of furniture you can use a childs crayon and burn it in.

In her business they try to maintain the original finish, to maintain the quality.

But sometimes they must strip a piece of furniture, she recommends Jack Goddard Stripper, they have a factory in Bellville. The strippers available to professionals have 87 percent active ingredient, but the ones available at the home hardware centers have only 12 percent active ingredient. The manufactures of strippers also make one formula for summer and one for winter--and you never know if the one you purchased in summer was formulated for winter, so if it does not work return it to the store.

If your looking for any of these waxes, finishes, hardware or caning supplies, Susan has a retail store that can help you out. Its called The Settlers at 1437 West Alabama behind the Menil Museum, phone 524-2417.

Susan answered everyones questions and has invited us to visit Neptune Restorations for some demonstrations. In the next month or two we will arrange a field trip.

We want to Thank Susan Neptune for allowing us to pick her brain and sharing with the members her expertise in the finishing business.

DECEMBER DINNER AND SHOW AND TELL

This years dinner and get together was a success. But we would like to get better participation from the membership this year. First we are looking at a new place to meet where we might have a buffet and we would also like to know if more members would attend if we changed the date to another time of year when not so much is going on. Just think about it for now and Denis will be polling the membership to find out just what you would like to have.

PRESENTATION OF CHARITY SHOW MONIES

We will donate the monies from our charity show to a representative from the Make a Wish Foundation at the January meeting.

SAFETY

Don Sloan stressed that we pay more attention to those splinters that we all get, not only from wood but sheet rock screws and fiberglass, etc. There was a discussion as to how often you should get a Tetanus shot. So if your in doubt consult with your family Doctor.

Tom Gathright told of an incident he had with an insert that he made for his table saw. The Blade lifted the insert out of the table and threw it across the room. When you make an insert for the table saw place a screw in the back of the insert and cut off the head, this should keep the insert in the table saw top. Always remember not to stand directly in front of the blade but to one side for safety.

SAFETY CO-CHAIRMAN-- Murray Gordon the safety chairman needs a co-chairman because Murray's job takes him out of town alot and he can't avoid missing meetings. When Murray is out of town the co-chairman would present the safety program for that month. If you would like to help, contact Murray or talk to Denis.

BOARD OF DIRECTOR

Leo Orinderff announced that he would be unable to serve as a Board of Director for the coming year. The members voted in Don Sloan as a Board of Director, thanks Don for serving.

SHOW AND TELL

Bill Baker showed us a jewelry box that he made out of Oak and finished with Watco. He made the top with a panel effect so the edges would be thin.

Tom Gathright made a Domino box out of Padouk and Rosewood.

WOODWORKER VOLUNTEER NEEDED

Lewid Fernandez's mother Julie Alsup at 697-9861 is a physical therapist with Harris County. There is a special little boy, 16 months old that will only be able to crawl that needs a special step stool that will allow him to climb up to counter tops. If you would like to help or if you have any ideas contact Julie at the above

phone number.

A MEMBERS PASSING

Bill Sallans a long time and very active member of the Woodworkers club has passed away. Bill handled the advertising for the charity sale and sold advertising in the newsletter. We will all miss a good friend.

WORKSHOPS AND CLINICS

It was suggested that we plan a large project workshop for 1992. If you have any suggestions or maybe be able to host a workshop please contact Stuart Murphy.

Stuart is always looking for members to host a clinic--remember you don't have to be any expert--just good at whatever clinic you host.

What type of clinics would you like to attend and Stuart will try to find a member to host a clinic.

ADVERTISERS

We would like to thank all of our advertisers for supporting the club in 1991 and for continuing in 1992.

Remember they support us and we must support them--so when your looking for that great piece of wood or that new piece of equipment or those accessories that we all can't do without --check first with our advertisers before anyone else.

WOODWORLD SHOW

The Woodworld show has granted us another booth for there show at the Pasadena Convention Center Friday March 6, Saturday March 7 and Sunday March 8. We will need items to display at the booth and members to man the booth. We will be signing up members at the February Meeting so that we can get badges made up. We would like to have lots of display items to really show off our club.

MEMBERSHIP DUES ARE DUE NOW

Membership dues are now due--the deadline is January 31, 1992. We will have new badges at the March meeting for all paid up members and if you don't pay you will not receive the monthly newsletter.

If you have any changes now is the time to speak up or lose out.

JANUARY MEETING

WHEN: JANUARY 11TH, 1992 9:00 A. M.

WHERE: BAYLAND COMMUNITY CENTER
ON BISSONNET AT HILLCROFT

PROGRAM: The program will be presented by Woodworker and Woodcarver Robert Brunner. Robert made some benches for the John Deer Company with a carved back rabbits. He will bring along one of the benches for demonstration and he will also show us a video on some of the other woodworking that he does in his shop.



Pasadena Industrial Supply



\$45

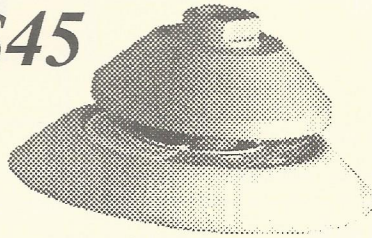

Power Tool & Accessory
 Headquarters for;
 Delta Machinery, Porter-Cable
 Milwaukee, Hitachi, Bosch,
 Makita, Saftey-Speedcut
 & More!

Don't Buy A New DA Sander

Turn your existing 1/2" or 5/8"nc right angle
 grinder into a 5" or 6" Random Orbit
 D.A Sander that uses PSA adhesive discs
 and make use of tools you already own!
 Call us for details!

222 West Pasadena Freeway, Pasadena Texas 77506 472-5588

Hardwood Lumber Co. Lawndale Division Imported and Domestic

Marine Plywood
 Parana Pine
 Teak

Honduran Mahogany
 Exotic Hardwoods
 Domestic Hardwoods

WALNUT - BIRCH - ASH - CHERRY
 GYPRESS - RED AND WHITE OAK
 AND OTHERS

MON. - FRI. 7:30 TO 4:30
 SAT. 8:00 TO 1:00

5401 Lawndale
 (713) 921-6131

Quality

Hardwoods - Softwoods - Plywoods
 Mouldings & Squares

A COMPLETE SELECTION OF FINISHING SUPPLIES.

12/91

Your Complete Woodworking Center Check Out Our Hardwoods, Our Prices Are Low

Hours:
 Monday to Friday:
 10:00 a.m. to 8:00 p.m.
 Saturday
 9:00 a.m. to 5:00 p.m.

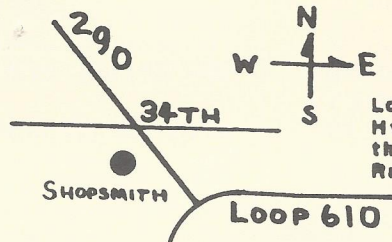

Shopsmith Inc.

Located at 34th St. &
 Hwy. 290 to Austin on
 the West side in the
 Randalls Strip Center.

Northway Shopping Center
 10965A Northwest Frwy.
 Houston, TX 77092
 Phone: (713) 681-5200

1/92

HARDWOOD LUMBER CO.

700 E. 51/2 St. (In The Heights)
Houston, Texas 77007
(713) 862-6628
Hours: M-F 7:30-5:00, Sat. 8:30-1:30

We stock over 65 species of lumber including hard to find exotics!

Also: Plywood, Veneer, Moulding, Formica, Custom Milling, Woodworking Tools, Books, etc.

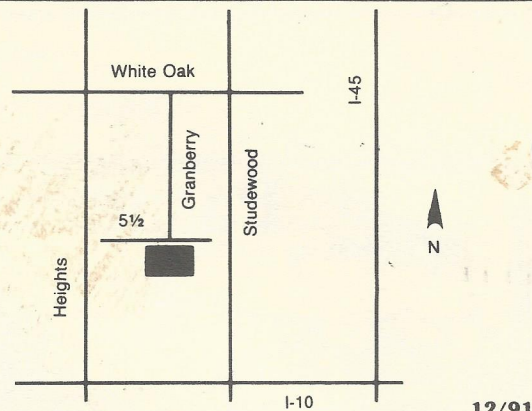

Send Today for the Most Complete Catalog Selection of Woodworking Supplies

Please Enclose \$1.00 (3rd class) or \$2.00 (1st class)

Name _____
Address _____
City _____ State _____ Zip _____

Orders Shipped Within 48 Hours

1/92

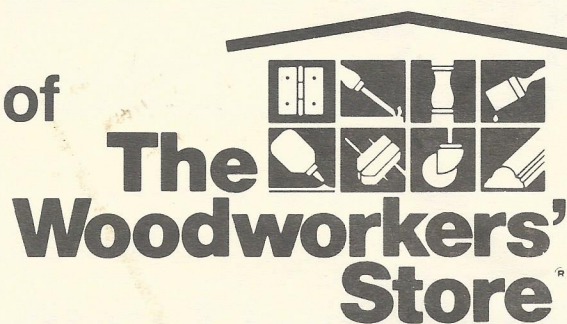

21801 Industrial Blvd., Rogers, MN 55374

PRINTED BY SPEEDY PRINTING SERVICE OF TEXAS 3727 W. ALABAMA, HOUSTON, TX. 77027 (713) 877-8466



5117 April Lane, Houston, Texas 77092
Hours: M-F 7:30-5:00 SAT 8:30-12:30
(713) 686-6176 Phone
(713) 686-3217 Fax

DOMESTIC & IMPORTED HARDWOODS

Ash, Basswood, Birch, Cedar, Cherry, Cypress, Mahogany, Maple, Red Oak, White Oak, Padouk, Poplar, Purpleheart, Redwood, Sycamore, Teak, Virola, White Pine, Walnut, and More.

High Quality Domestic & Imported Plywoods, Softwoods, Hardwood Veneer Edgebanding & Hardwood Veneers
Excellent Service & Competitive Prices!

ON SITE CUSTOM MILLING TO YOUR SPECIFICATIONS, S2S, S2S1E, S4S
(No order too large or too small)

10/92

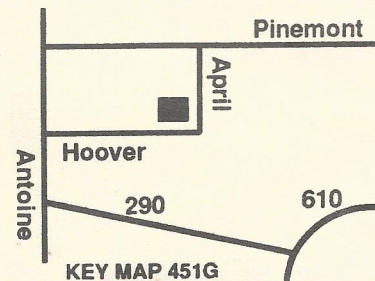

Woodworkers Club of Houston
P.O. Box 34481
Houston, Tx 77234

