

# WOODWORKERS

## CLUB OF HOUSTON

VOL. 4, NO. 1

JANUARY, 1988

### Officers

Sharon Buckley - President  
Kent Moore - Vice President  
Don Richardson - Sec./Treasurer  
Steve Procter - Newsletter Editor

Doug Blodgett - Board of Directors  
Jimmie Harp - Board of Directors  
Ron Kuenning - Board of Directors  
Hebert Wilbourn - Board of Directors

### DECEMBER DINNER AND MEETING

The December meeting was well attended, with over 94 members, spouses and guests. The Rice Faculty Club is an elegant meeting place, with a special raised platform just the right size to display the grand show and tell projects. The food was excellent, as usual.

The \$3500.00 Charity donation was presented to Karen Whitworth by President Bob Soderblom. This is one of the special occasions for both the club and MAKE-A-WISH foundation. A Make-a-Wish foundation child was present to describe first hand the benefits she received from MAKE-A-WISH. It is gratifying to see the the beneficiaries of our donation in person. Thanks again to all club members that donated time, materials and effort for their cause.

The editor was joined by Patrick Quigley of Visser-Roland Organ Builders, and two other very capable judges (There names also went with Bob on his holiday trip, we will correct this in the next newsletter with our many apologies), for the Grand Show and Tell. The categories were Intermediate, Advanced and Master, with awards for craftsmanship, design and practicality. The judges did their best to categorize and evaluate each project objectively. It is a very difficult task because most projects retain all the characteristics of craftsmanship, design and practicality. Our thanks to the judges and for all participants. The complete list of awards follows:

#### BEST OF SHOW 1987 AWARD WINNERS

Practical Project---Intermediate  
First Place: Zatis Murphy--Shaker Clock  
Second Place: Don Richardson--Cassette Box

Practical Project---Advanced  
First Place: Don Sloan--Afgan Rack

Practical Project---Master  
First Place: Gerry Oberton--Back Stretcher

Original Design--Intermediate  
First Place: Bob Gallant--Small Truck  
Second Place: Ed Caesar--Wall Unit

Original Design--Advanced  
First Place: Scott Bazard--Lighted Pedestal  
Second Place: Murray Gordon--Entertainment center

Craftsmanship--Intermediate  
First Place: Chuck Maxwell--Rocking Horse  
Second Place: Sharon Buckley--Art Deco Clock

Craftsmanship--Advanced  
First Place: Ronnie Derks--18 Wheeler Truck  
Second Place: Ron Kuenning--Clock

Craftsmanship--Master  
First Place: Bill Hochmuth--Jewelry Box  
Second Place: Tom Gathright--Game Box

### GIVING THANKS

By Bob Soderblom

I considered the job as your President for 1987 not only as an Honor and a Responsibility to keep our Club active and interesting But also as a challenge to continue searching for new ideas for future growth and benefit to it's members and the community we live in.

The successes of 1987 have been accomplished Thanks to the many members who put forth their time and energies to help make our club the success it is---one of which we can all be proud.

This is not directed only to the officers, board members, committee heads and helpers---BUT TO ALL OF YOU WHO:

Volunteered to Demonstrate your skills for the benefit of other members at a meeting, workshop or clinic;



Spoke up (in turn) during meetings with your suggestions and comments;

Worked on our Highly Acclaimed Newsletter--not only the editor but also the others who compile, type, print, address, transport and mail it every month along with those who submit those wonderful articles on safety, tips speak-outs, techniques, etc.

Contacted possible advertisers for our newsletter.

Assisted with meeting facilities such as lending library, name-tag board, new name tags, coffee pots, etc.

Made and donated items as well as their time and energies to insure the success of our annual charity sale.

Last but not least I want to give thanks for the many new and strong friendships we've made as a result of club membership.

#### BUY AND SELL

If you have items to sell or something you want to buy:

1.) You can announce it at the meeting and it will appear 3 weeks later in the next month's Newsletter or

2.) If you call Steve Procter or Sharon Buckley before the Publishing Deadline ( listed on the back page of each Newsletter) it will be posted in the Newsletter a week before the Meeting. Then anyone interested can talk to you at the meeting and you might Sell it or Buy the item sooner.

**FOR SALE:** Sears Craftsman 10" Table Saw with Retractable Casters, Tenoning Attachment and extra Blades. \$225.00 Sharon Buckley 944-6739.

#### SAFETY

By Zatis Murphy

Among the benefits of being a member of our club, the one I have enjoyed the most is that of learning new woodworking tips and techniques from other members. With safety, we can learn from each other, too.

My years as a research chemist have led me to develop a high level of safety awareness. But it was not always that way. Very little attention was given to safety during my ten years of college. Most of my safety education came after I went to work in the oil industry. Indeed, the potential hazards found in chemical laboratories, manufacturing plants and such, are great. Unsafe practices sometimes are unforgiving; a person may not survive an accident to have a second chance to do it more safely. Therefore, much planning is done to reduce the potential hazards BEFORE any work is started. Even then, accidents occur.

We woodworkers should plan our work carefully, too. If you are like I am, occasionally you've had a "near miss." You've done something that you might have thought was safe, but in the process, something was overlooked and you almost had a disaster. One of our meetings I told you about one such near miss I had while trying to cut the top off an oval-shaped stamp holder with a Bandsaw. I tried to hold the piece by hand and the blade grabbed the wood, yanking it out of my hand. The result was a severely bent blade and a damaged project. Fortunately, I was not hurt. I rethought what I was doing and resorted to holding future pieces with hand screws.

Have you had a near miss? Tell us about it. I welcome any contributions you might have for this column. Send them to me (12630 New Kentucky, Cypress, Tx. 77429) and I will see that they are published; or, if you prefer, tell us about it at one of our meetings. Discussion of near misses and solutions to the problems is one way of helping us all avoid similar pitfalls in the future.

SAFE WOODWORKING IS FUN WOODWORKING !

#### PRESIDENT'S CORNER

By Sharon Buckley

Well another successful year has come and gone. We should all say Thank you to the officers and committees that helped to make a success. But all members should give themselves a pat on the back because it takes good members to have a club that will continue to grow.

Sharing and good friends are a major benefit of this club. The members are always willing to share helpful hints or offer help on a problem that might arise, with a project or a stubborn tool.

When you need help there's always a member who can help.

As always we had another successful Charity Show which agains takes impute from the members--those that donate projects or their time to help us all reach our goals.

So give yourself a well done, and keep up the good work.

We also want to Thank the Officers of 1987: Bob Soderblom, Jimmie Harp, Ron Kuenning, Harold Evans, Rick Goodheart, Hebert Wilbourn and Steve Procter for putting forth that extra effort.

We are always prodding the members to get involved because we want and need new ideas, new direction and new suggestions so that the club will continue to grow and not stagnate.



## COMMITTEES 1988

There are openings on many of the Committees for 1988-- if you are interested in being a chairperson or a committee person--- just let me know.

## FUTURE EVENTS IN 1988

Programs for meeting:

January: Pella Windows

Feb. or March: Visser-Roland Organ Builders  
(If you have not seen this program--Your'e in for a surprise.

Field Trips:

Possibly March or April (When the Weather gets better and before it gets too hot, we plan on a trip to the EAST TEXAS ROCKING CHAIRS in the Piney Woods, Bob Soderblom and Hebert Wilbourn have already been through their shop and found it very interesting.

We are also trying to contact a Carousel Horse Carver as seen on Texas Country Reporter to find out if he might host a visit from our club.

In the past years we have tried to organize a Members Shop Tour: its very interesting to see some of the inovations and ideas that each member has. If you would host a visit from the other members would you please let an officer know.

Clinics and Workshops:

We need more volunteers and ideas on what you would like to have this year.

Charity Show:

If the members are willing?

## PROBLEMS AND SOLUTIONS

THE OLE DELTA SCROLL SAW PROBLEMS.

Henry Reed called the research and development at Delta for more info on the problems with the 18" Scroll Saw-- He found out that:

1.) The Variable speed has a 24 month Warranty, and not 12 months as most owners thought.

2.) There was a discussion on how to set the cams. For detailed information, talk to Henry Reed.

## JANUARY MEETING

WHEN: SATURDAY JANUARY 9TH Starting promptly at 9:00 A.M.

WHERE: PELLA WINDOWS AND DOORS, INC.  
4300 CAMPBELL RD.

( corner Clay Rd. )

DIRECTION: From intersection of Gessner and Clay Rd., Turn East on Clay approx. one(1) Mile to Campbell Rd., Turn Left (North) to Parking Lot. SEE MAP.....

PROGRAM: Business Meeting and Show-N-Tell followed by a promising fascinating look into a company that prides itself on it's

custom woodworking capability. Bring your folding chairs and depending on the weather, a warm coat---The Hot Coffee will be waiting.

## NEWSLETTER INFO

THE FEBRUARY NEWSLETTER

LAST DAY FOR PUBLISHING---JANUARY 22, 1988

THE NEWSLETTER WILL BE MAILED THE WEEK OF FEBRUARY 7, 1988.

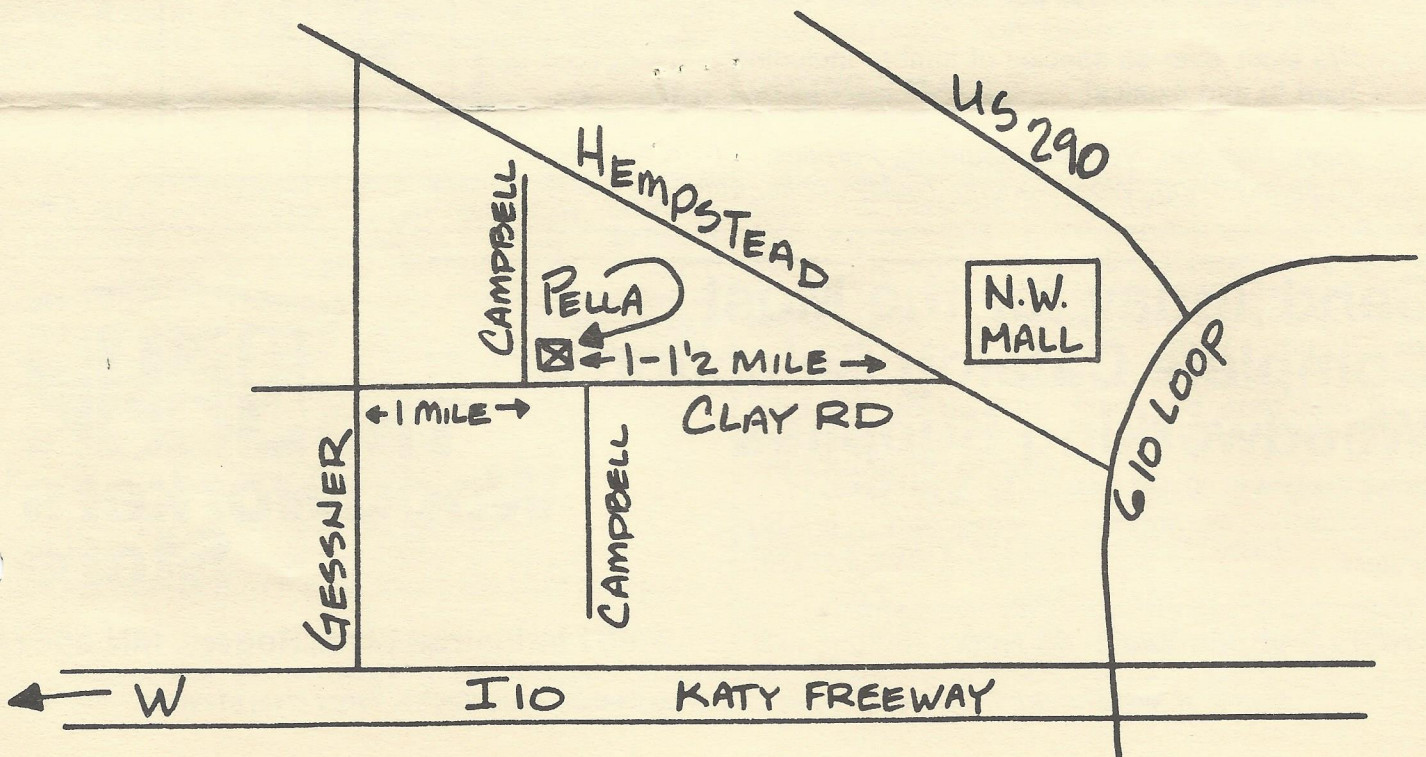



## SURVEY FOR DECEMBER MEETING 1988

THE OFFICERS AND BOARD WANT TO KNOW WHAT YOU WOULD LIKE TO HAVE FOR A DECEMBER MEETING. SOME MEMBERS HAVE SUGGESTED THAT HAVING A DINNER MEETING INSTEAD OF A REGULAR BUSINESS MEETING, WE ARE EXCLUDING SOME MEMBERS BECAUSE OF THE TYPE OF MEETING, DAY OF MEETING AND COST OF MEETING.

IF YOU WANT TO HAVE A DINNER MEETING ON A SATURDAY NIGHT WE MUST MAKE RESERVATIONS NO LATER THAN JANUARY OR FEBRUARY 1988.

IF YOU WOULD JUST TAKE A FEW MINUTES AND CHECK OFF WHAT YOU PREFER OR WRITE IN ANY SUGGESTIONS, EITHER BRING TO THE JANUARY MEETING OR MAIL IT TO SHARON BUCKLEY. WE CAN THEN PLAN ON WHAT THE MEMBERSHIP WOULD PREFER.

PLEASE CHECK WHICH YOU PREFER:

\_\_\_\_\_ DINNER MEETING (RICE UNIVERSITY)

IF YOU MARKED DINNER MEETING PLEASE CHOOSE: \_\_\_\_\_ WEEKDAY \_\_\_\_\_ SATURDAY

\_\_\_\_\_ DINNER MEETING AND REGULAR SAT. BUSINESS MEETING.

\_\_\_\_\_ REGULAR SATURDAY BUSINESS MEETING ONLY

\_\_\_\_\_ SATURDAY MORNING SOCIAL WITH SPOUSES INVITED

\_\_\_\_\_ SATURDAY EVENING MEETING (SUCH AS A COVERED DISH) REMEMBER A PLACE MUST BE FOUND, A PLANNING COMMITTEE TO COORDINATE, AND A CLEAN-UP COMMITTEE MUST BE ORGANIZED. (THIS IS NO EASY TASK).

\_\_\_\_\_ OTHER IDEAS: \_\_\_\_\_  
\_\_\_\_\_  
\_\_\_\_\_

IF YOU WANT AN EVENING COVERED DISH WOULD YOU BE WILLING TO WORK ON A COMMITTEE---  
\_\_\_\_\_ YES \_\_\_\_\_ NO MEMBER \_\_\_\_\_ PHONE: \_\_\_\_\_

### ANNUAL DUES

DEADLINE JANUARY 31, 1988

TO JOIN W.W.C. OF HOUSTON FOR 1988, BRING TO THE REGULAR MEETINGS OR SEND YOUR \$12.00 ANNUAL DUES TO WOODWORKERS CLUB OF HOUSTON P.O. BOX 34481, HOUSTON, TEXAS 77234. MAKE CHECKS PAYABLE TO WOODWORKERS CLUB OF HOUSTON.

Cut off and complete

\_\_\_\_\_ LAST NAME \_\_\_\_\_ FIRST NAME \_\_\_\_\_

\_\_\_\_\_ HOME PHONE \_\_\_\_\_ WORK PHONE \_\_\_\_\_

\_\_\_\_\_ ADDRESS \_\_\_\_\_ CITY \_\_\_\_\_

\_\_\_\_\_ STATE \_\_\_\_\_ ZIP \_\_\_\_\_ SPOUSE'S NAME \_\_\_\_\_

\_\_\_\_\_ OCCUPATION/CRAFT:\*\* \_\_\_\_\_

\_\_\_\_\_ NAME OF EMPLOYER \_\_\_\_\_

\*OPTIONAL FOR USE IN CLUB "YELLOW PAGES" (TO BE PUBLISHED IN 1988)



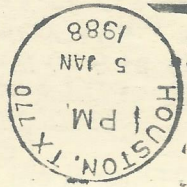
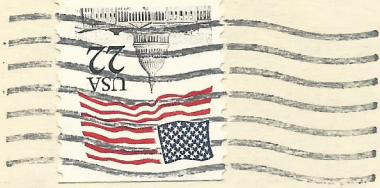

Woodworkers Club of Houston  
P.O. Box 34481  
Houston, TX 77234

# THIS SPACE AVAILABLE FOR YOUR AD



## **HARDWOOD LUMBER CO.**

700 E. 51/2 St. (In The Heights)  
Houston, Texas 77007  
(713) 862-6628  
Hours: M-F 7:30-5:00, Sat. 8:30-1:30

We stock over 65 species of lumber including  
hard to find exotics!

*Also: Plywood, Veneer, Moulding, Formica,  
Custom Milling, Woodworking Tools, Books, etc.*

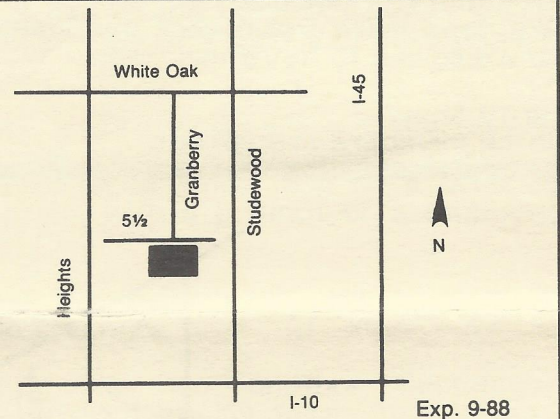

## Send Today for the Most Complete Catalog Selection of Woodworking Supplies

Please Enclose \$1.00 (3rd class) or \$2.00 (1st class)

Name \_\_\_\_\_

Address \_\_\_\_\_

City \_\_\_\_\_ State \_\_\_\_\_ Zip \_\_\_\_\_

**Orders Shipped Within 48 Hours**

5-88

**21801 Industrial Blvd., Rogers, MN 55374**

