

Notes from The January Meeting

Program

Jim Schmidt from 3M showed us many new and some familiar products that are available. Interesting developments have occurred as far as the 'scotch-bite' technology for replacing steel wool. A 0000 version is promised. (I like them since they last longer than steel wool and don't have the rust prevention oil in them. - edt.) Some questions were raised about the new stripping products that are water-based. Those in WwCH are concerned about the fine antiques with delicate carvings. The water will raise the grain and the only suggestion was to sand. Not possible since it would destroy the carving. A new light weight disposable dust/vapor mask was shown. Many like the weight but questioned the practicality/price since the dust filters were replaceable but the charcoal filters were not. Hopefully Jim will take some of the ideas back to 3M. They seem to be heading the right direction. Thanks for the presentation and gift certificate, Jim.

WOODFIND Update

WwCH owns a copy of WOODFIND, a search program and database of woodworking periodical topics and that runs on a DOS based personal computer. Currently, Don Richardson operates it for the club and Zadis Murphy owns a copy that he will use to do searches for club members. Don announced at the January meeting that the database has been updated through 1994 and is available.

To use the service call Don or Zadis and ask about your particular topic. They will get back to you as soon as possible with the different references available. Don usually has his laptop computer at the monthly meetings.

On Safety

Leonard Elholm told of using 'quick grip' type clamps to hold a work piece to a fence on his router table. The task was to trim about 1/32 out of a dado. The bit caught the work piece and flung the piece off of the table. His finger tip ended in the router bit losing part of his finger nail which is growing back. To date the medical bills are about \$500 so far. Please be careful and be sure that everything is held down.

Problems and Solutions

Walt Turpening asked about selecting rocker curvatures for different scales of rocking chairs. Steve Procter suggested in using a catenary curve. Another member suggested checking Thomas Moser's texts on American Furniture Designs.

Don Richardson had a solution looking for problems. In different supply catalogs 'Teflon' tape is being sold in 3/4 inch and 3 inch widths. He has used the 3/4 inch tape on drawer runners with excellent results. Are there any other applications? (I have used it on heavy file drawers in an old desk with wood-on-wood runners eliminated difficult retrofitting of mechanical runners. -edt)

Project Showcase

Dooley George showed his elegant solution to folding sawhorses. Two leg frames of cedar are hinged at the top with an ingenious folding stretcher. When the sawhorse is taken down from the wall a light flip and the stretcher unfolds to separate the legs. To close lift the sawhorse lightly kick the stretcher up and close the 'horse with your hand. Good work, Dooley

Larry Barnes has been concerned about dust in his shop for some time. He started with a Delta 1 hp dust collector but found it inadequate. After reading an article in Fine Woodworking #100, he decided to build his own system. It uses a cyclone separator as stage one that dumps into a large plastic 'trash can' with stage two being a series of inverted dust filters that are used in commercial dust systems. The inverted filters are self cleaning in that when they have collected enough dust it falls naturally to the dust box. Actually the filters should not be cleaned since the dust that collects makes the filters better. He bought the filters from a supplier of commercial systems. The final system size is approximately 8 feet high, 5 feet wide and 2 feet deep and cost about \$400 to build. His shop has 10 feet ceilings. Larry's photos of the system show a very nice piece of work in a very nice shop.

Ken Wallis showed his latest creation, an entertainment center that houses a 35 inch TV with other electronic equipment. The cabinet is 5 1/2 feet high, about 8 feet long and 25 inches deep. Birch plywood is the main construction material (5 sheets worth) with maple from A-1 Lanes (naturally -edt). It is stained with Bartley's jet mahogany after a coat of Bartley's varnish to even out the stain take-up by the birch plywood. Impressive, Ken.

Bob Pffifner showed his working scale model of a 'South Pointing Compass'. The original was a two wheeled cart towed at the back of caravans crossing the Gobi desert. Simple toothed wooden gears operated on the differential principle to keep a carved figure pointing in the desired direction as the caravan wandered across the terrain. If the two wheels rotated exactly the same number of revolutions the figure did not change its pointing direction relative to the cart, but if the cart turned, even slightly, the figure would rotate towards the direction the caravan should be heading. It is an example of one of the earliest practical use of gears. He suggests making the wheels wider to increase the friction and ease of operation. Nice work, Bob.

Recommendations

Zadis Murphy reviewed 'Woodworking With A Router' published by Rodale Press. He found it an excellent resource for jigs and ideas to use with his router table.

For Sale

3 electric motors, 1/3 hp 220 VAC - \$35.00,
Jerry Dahlgard at 578-2051

February Meeting

When: February 11, 1995 9:00 AM

Where: Bayland Community Center
on Bissonnet at Hillcroft

Program: Being arranged at press time

Raffle: Brad Hartman (Manager, Woodcraft Supply store at 34th and 290) has donated 3 sets of Record C-clamps (3 each 4 inch). These are the English made S. Thank you, Brad.

Libraries

Remember that the raffle proceeds are used to expand our book and video libraries. We have many excellent books and tapes but there are many we don't have. If you have found some give your suggestions to Denis. Also note that the Book Library doesn't have a librarian. Remember that you have the chance to read the books when they aren't loaned out. Please volunteer.

From Last Year's Charity Project

We received a nice thank you note from Sister Linda telling us of the joy brought by the toys we made and gave. Three big items were raffled to the local community which brought \$496. They used the money to help pay some utility bills of those in need.

Annual Charity Projects

It isn't the Christmas season but let us keep in mind that when we make a small project make a second for those less fortunate. From last year's example just hand toys are not only things to be made. Other projects like puzzles, pull toys, chairs, and other playthings are needed. Some things we can make and donate can be raffled or auctioned for proceeds to help different organizations we will be selecting later in the year.

From the Editor's Bench

One question at the last meeting was from Chuck Maxwell about the change in the newsletter format. One thing I like to do is keep a file of the past issues as a way to recall ideas, phone numbers, supplier's numbers, etc. Also there are informational handouts at the meeting that I really don't have a file for. So the idea is to back-fold the issue to make a file folder with the name date and issue easily read in the file drawer. The insert page is going to be information you would like to post or take out and carry with you. The paper weight is enough to make good paper airplanes for the grandchildren.

I am also looking for articles on finishing tricks, refinishing tricks, simple charity project toy plans, etc.

Program Ideas

Saul is working on getting speakers for our meetings. However, at the board meeting we did discuss 'how-to' programs some are: Layout and design for production; Aspects of designing from scratch; and Shop layout. Let Saul know. There are members that would be willing to do one or more of these type projects.

From the President's Shop

One of my goals for 1995 is to get more members involved in the club beyond the monthly meetings. It has been disappointing the last several years with the small number of members participating in the charity events we have had. It is not my intention here to lay a guilt trip on anyone I intend to get more members involved. I would like to hear from anyone with ideas to help.

One idea we talked about at the board meeting was to form some small groups to meet informally at people's homes or shops. The groups could meet on what ever basis they decides and set their own agenda. I can see that this could be a place for ideas and skills to be shared. Less skilled members could ask questions and even be given hands on demonstrations.

Please be thinking about this and consider joining or starting one of these groups. Let's get more involved. See you at the meeting. **Jimmie Harp.**

Quotation for the Month

"Like all true craftsmen, a woodworker is completely dedicated, with a strong sense of vocation. Often his craft has been handed down from generation to generation. A woodworker's hands develop in a special way with intense and concentrated use. The flesh becomes stronger and heavier in certain area, better fitted to grasp and use the tools.

He has a special intensity, a striving for perfection, a conviction that any task must be executed with all his skill. Basically the woodworker is not driven by commerce, but by a need to create the best object he is capable of creating. Even if the object were to be destroyed when finished, the craftsman would still give the task his all."

- George Nakashima

The Soul of a Tree: A Woodworker's Reflections

Officers

| | | |
|----------------|----------------|----------|
| President | Jimmie Harp | 664-4906 |
| Vice President | Saul Harris | 341-5373 |
| Sec'y/Treas. | Lee Palfreyman | 497-7085 |

Services

| | | |
|-------------------|----------------|----------|
| Book Library | Vacant | |
| Video Library | Denis Muras | 943-7745 |
| Literature Search | Don Richardson | 661-1365 |
| | Zadis Murphy | 469-3563 |

Directors

| | |
|----------------|----------|
| Andy Anderson | 730-1030 |
| Art Chester | 469-1990 |
| Steve Procter | 728-1459 |
| Don Richardson | 661-1365 |

Newsletter Editor - Walt Turpening, 879-5640

Fine Handcraft Calendar of Events

Happenings in and around Houston

Woodworkers Club of Houston

Meeting: February 11, 1995 9:00 AM at Bayland Community Center

Houston Area Woodcarvers Club

Meeting: February 18, 1995 9:00 AM at Bayland Community Center

Gulf Coast Woodturners Association

Meeting: February 18, 1995

Contemporary Handweavers of Houston

Meeting: February 16, 1995 7:00 PM at Palmer Center

Announcement

As Jimmie has asked in his "Shop Note", Sw Wood Guild is being organized. Those in the Sugar Land area interested in informal gatherings about once a month at woodworker's shops to share different aspects of woodworking are invited to an 'organizing' gathering. The idea is to meet in different shops to learn new techniques, practice old skills, build projects and all in all have fun.

The 'organizing' gathering is scheduled for:

Sunday February 19th, 3:00 PM at Walt Turpening's shop, 11606 Brook Meadows, Meadows
Call 879-5640 so there's enough seats and goodies.

The Lowest Prices On JET Machinery Every Day!

Rebate Sale on Quality JET Woodworking Tools:

The New JET JWTS-10JF Table Saw \$529

JET WBS 14OS Open Stand Band Saw: \$439

JET JJ6CS 6" Long Bed Jointer. All Cast Iron: \$449

JET DC-650 Dust Collector. 1 HP, 650 CFM: \$209

AND The unique 30" JET FENCE! \$139.99 (Through 2/1)

The solution to your Craftsman or Delta rip fence hassels!

7123 SouthWest Fwy, Just North of Bellaire Blvd. (713) 981-9228

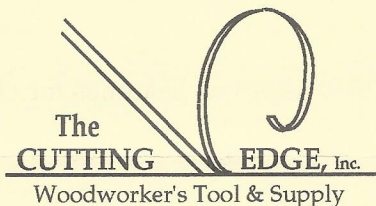

Mon. - Fri. 9 am to 6 pm

Sat. 10 am to 5 pm

Sun. Noon to 4 pm

WwCH Membership

To Join the Woodworkers Club of Houston for 1995, bring this form to the regular meetings or send your dues to:
WOODWORKERS CLUB OF HOUSTON, P.O. BOX 34481, HOUSTON, TEXAS 77234

Make checks payable to Woodworkers Club of Houston.

Renewal Membership \$24.00

New Membership is prorated if 1st year is less than 1 year.

WwCH Membership Form

Last Name _____

First Name _____

Address _____

Spouse's Name _____

City _____

Home Telephone _____

State _____ Zip _____

Work Telephone _____

Renewal Membership \$ _____

New Membership \$ _____

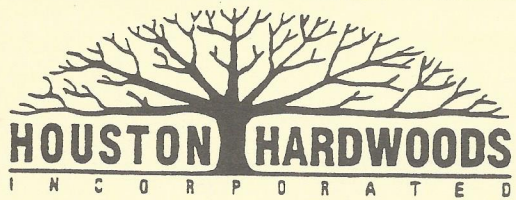

686-6176

FAX: 686-3217

4910 West 34th St, Houston, Texas 77092
Hours: M-F 7:30-5:00 SAT 8:30-12:30

DOMESTIC & IMPORTED HARDWOODS

Ash, Aspen, Basswood, Birch, Aromatic Cedar, Cherry, Cypress, Lacewood, Mahogany, Maple, Oak, Padouk, Pecan, Poplar, Purpleheart, Redwood, Sycamore, Teak, Walnut and more.

- *Quality Domestic & Imported Plywood (Interior & Marine)
- *Edgebanding & Veneer
- *Butcher Block Tops
- *MDF & Melamine
- *Moulding
- *PERSONAL SERVICE
- *PROMPT DELIVERY
- *ON-SITE CUSTOM MILLING

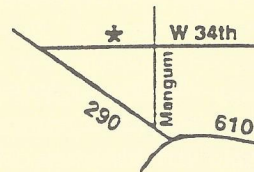

AUSTIN HARDWOODS

13001 Veterans Memorial Dr #408

- Rare Exotics - over 80 species in stock
- Turning Stock / Veneers / Dowels
- Flooring / Moldings / Plywoods
- Finishing Supplies
- Millwork & Woodwork available including Custom Profiles
- Custom Knife Grinding Services
- Project Hardware

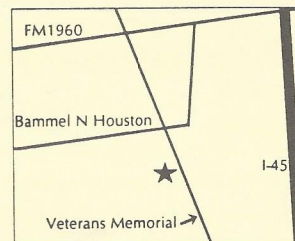

440-0764

2/95



WOODCRAFT®

Woodworking Tools • Books • Supplies
Since 1928

Woodcraft offers over 4,500 of the finest woodworking tools, books, supplies, cabinetry hardware, and wood available in the world today! We are committed to woodworkers of every skill level, from beginners to professionals, and every discipline, from carving to woodturning and fine cabinetry! Ask about our classes and demos next time you're in our neighborhood! We are an authorized dealer for Shopsmith, Delta, Porter Cable, Bosch, Record Marples and many more favorite, top quality brands!

EXCLUSIVE U.S.A. DISTRIBUTOR SWISS MADE CARVING TOOLS

Northbrook Shopping Center • 5360 West 34th Street • Houston, TX 77092 • 713-681-5200

4/95

Pasadena Industrial Supply

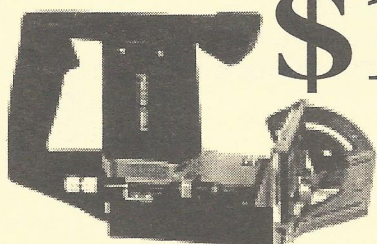

\$159

List \$340

While Supplies Last!

Porter Cable #556 Plate Joiner Kit

- 5 Amps, AC/DC
- 8,000 RPM
- 0-90° tilt fence & Std preset 90° & 45° fence
- Rotating depth stops for #0, #10 & #20 biscuits
- Includes steel carrying case

222 West Pasadena Freeway, Pasadena Texas 77506 472-5588

For U.S. addresses only



Woodworkers Club of Houston
P. O. Box 34481
Houston, TX 77234

HARDWOOD LUMBER CO.

700 E. 51/2 St. (In The Heights)
Houston, Texas 77007
(713) 862-6628
Hours: M-F 7:30-5:00, Sat. 8:30-1:30

We stock over 65 species of lumber including
hard to find exotics!

*Also: Plywood, Veneer, Moulding, Formica,
Custom Milling, Woodworking Tools, Books, etc.*

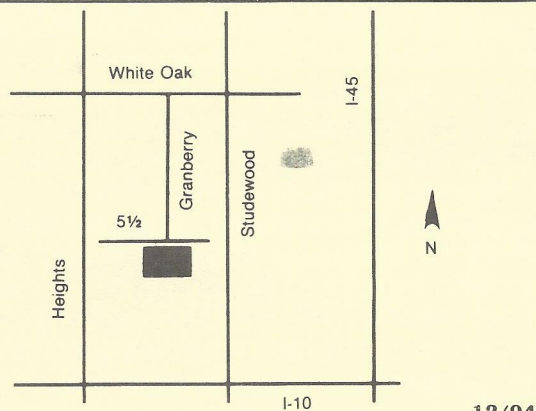

12/94

Send Today for the Most Complete Catalog Selection of Woodworking Supplies

Please Enclose \$1.00 (3rd class) or \$2.00 (1st class)

Name _____
Address _____
City _____ State _____ Zip _____

Orders Shipped Within 48 Hours

7/95



21801 Industrial Blvd., Rogers, MN 55374