

# Woodworkers Club OF HOUSTON

VOL. 7, NO. 2

FEBRUARY, 1991

## Officers

Zatis Murphy - President 469-3563  
Denis Muras - Vice President 943-7745  
Leo Orinderff - Sec./Treasurer 445-5460  
Sharon Buckley - Newsletter Editor 944-6739

## Board of Directors

Claude Emory - 861-3495  
Ted King - 351-6808  
Don Richardson - 661-1365  
Lewis Vallette - 643-2014

## JANUARY MEETING

The program for January was on Picture Framing presented by Sam Galner.

Sam got started in picture framing because of his interest in photography. When he went to frame shops, he was very dissatisfied with what was available. Sam decided that he could make a better looking frame molding if he did it himself.

Sam uses a router and router table to mold his profiles. You could also use a shaper but most of us already have a router and to get the most out your router you should be able to mount it upside down in a stand.

First, your table should be very solid or attached to the wall or your work bench. Because when molding your profiles you want to make sure that the wood you feed past the bit cannot move away from the bit in any direction. You should wax your tables or as some suggest use baby talcum powder as a lubricant and it will also prevent rust from forming on your work surfaces.

Sam also uses a multi-form bit, they run in cost from \$29.00 to \$98.00 depending on where you purchase and where the bit was manufactured.

You can also purchase router bits with a picture frame profile.

Sam suggests you refer to Woodsmith #60 December 1988, for ideas on what type of styles you can make with different router bits.

After you make up your molding you are going to have to cut those 45 degree angles that are always a challenge.

To make it easier to get good true cuts, Sam has made a jig to cut those 45 angles. The base is made from 3/4" birch plywood with oak strip runners (if you have a problem with humidity in your shop you could use aluminum bar for the runners). The runners must fit without slop and must not be too tight.

The angles are laid out with draftsman squares and triangles--always make sure that

your squares are square.

When making your 45 degree cuts the wood must not move, so Sam uses wedges to hold the wood stationary.

To achieve a spline joint Sam has made a jig to accommodate a biscuit cutter in his router--the slot can be made in the 45 degree frame joint.

For added accuracy Sam uses an Inca jig which is mounted to his router table.

Sam recommends when buying measuring devices to spend a little extra and buy the best you can, in the long run it will save you money.

Sam also recommends using a magnifier that sits on your head and you can flip down the magnifier when needed. Again the ones in the \$10.00 range are not very good you need to spend in the \$20.00 range and better. These also come in different magnifications--he purchased his at Texas Nautical on Westheimer just West of Shepherd.

We all would like to Thank Sam Galner for an interesting program.

Sam's program dealt with picture frame molding but these same techniques and jigs can be used on any type of molding--from furniture to home remodeling.

Leonard Elholm recommends the Forest Saw Blade Co. as the best at Router bit sharpening, he says that after Forest sharpens them they are better than new.

## CHARITY SHOW PRESENTATION

Sam Zeisman presented a check in the amount of \$5,850.00 to Lee Norris a representative of the Make-A-Wish Foundation on behalf of all the members of club.

W.A.N.A. SHOW---WOODWORKING SHOW  
Friday March 1 through Sunday March 3.

We need some helpers for the W.A.N.A. show. It looks like we have enough for the set up on Friday afternoon and evening but we need helpers for Saturday and Sunday. Zatis will have the actual times that the show is open by our Feb. meeting.

We also need items to display--no items to sell--we are using this avenue to promote the club.

We could not do this if the W.A.N.A. organization did not offer us this space free of charge.

The Show will be held at the Pasadena Convention Center on Fairmont Blvd. just off Beltway 8.

You can get there by either going out Hwy. 225 to the Fairmont exit or by going South on Hwy. 45 to Beltway 8 and to the Fairmont exit.

### WORKSHOPS AND CLINICS

Stuart Murphy has two clinics in the works--Making Wood Screw Clamps by Murray Gordon and Bandsaw boxes by Bill Beggs.

### SAFETY

Murray Gordon presented a safety program on Heaters in the shop.

Murray recommends a heat pump for the shop--it heats in winter and cools in summer.

Any open flame heater is very dangerous in and around dust and chips.

One recommendation would be to heat the shop before you start and then turn off the heater. Remember if you have a heater with a pilot light to turn off the pilot light before starting any dusty operations because dust can explode.

It was also recommended that a forced hot water system could be installed.

At the December meeting Robert Sandlin showed us a enclosed hot water heater available at Home Depot and Builders square.

Just be very careful around heaters and woodworking.

### PROBLEMS AND SOLUTIONS

Don Sloan was looking for a good source of #1 clear Cypress in 5/4 and 4/4. It was suggested that he try a place in New Orleans.

We had a member that has to glue up many pieces to make up some very large panels. Don suggested that he make a jig from 3/4 inch plywood with 2 x 4's placed at true right angles. You then place the pieces side by side in the jig and pull up tight with wedges--if the boards pull up clamp a piece of 3/4 plywood on top.

### BUY AND SELL

Harry Jacobsen has a 1/2 hp 1725 PRM motor for sale ---\$70.00

Bill Baker is selling a 15" Delta Scroll Saw for \$90.00.

For Sale Table Saw--Sears Craftsman motorized, 10" tilting arbor, 120 V. 12 amp, 3450 RPM, 60 HZ. 1 ph motor. Table 22"x 48" complete with Duplicator jig 1-10", 3-8", 2-7 1/2", 1-7" blades. On legs with casters contact Don Sloan 688-8986 \$195.00.

### SHOW AND TELL

Don Richardson made a shelf out of Tuara (Mahogany family wood from Brazil) shelf that matches the backs of his dining room chairs. He made a full size drawing on his computer.

Chuck Maxwell showed us how not to glue up a project. He also showed us how to make raised panels on a molding head, cabriole legs for a bachelor chest and how to enlarge your smaller patterns on a xerox machine.

One of our members stepped up with a brown bag, saying how he was inspired by our program on musical instruments to make one of his own. As he pulled this instrument out of the bag, you could see a well made head of a guitar where you so dilligently tune the strings by turning the guitar tuning pegs, to the neck of the instrument where you finger the strings against the frets of the neck, next came the sound box of the guitar and what a sound box ---A TOILET SEAT-- I'm not sure where you play this type of instrument but it could come in handy in the country on a camping trip. Well done, we all had a great laugh.

Don Sloan made a Butlers Table and a Set of Dominoes that he won a ribbon on at the Xmas Show and Tell Dinner. Don had some suggestions when making the dominoes--becarefull of the grain--make sure it is all the same or you could be making a marked set of dominoes, like a marked set of playing cards.

Don made a set by sandwiching two outer layers of walnut with an inner layer of maple.

Don noted that Cherry will darken with age but aging can be brought by the use of a spray oven cleaner and wiped off--but you must experiment with the amount of time you leave the oven cleaner on the wood.

Another suggestion was to place a small amount of ammonia in a cup inside a plastic bag for small items or a 55 gal drum for larger items--place your finished item inside overnight--but you will have to allow the finished items to air out a while to remove the ammonia odor.

### MEMBERSHIP ROSTER AND BADGES

The membership roster will be mailed with the March newsletter and badges will be printed up and will be at the March meeting. So if any name, spelling, address, phone number, is

wrong tell Sharon at the Feb. meeting, call her or drop her a line soon or it will be too late. We intend to print one roster for the year with corrections and additions in the newsletter.

We think you will like this new roster and be sure not to lose it, because one is all you get.

### DUES, DUES, DUES.

This is the last notice that 1991 dues are now delinquent. If not paid by the next meeting your name will not appear on the 1991 roster and you will not receive a March newsletter.

### PAYMENT OF DUES

Please when paying your dues pay either with a check or with the exact change \$18.00. Remember our Sec./Treas. is not a bank and it is very hard to deal with cash or have enough change for everyone. Now a days no one wants to carry to much cash.

### DRILL PRESS SAFETY

The following article is from the Power Tool Institute on The Drill Press.

Read and understand the warnings and instructions on the drill press and in the owner/operator's manual.

Always wear safety goggles or safety glasses with side shields complying with current national standard, and a full face shield when needed. Use a dust mask in dusty work conditions. Wear hearing protection during extended periods of operation.

Do not wear gloves, loose clothing, jewelry or any dangling objects, including long hair, that may catch in rotating parts or accessories.

Remove material or debris from the area that might be ignited by hot chips.

Make certain the chuck key is removed before starting the tool. The key can be thrown at high velocity if not removed.

Be sure belt guards are installed and functioning properly.

Never hold the workpiece by hand. To prevent the workpiece and backup material from spinning, set them against the left side of the drill support column. Secure the workpiece with a clamp or the appropriate fixture if it is too short to reach the column.

Carefully set the drill press speed appropriate for both the type of material and bit size you are using.

Don't touch the bit or chips. Drill bits and cuttings are hot immediately after drilling.

If something goes wrong, never attempt to correct a problem with the drill operating. Shut it off and unplug it if possible.

Never reach around or under the working head, or grab the chuck to stop a drill press. This can result in hand puncture or other serious injury.

Always shut off, unplug if possible, and lock the press if a lock is available, and store the key.

### ANNUAL DUES

DEADLINE JANUARY 31, 1991

TO JOIN W.W.C. OF HOUSTON FOR 1991, BRING TO THE REGULAR MEETINGS OR SEND YOUR \$18.00 ANNUAL DUES TO WOODWORKERS CLUB OF HOUSTON P.O. BOX 34481, HOUSTON, TEXAS 77234. MAKE CHECKS PAYABLE TO WOODWORKERS CLUB OF HOUSTON.

Cut off and complete

LAST NAME \_\_\_\_\_ FIRST NAME \_\_\_\_\_

HOME PHONE \_\_\_\_\_ WORK PHONE \_\_\_\_\_

ADDRESS \_\_\_\_\_ CITY \_\_\_\_\_

STATE \_\_\_\_\_ ZIP \_\_\_\_\_ SPOUSE'S NAME \_\_\_\_\_

OCCUPATION/CRAFT:\*\* \_\_\_\_\_

## FEBRUARY MEETING

WHEN: FEBRUARY 9, 1991 9:00 A. M.

WHERE: BAYLAND COMMUNITY CENTER  
ON BISSONNETT AT HILLCROFT

PROGRAM: The program will be on design presented by Dr. Bill Forkner. Dr. Forkner puts on a very interesting and informative program and will not want to miss this one. One of the biggest problems we all encounter is the actual design of the projects we wish to build.

See you all at the meeting !!!!!!!!!!!!!!!!!!!!!!!

## THE YEAR 1991

We'll be just getting started on a new year--the first couple of months --we have to let the new officers get into the groove, collect the dues, get out the roster and make all the name tags.

Zatis also needs to fill any positions that are vacant--when he asks for help --join the fun --its not hard and you will really enjoy what ever you under take.

## GROUP PURCHASES

Greg Mills will coordinate the group purchases, but he needs suggestions on what we could purchase as a group---most anything but wood.

## FIELD TRIPS

We would like to arrange some field trips, but we need suggestions. So put on your thinking caps and lets come up with some good ideas.

## CLUB CAPS---\$5.00

See Leo Oringderff if you would like one.

# Pasadena Industrial Supply

Power Tool & Accessory  
 Headquarters for;  
 Delta Machinery, Porter-Cable  
 Milwaukee, Hitachi, Bosch,  
 Ryobi, Makita, Skil.  
 Saftey-Speedcut & More!



## Ripping Special!

Delta# 34-445 10" Contractor saw with 1-1/2hp mtr runs on 115/230v with the new Delta Unifence that provides a 32" Rip to the right of the blade with an accuracy of 1/64". Presswood top not included!

**Only \$ 739.00**

**AND** Get a \$100 rebate direct from DELTA thru Feb 28  
 222 West Pasadena Freeway, Pasadena Texas 77536 472-5588

## Hardwood Lumber Co. Lawndale Division Imported and Domestic

Quality  
 Hardwoods - Softwoods - Plywoods  
 Mouldings & Squares

A COMPLETE SELECTION OF FINISHING SUPPLIES.

Marine Plywood  
 Parana Pine  
 Teak

Honduran Mahogany  
 Exotic Hardwoods  
 Domestic Hardwoods  
 WALNUT - BIRCH - ASH - CHERRY  
 CYPRESS - RED AND WHITE OAK  
 AND OTHERS

MON. - FRI 7:30 TO 4:30  
 SAT. 8:00 TO 1:00

5401 Lawndale  
 (713) 921-6131

Exp. 12/90

## Your Complete Woodworking Center Check Out Our Hardwoods, Our Prices Are Low

Hours:  
 Monday to Friday:  
 10:00 a.m. to 8:00 p.m.  
 Saturday  
 9:00 a.m. to 5:00 p.m.

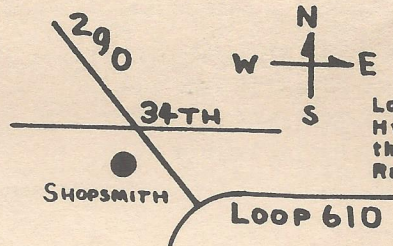

### Shopsmith Inc.

Located at 34th St. &  
 Hwy. 290 to Austin on  
 the West side in the  
 Randalle Strip Center.

Northway Shopping Center  
 10965A Northwest Frwy.  
 Houston, TX 77092  
 Phone: (713) 681-5200

Exp. 1/91



## AUSTIN HARDWOODS

13001 VETERANS MEMORIAL DR.  
 HOUSTON, TEXAS 77014

**440-0764**

We stock over 80 species of lumber including rare exotics and turning stock. Plywood, Veneer, Moulding, Flooring, Tools, Millwork, Paneling Etc. also available

Exp. 8/89

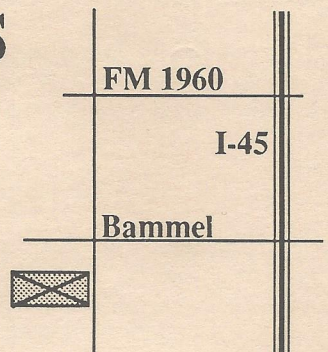

# HARDWOOD LUMBER CO.

700 E. 51/2 St. (In The Heights)  
Houston, Texas 77007  
(713) 862-6628  
Hours: M-F 7:30-5:00, Sat. 8:30-1:30

We stock over 65 species of lumber including  
hard to find exotics!

*Also: Plywood, Veneer, Moulding, Formica,  
Custom Milling, Woodworking Tools, Books, etc.*

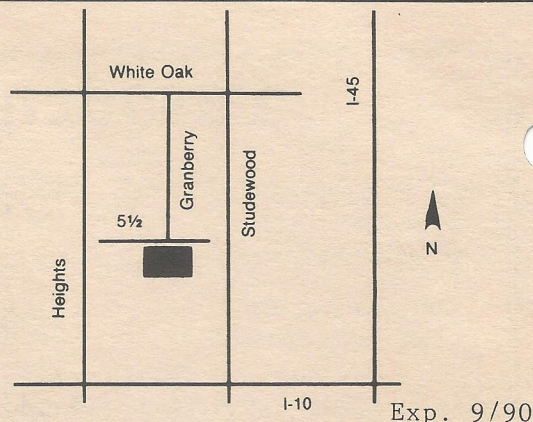

## Send Today for the Most Complete Catalog Selection of Woodworking Supplies

Please Enclose \$1.00 (3rd class) or \$2.00 (1st class)

Name \_\_\_\_\_  
Address \_\_\_\_\_  
City \_\_\_\_\_ State \_\_\_\_\_ Zip \_\_\_\_\_

*Orders Shipped Within 48 Hours*

Exp. 1/91

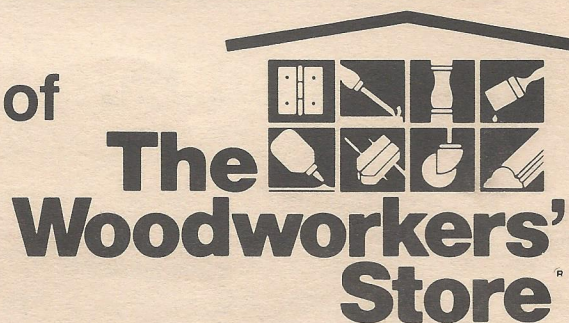

21801 Industrial Blvd., Rogers, MN 55374

PRINTED BY SPEEDY PRINTING SERVICE OF TEXAS 3727 W. ALABAMA, HOUSTON, TX. 77027 (713) 877-8466



5117 April Lane, Houston, Texas 77092

Hours: M-F 7:30-5:00 SAT 8:30-12:30

(713) 686-6176 Phone

(713) 686-3217 Fax

### DOMESTIC & IMPORTED HARDWOODS

Ash, Basswood, Birch, Cherry, Mahogany, Maple, Red Oak, White Oak,  
Poplar, Walnut Etc.

High Quality Domestic & Imported  
Plywoods, Softwoods, Hardwood Veneer  
Edgebanding & Hardwood Pliable Veneers  
*Excellent Service & Competitive Prices!*

ON SITE CUSTOM MILLING  
TO YOUR SPECIFICATIONS,  
S2S, S2SIE, S4S  
(No order too large or small)

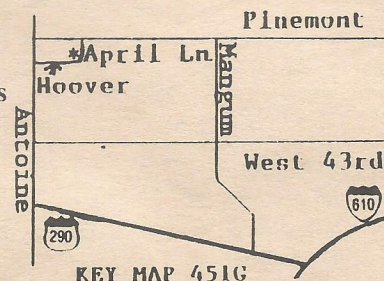

Expires 8/91

Woodworkers Club of Houston  
P.O. Box 34481  
Houston, Tx 77234

