

# Woodworkers Club OF HOUSTON

VOL. 6, NO. 2

FEBRUARY, 1990

## Officers

Don Richardson - President 661-1365  
Ted King - Vice President 351-6808  
Claude Emory - Sec./Treasurer 861-3495  
Sharon Buckley - Newsletter Editor 944-6739

## Board of Directors

Bill Baker - 667-8381  
Bob Gallant - 376-0276  
Bill Hochmuth - 774-1733  
Bill Sallans - 465-0291

## JANUARY MEETING

We officially started our new year with our new officers and our new meeting place.

The program was presented by Lu Rockman and Gregg Hackett of Rockvam Design. This husband and wife team have special talents which have produced some interesting creations. In addition to polychrome wooden animals, they have designed and crafted the Mellice Bed.

The Mellice Bed is the answer to a child's fantasy in the form of a bed. It has a head board which depicts a night sky as seen between two trees. The foot board is a storage/doll house creation in the form of a Tutor village. The scene includes four English-Tutor houses nestled between two lamp posts. Young children crawl around, over and into the structure with a joy which is expanded by their young and fertile imaginations.

Gregg who is an interior architect and Lu whose specialty is audio and graphic design had an interesting story to share about their design approach to woodworking. Lu had slides of some examples of Greg's interiors including furniture he has designed for hotels and restaurants around the country.

In the colors chosen for the Mellice Bed as well as those used on their animal creations you get hints of Lu's days of television set design.

Thank you Lu for an interesting presentation and for sharing your design ideas.

## PRESIDENT'S CORNER

By Don Richardson

### YOUR CONTRIBUTIONS TO MAKE-A-WISH

The woodworking projects you have faithfully produced for our annual fall charity sale are, in fact, contributions to the Make-A-Wish foundation a fully "qualified charitable institution" (see below).

The following article is provided by Malvern D. Lusky, CPA (713) 728-1272.

## CHARITABLE CONTRIBUTIONS

It's that time of year again when we begin to pull our papers together and get ready to tell all to Uncle Sam. Among the items we will be searching for will be charitable deductions.

Tax laws encourage citizens to give to charitable institutions. With few restrictions, the full amount of money or items contributed to a charity is deductible from your tax return.

Charitable contributions are considered on of the "itemized deductions" which also include medical expenses, real estate taxes, certain interest payments and a limited amount of miscellaneous other items. The total of all itemized deductions may be deducted from income to determine your taxable income.

Charitable contributions are allowed as long as the gifts are made to a qualified charitable institution. The contributions must be in the form of cash or items actually contributed to the charity. According to the IRS, the time and personal services you contribute to charity has no ascertainable value and therefore is not deductible. Even if you normally charge \$50 per hour for your services, and you perform the same service for the charity, you will not be allowed a charitable deduction for your services. Likewise you will not be allowed a charitable deduction for the full retail value of an item you have produced or manufactured. You will, however, be allowed to deduct the amount of the supplies and other items you had to purchase to manufacture the item.

Thanks Mal, for a fine and informative article. Mr. Lusky is a CPA practicing here in Houston. I have done business with him and he is a personal friend.

## WORKSHOPS AND CLINICS

Stuart Murphy has analyzed the survey sheet he handed out and asked all members to fill out with sort of a wish list as for the type of woodworking classes you would like to have available.

As always he got more suggestions as to the variety of clinics than members who could or would teach some of these clinics or workshops.

Stuart appreciates all the suggestions and is rounding up all the volunteers, so he can set a schedule and start signing up all the eager wood butchers.

Some of the suggestions are: Finishing and Refinishing, Sharpening, Joinery, Bowl Turning, Router Techniques, Bandsaw Boxes, Toy Making and Scroll Saw Techniques, and many more. If you have any knowledge, you don't have to be an expert please contact Stuart Murphy.

## 1990 DUES

Your 1990 Dues are due now--This will be your last Newsletter--if you have not Paid your Dues. We don't want to lose anyone so pay up now.

## NAME TAGS

New Name Tag Badges will be made up for the March Meeting--if your badge is not correct or you prefer a nickname let Sharon know by the February Meeting.

## CLUB ROSTER

Rosters will be included in the March Newsletter mailing. If there are any changes to your address, home phone, office phone or zip code, Be sure to tell Sharon by the February Meeting.

## THANK YOU

Ken Wallis would like to thank Shoptsmith for the use of their classroom and equipment.

Richard of Shoptsmith for helping Ken with the difference between Kens shoptsmith 500 and the new 510.

Andy Anderson and Ted Cooper Video taped Kens Stave Bowl construction workshop and Ken is editing the tape now.

Thanks to all for their help.

## TELEPHONE COMMITTEE

Bob Odom who didn't know he volunteered again for Chairman. Would like to volunteer all the members who were on last years committee for this years committee.

## WOODWORKING WORLD SHOW

The Woodworking show that was held last year at the Pasadena Convention Center will be returning again this year March 2, 3 & 4. thats Friday Evening, Saturday and Sunday.

The shows promoters have offered us a complimentary booth to promote our club and we have accepted.

We need some Show and Tell Items for the

booth. If you would like to Show off some of your projects, bring them to the show on Friday or to the February Meeting .

We also need members to work the booth, its more working your mouth than any physical work. Being a member from the beginning I have never found a woodworker who was lacking from a gift of gab. If you can help out let Bill Hochmuth know as he is coordinating.

The Gulf Coast Wood Turners will have a larger booth than last year so they can do actual demonstrations on the lathe. I know some of our members are also members of the Wood Turners Club.

## SHOW AND TELL

Leonard Elholm passed around an old tool to find out what it was. No one seemed to know--looking through a New Woodcraft Magazine I spotted this Stanley Side Rabbet Plane No. 79. Side rabbet planes were designed to trim rabbets and dados up to 1/2" depth in either direction.

Murray Gordon had speaker stands that he made out of Southern Walnut and finished in Watco Oil.

Denis Muras made a movable Dinosaur from Black Walnut, finished in 2 coats of Tung oil.

Don Sloan made a bunch of hand mirrors for the gals in his family. From the left over cut outs, he devised a jig to turn the left overs into laminated coasters.

Stuart Murphy had a perpetual motion bear.

Barham Hand made copycat clamps of wood and metal, similar to the clamps that Shoptsmith sells.

## PROBLEMS AND SOLUTIONS

Bill Hochmuth broke off some brass screws when attaching hinges to an entertainment center. If the screws are large enough you can remove them, by using a masonry bit if that doesn't work there are screw extractors in many sizes.

Bob Soderblom needed to know if you could repair a cast iron part on a Rockwell Lathe. It depends, some cast iron can be welded and some can not.

## BUY AND SELL

Want to Buy--Ronnie Derks needs a 6 x 48 Sander--694-6040.

For Sale--Bob Soderblom--Fine Woodworking Magazines Issues 1 thru 49--sold as set only \$100 ---466-1223.

For Sale--Ken Sullivan has a Sears 10" Table Saw--488-2441 after 6 P.M.

## **SAFETY**

This column is to aid the woodworker in safe procedures, whether he or she has been butchering wood for a long time or just begun. All should refresh ourselves from time to time on safe operating practices.

Some of the best Rules of Thumb (so you can keep your Thumb or any other parts prone to damage) is 1). Never start an operation if you're in a hurry, if you haven't got time, Don't Rush just Don't Start. 2). If you're Tired, do not work in your shop just because you have to finish a project, wait and start when you're Fresh and Rested. 3). Don't drink alcoholic beverages, or take any kind of drugs (over the counter, something your doctor gave you that you might be unfamiliar with or illegal drugs. Some people have allergies to the dust in their shop, if you have to take an allergy drug make sure it doesn't make you drowsy.

The Following Article is from the Power Tool Institute on Routers.

The widespread use of routers is based on their ability to perform an extensive range of smooth finishing and decorative cuts.

Your safety in operating a router starts with an understanding that it operates at a very high speed--in the 20,000 RPM range. From 15 to 25 times faster than a drill.

Always wear safety goggles or safety glasses with side shields complying with current national standard, and a full face shield when needed. Use a dust mask in dusty work conditions. Wear hearing protection during extended periods of operation.

Do not wear gloves, loose clothing, jewelry or any dangling objects, including long hair, that may catch in rotating parts or accessories.

Install router bits securely, and according to the owner/operator's manual.

Always use the wrenches provided with the tool.

Keep a firm grip with both hands on your router at all times...failure to do so could result in loss of control, leading to possible serious injury.

Read your operator's manual carefully regarding laminate trimmers and other small routers that are used one-handed.

Always face the cutter blade opening away from your body.

When starting a router equipped with a carbide tipped bit, the router should be started beneath a work bench to protect operator from a possible flying cutter should the carbide be cracked.

Hold only those gripping surfaces of the router designated by the manufacturer. Check your owner/operator's manual.

If your router is equipped with a chip shield, keep it properly installed.

Keep your hands away from bits or cutter area when the router is plugged in.

Do not reach underneath the work while bits

are rotating. Never attempt to remove debris while the router is operating.

Always disconnect the plug from the electrical outlet before changing bits or making any adjustments. If you are changing a bit immediately after use, be careful not to touch the bit or the collet with your hands or fingers, they could get burned because of heat build-up from cutting.

Your desired cutting depth adjustments should be made only according to the tool manufacturer's recommended procedures for these adjustments. Tighten adjustment locks. Make certain that the cutter shaft is engaged in the collet at least 1/2 in.

Be certain to secure clamping devices on the workpiece you are using before operating your router.

The switch should be in the "off" position before plugging into the power outlet.

For greater control, always allow the motor to reach full speed before feeding the router into the work.

Never force a router.

When removing a router from your workpiece, always be careful not to turn the base and bit toward you.

Unplug and store your router immediately after use.

A router can inflict serious injury in the hands of children or the untrained.

Always check your owner/operator's manual carefully.

## **FEBRUARY MEETING**

**WHEN:** FEBRUARY 10, 1990 9:00 A. M.

**WHERE:** BAYLAND COMMUNITY CENTER  
ON BISSONNET AT HILLCROFT

**DIRECTIONS:** For map refer to your December Newsletter. Go out the Southwest Freeway (Highway 59 South) take the Hillcroft exit. Go south on Hillcroft, turn right on Bissonnet and the Bayland Community Center is on the right. Follow the signs in the park to the community center.

**PROGRAM:** The program has not been confirmed by the newsletter printing deadline, but we will have a program, it will just be a surprise.

**SEE YOUR THERE---YOU DON'T WANT TO MISS THE SURPRISE.**

## **1990 MEETING DATES**

Normally all our meetings are on the 2nd Saturday of the Month the only exception this year will be the April Meeting. Due to Easter our April Meeting will be the 3rd Saturday and not the 2nd Saturday. You might want to mark your Calendars so you won't wonder why your April Newsletter is late.

The March meeting will be March 10th and the April Meeting will be April 21.

# Pasadena Industrial Supply

Power Tool & Accessory  
 Headquarters for;  
 Delta Machinery, Porter-Cable  
 Milwaukee, Hitachi, Bosch,  
 Ryobi, Makita, Skil.  
 Saftey-Speedcut & More!

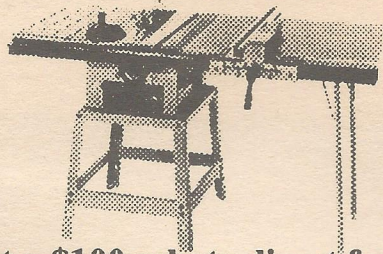

## Ripping Special!

Delta# 34-445 10" Contractor saw with 1-1/2hp mtr runs on 115/230v with the new Delta Unifence that provides a 32" Rip to the right of the blade with an accuracy of 1/64". Presswood top not included!

**Only \$ 739.00**

**AND** Get a \$100 rebate direct from DELTA thru Feb 28  
 222 West Pasadena Freeway, Pasadena Texas 77536 472-5588

## Hardwood Lumber Co. Lawndale Division Imported and Domestic

Marine Plywood  
 Parana Pine  
 Teak

Honduran Mahogany  
 Exotic Hardwoods  
 Domestic Hardwoods  
 WALNUT - BIRCH - ASH - CHERRY  
 CYPRESS - RED AND WHITE OAK  
 AND OTHERS

Quality  
 Hardwoods - Softwoods - Plywoods  
 Mouldings & Squares

MON. - FRI. 7:30 TO 4:30  
 SAT. 8:00 TO 1:00

5401 Lawndale  
 (713) 921-6131

A COMPLETE SELECTION OF FINISHING SUPPLIES.

Exp. 12/90

Come in and checkout our over arm router system.

Check out our hard woods - Bowl and spindle stock - Exotic  
 hardwoods - Best prices intown.

### Hours:

Mon, Tues, Wed, & Fri:  
 9:00a.m. to 6:00p.m.  
 Thurs: 9:00a.m. to 9:00p.m.  
 Sat: 9:00a.m. to 5:00p.m.



### Shopsmith Inc.

Northway Shopping Center  
 10965A Northwest Frwy.  
 Houston, TX 77092  
 Phone: (713) 681-5200  
 Exp. 1-90

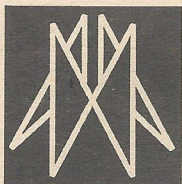

## AUSTIN HARDWOODS

13001 VETERANS MEMORIAL DR.  
 HOUSTON, TEXAS 77014

**440-0764**

We stock over 80 species of lumber including rare exotics and turning stock. Plywood, Veneer, Moulding, Flooring, Tools, Millwork, Paneling Etc. also available

Exp. 8/89

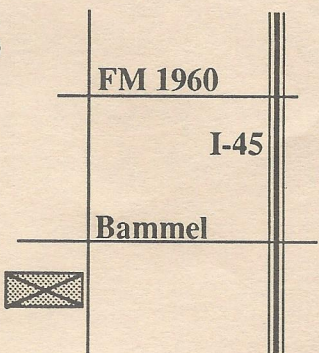



Woodworkers Club of Houston  
P.O. Box 34481  
Houston, Tx 77234

## Houston Wood and Tool, Inc.



DAP Weldwood®  
Hobby & Craft Glue



DAP Weldwood®  
Plastic Resin Glue

- **Classes**
- **Fine Hand Tools**
- **Power Tools**
- **Portable Electric Tools**

**Visit our showroom. Open Monday to Saturday**  
**Mon, Tues, Wed & Fri 8 to 5, Thurs 8 to 8, Sat. 9 to 4.**  
**Come by or call 680-1744 - City Sales.**  
**Located two blocks west of Highway 290 on 34th Street.**  
**5857 W. 34th Street - Houston, Texas 77092**

Exp. 4/90

## HARDWOOD LUMBER CO.

700 E. 51/2 St. (In The Heights)  
 Houston, Texas 77007  
 (713) 862-6628  
 Hours: M-F 7:30-5:00, Sat. 8:30-1:30

We stock over 65 species of lumber including hard to find exotics!

**Also:** Plywood, Veneer, Moulding, Formica, Custom Milling, Woodworking Tools, Books, etc.

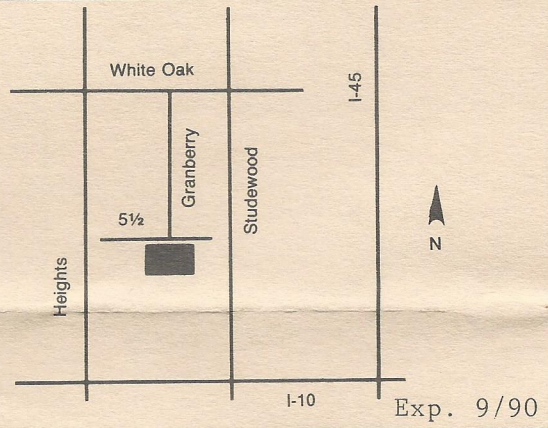

Exp. 9/90

## Send Today for the Most Complete Catalog Selection of Woodworking Supplies

Please Enclose \$1.00 (3rd class) or \$2.00 (1st class)

Name \_\_\_\_\_  
 Address \_\_\_\_\_  
 City \_\_\_\_\_ State \_\_\_\_\_ Zip \_\_\_\_\_

**Orders Shipped Within 48 Hours**

Exp. 1/91

**21801 Industrial Blvd., Rogers, MN 55374**

