

Woodworkers Club

OF HOUSTON

VOL. 5, NO. 2

FEBRUARY, 1989

Officers

Bill Hochmuth - President 774-1733
Bill Sallans - Vice President 465-0291
Bill Baker - Sec./Treasurer 667-8381
Steve Procter - Newsletter Editor 728-1459

Board of Directors

Sharon Buckley - 944-6739
Zatis Murphy - 469-3563
Don Richardson - 661-1365
Gary Wallace - 855-3408

JANUARY MEETING

Fred Collins, a professional woodworker specializing in signs, gave a thoroughly interesting presentation, including a demonstration.

Fred is a self taught woodworker who has built a successful firm with several employees making signs from cypress. He also builds country-style furniture.

The Cypress became available due to a disastrous flood in 1978. He started with a \$120 month shop and \$700 worth of tools. He completed \$120,000 in sales last year.

Fred has built or modified sawmills that handle the hugh cypress logs. He must be careful with the logs, since repeated floods over the years have stressed the logs internally. The upstream side is stressed, downstream is loose. A log can "pop" when a saw releases that tension.

Fred recommends wearing chaps when running chain saws. These heavy leather leg coverings can protect you in the event of chain failure. A sharp chain can rapidly wrap around your leg.

Collins uses many chainsaws, including a special one with a narrow tip the size of a 50 cent piece for roughing out the signs. He uses Porter Cable routers for lettering.

Many thanks to Fred Collins for a fascinating presentation and good luck in your business.

Houston Wood and Tool proprietor Mike Klekar was our site host for the January meeting. Mike was formerly partnered with M. Chandier and Co., which is now concentrating on larger equipment. Houston Wood and Tool will concentrate on hand tools, and may assist the club in group purchases. Thanks to Mike for providing a meeting place.

PROBLEMS AND SOLUTIONS

Henry Reed wanted to know exactly what is Tiger Oak? Tiger Oak is a name applied to figured quarter sawn oak.

Don Sloan suggests use accordian bottles, mustard bottles or squeeze bottles for glue. You can get squeeze bottles for \$1.25 each at a chemical accessories company in the Trade Mart on South 610 Loop.

Robert Sandlin wants to know what to use on an artist pallet-- use Boiled Linseed Oil.

Patrick Quigley -- when installing a Dust collection system, use schdule 20 (light duty) PVC pipe with a copper ground wire throughout to remove static electricity. Without this safety feature, the friction of the sawdust throughout the pvc could create a high voltage spark igniting the sawdust. Sawdust can burn excessively, so this is a must. (The copper wire can also be wrapped around the out side of the pipe.) No matter which way you install the copper wire --it must be GROUND.

Advice on extracting a bolt from a casting--heat the casting to help loosen the item.

CHARITY SALE CHECK PRESENTATION

Mr. Scott Robinson from Make-a-Wish was presented a check for \$3700.00 by Sam Zeisman. This is a new record for the club. Scott presented the club with a plaque of appreciation.

About 50 wishes were granted in 1988. Over 100 are anticipated for 1989.

SAFETY

By Zatis Murphy

A useful shop tool that many woodworkers own is an abrasive bench or stand grinder. Unless used safely, they can be the source of serious injury and property damage.

There are three major hazards in the operation of a grinding wheel: the wheel may break, we may come into accidental contact

with the wheel while it's in motion, and the material being worked may break or get caught by the wheel.

First, no grinding wheel should be operated unless it is provided with the most protective hood that the type of work will allow. Don't use the wheel if the guard is missing or defective. The guard can protect you if the wheel should break apart.

WEAR EYE PROTECTION ! Make sure other persons who may be helping or in the vicinity have eye protection, too. In one of my earlier articles, I described a safety film I saw that was narrated by a man who lost his eyesight while looking over the shoulder of another who was using a grinding wheel. Metal fragments flew off the wheel and pierced the observer's eyes. The man using the wheel was not hurt; he was wearing his safety glasses. The blinded man had his safety glasses in his pocket !

Check the grinding wheel for sprung or cracked flanges. Sometimes wheels break because they are not fitted on the spindle properly, because they run too fast or because the work is forced. Watch out for these potential dangers. Make sure the grinder is securely fastened to the work bench or floor. Also, see that the tool rest is secure and not more than 1/8 inch from the wheel. Never adjust the tool rest while the wheel is turning. Stand to one side of the wheel when the power is turned on and the wheel is gaining full speed. Do not operate the wheel above its rated speed. If the object to be ground is extra large or rough, use special care during the grinding and wear leather gloves.

Safety first + good planning = enjoyable woodworking.....is an equation we can all live with.

BUY AND SELL

Murray Gordon has various tools for sale, including a palm sander, handheld jigsaw and Shopsmith clamp system.

Bob Soderblom is selling antique tools, including an anvil.

Bill Payette is looking for a Planer.

Dan Shaklovitz is selling a Craftsman jigsaw.

Ron Kuenning alerted the membership of an auction of a carpenter's tools.

The late Dr. Bradley's tools are for sale--Bill Hochmuth has a list.

CLUB BUSINESS

There will be new name tags in March--so be sure to pay your dues now. A roster will be printed, as well.

The club video library has been expanded with new tapes, including Repairing Furniture,

Carving, Turning (with an accompanying text) and Router Jigs. See Don Richardson for the sign up sheets.

CLINICS AND WORKSHOPS

Murray Gordon held a Sketching Your Design clinic on January 28.

A new approach on clinics will be tried -topics of interest will be selected, and a presenter will be located. The membership showed interest in some basic courses. We have many beginners, newcomers or woodworkers-that wish to refresh on skills.

Every effort will be made to emphasize those needs.

TREASURER'S REPORT

There is approximately \$1200 in the till. Consistent with the intent to improve our meeting and resources with higher dues, we have recently purchased new tapes, books and attracted new speakers by defering travel expenses.

ANNOUNCEMENTS

Wood World Woodworking Show is coming back to Houston or very near, to Pasadena. March 3,4 and 5 at the Pasadena Convention Center.

Bob Soderblom is working on a field trip to Harden, Tex. to visit The Big Thicket Rockin' Chair manufacturer.

Owners of the Ryobi AP10 Planer should call 1-800-323-4615 ext 235 for a metal outfeed table that prevents mashed fingers. Have your serial # ready.

DUES—DUES—DUES—DUES—DUES—DUES

Speaking of dues--this will be your last newsletter if dues are not paid by the next meeting.

New name tags will be made up for the March meeting--if your dues are not paid up no name tag .

We will be printing a roster book in March --no dues ---no name in the roster book.

JUST A FEW SUGGESTIONS ON WHY YOU SHOULD PAY YOUR DUES A. S. A. P.

IF YOU FIND MISTAKES

.....In this publication, please consider that they are there for a purpose. We publish something for everyone, and some people are always looking for mistakes !!!!!

FEBRUARY MEETING

WHEN: FEBRUARY 11TH 9:00 A. M.
WHERE: ELKS LODGE #151
5230 SOUTH WILLOW DR.

PROGRAM: Carriage Restoration

Calvin Blackwell will tell us about his day-to-day operations and the techniques he and his co-workers use to repair and restore carriages.

DIRECTIONS: Take South Loop 810 and exit on South Post Oak--Go past Willowbend to the next intersection with a Traffic Light, this is Willow turn right. Approximately 6 blocks and your there!

NEWSLETTER INFO

THE MARCH NEWSLETTER
LAST DAY FOR PUBLISHING--FEBRUARY 20, 1989

Pasadena Industrial Supply

Worlds Finest Pad Sander!

Power Tool & Accessory

Headquarters for;
Delta Machinery, Porter-Cable
Milwaukee, Hitachi, Bosch,
Ryobi, Makita, Skil.
Saftey-Speedcut & More!

PORTER+CABLE

Professional finishing sander has a 2.3 amp motor and full 1/2 sheet pad. 10,000 OPM. Comes standard with 3M Stikit pad.

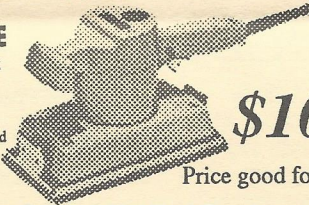

\$105

Price good for members only!

Free Delivery in the Houston area
Major Credit Cards Accepted
Commercial Charge Accounts Available

Porter-Cable #505 Pad Sander

222 West Pasadena Freeway, Pasadena Texas 77536 472-5588 Exp. 11-90

This is the store for everyone who works with wood. Your new Shopsmith store in Houston.

Hours:

Mon, Tues, Wed, & Fri

9:00a.m. to 6:00p.m.

Thurs: 9:00a.m. to 9:00p.m.

Sat: 9:00a.m. to 5:00p.m.

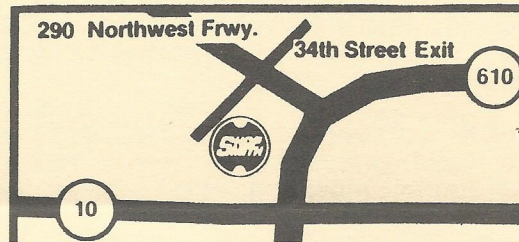

Shopsmith Inc.

Northway Shopping Center
10965A Northwest Frwy.
Houston, TX 77092
Phone: (713) 681-5200

Exp. 1-90

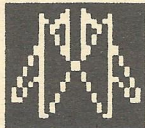

AUSTIN HARDWOODS

13001 VETERANS MEMORIAL DR.
HOUSTON, TEXAS 77014

440-0764

WE STOCK OVER 80 SPECIES OF LUMBER INCLUDING RARE EXOTICS AND TURNING STOCK

PLYWOOD, VENEER, MOULDING, FLOORING, TOOLS, MILLWORK, PANELING, ETC. ALSO AVAILABLE

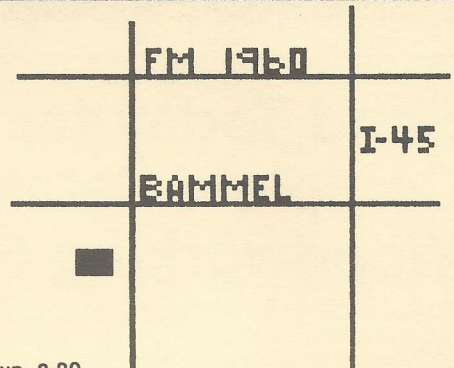

Exp. 8-89

ANNUAL DUES

DEADLINE JANUARY 31, 1989

TO JOIN W.W.C. OF HOUSTON FOR 1989, BRING TO THE REGULAR MEETINGS OR SEND YOUR \$18.00 ANNUAL DUES TO WOODWORKERS CLUB OF HOUSTON P.O. BOX 34481, HOUSTON, TEXAS 77234. MAKE CHECKS PAYABLE TO WOODWORKERS CLUB OF HOUSTON.

Cut off and complete

LAST NAME _____ FIRST NAME _____

HOME PHONE _____ WORK PHONE _____

ADDRESS _____ CITY _____

STATE _____ ZIP _____ SPOUSE'S NAME _____

OCCUPATION/CRAFT:** _____

NAME OF EMPLOYER _____

*OPTIONAL FOR USE IN CLUB "ROSTER BOOK"(TO BE PUBLISHED IN 1989)
FOR SURE THIS YEAR!!!!!!!!!!!!!!!!!!!!

ANNUAL DUES

DEADLINE JANUARY 31, 1989

TO JOIN W.W.C. OF HOUSTON FOR 1989, BRING TO THE REGULAR MEETINGS OR SEND YOUR \$18.00 ANNUAL DUES TO WOODWORKERS CLUB OF HOUSTON P.O. BOX 34481, HOUSTON, TEXAS 77234. MAKE CHECKS PAYABLE TO WOODWORKERS CLUB OF HOUSTON.

Cut off and complete

LAST NAME _____ FIRST NAME _____

HOME PHONE _____ WORK PHONE _____

ADDRESS _____ CITY _____

STATE _____ ZIP _____ SPOUSE'S NAME _____

OCCUPATION/CRAFT:** _____

NAME OF EMPLOYER _____

*OPTIONAL FOR USE IN CLUB "ROSTER BOOK"(TO BE PUBLISHED IN 1989)
FOR SURE THIS YEAR!!!!!!!!!!!!!!!!!!!!

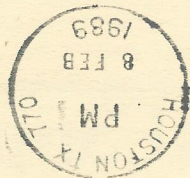

Woodworkers Club of Houston
P.O. Box 34481
Houston, TX 77234

ALLWOOD/SCHROEDER INC

Imported & Domestic

Marine Plywood
Parana Pine
Mahogany

Teak
Exotic Hardwood
Domestic Hardwood

Quality
Hardwood - Softwoods - Plywood
Mouldings & Squares
Self-service

A complete selection of finishing supplies

WALNUT - BIRCH - ASH - CHERRY
CYPRESS - RED AND WHITE OAK
SUGAR PINE AND OTHERS
MON. - FRI. 8:00 TO 5:00

SAT - 8:00 TO 1:00
5401 Lawndale
(713- 921-6131)

Exp. 5/89

HARDWOOD LUMBER CO.

700 E. 51/2 St. (In The Heights)
Houston, Texas 77007
(713) 862-6628
Hours: M-F 7:30-5:00, Sat. 8:30-1:30

We stock over 65 species of lumber including
hard to find exotics!

Also: Plywood, Veneer, Moulding, Formica,
Custom Milling, Woodworking Tools, Books, etc.

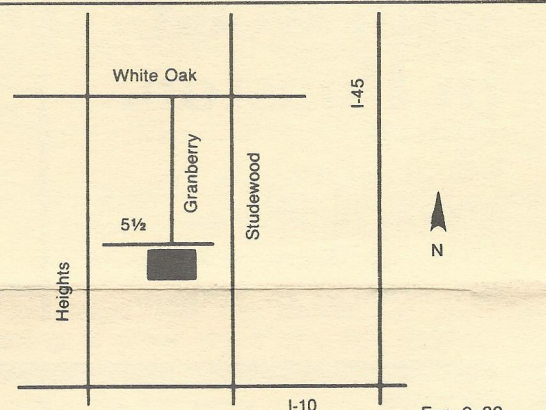

Send Today for the Most Complete Catalog Selection of Woodworking Supplies

Please Enclose \$1.00 (3rd class) or \$2.00 (1st class)

Name _____

Address _____

City _____ State _____ Zip _____

Orders Shipped Within 48 Hours

Exp. 5/89

21801 Industrial Blvd., Rogers, MN 55374

