

# Woodworkers Club OF HOUSTON

VOL. 9, NO. 12

DECEMBER, 1993

## Officers

Bud Froelich - President 859-6620  
Ted Kurland - Vice President 729-4693  
Joe Wainright - Sec./Treasurer 666-8475

## Board of Directors

Art Chester - 469-1990  
Jack Conry - 463-7352  
Denis Muras - 943-7745  
Bill Smith - 356-6509

Sharon Buckley - Newsletter Editor 944-6739

### NOVEMBER MEETING

One of our own members Jacob Schulzinger woodworker, writer and book reviewer was our speaker. His talk was on building your own library, how to choose the books for your library and what to look for in a book review.

Jacob said that he was a writer and not a speaker, but we all found his talk to be very informative and entertaining.

Books are always there for you, a world of information. Friends may forget to tell you all the correct information when you ask them for help but a book is always there for you with the same information in the same book.

As you improve your skills or as your interests change you can learn more each time you look at the same book. When you first start, some projects or techniques may have seemed too difficult to achieve but as you progress with your skills you will be able to try those more difficult projects.

During the 1940's and 1950's there were very few woodworking magazines, now there's a bunch of magazines out there and alot that fold up every year.

Because there are alot of magazines and books available we must be selective in which ones we buy.

Your book purchases will reflect what interest you and what you want to build.

### HOW TO BUILD YOUR OWN LIBRARY

1. Talk to your friends ask them what they like or if you can borrow a book.
2. Use the club library.
3. Try the public library--but as most of us know the public library is lousy for woodwork books.
4. Used bookstores or half-price bookstores.
5. Salvation Army stores.

6. Find authors that you like--some you might like and some you might not.

7. Check out those books before you buy them.

8. Read woodworking magazines, usually authors start by writing articles for magazines and then progress to writing books.

9. Woodworking magazines has its own market and defined readership. Find magazines that interest you and what you can learn.

BOOK REVIEWS---What they can tell us and what we can learn.

1. There are not to many bad books on the market.

2. Magazines get advertising dollars from publishing companies so you will not find many bad reviews of a book in a magazine.

3. It takes about 9 to 12 months for a review to come out after a book is published, if after a year no one has reviewed a book, it may be a bad book.

4. Read the review carefully as it will tell you if it is for the novice or for the more advanced. But even a book geared to the novice can also have good information for the advanced woodworker.

Jacob also donated two books to the club library. Thanks Jacob for the program and the books.

### CHARITY PROJECT--FOOTLOCKERS

It was decided at the meeting that because the holidays are here and everyone is busy that we start building the footlockers in January and delivery them in February. It has

been a long time since we filled out those sheets as to which group we would like to work with or if we wanted to build one in our own shop. So at the December meeting we will have new sign up sheets for each group. If you would prefer to build one yourself you will have to specify at which of these group locations you will pick up your footlocker kits. We will not be bringing any kits to the meeting, its just not feasible to do it any other way.

It was suggested that we only do these in groups but if you would like to build it yourself you probably will have to go to a group location to apply the Danish oil finish.

#### ELECTION OF OFFICERS FOR 1994

Election of officers for 1994 were held and your officers for 1994 will be:

PRESIDENT: SHARON BUCKLEY  
VICE-PRESIDENT: ART CHESTER  
SEC./TREAS.: STEVE PROCTER  
BOARD MEMBERS: JIMMIE HARP  
BUD FROELICH  
TED KURLAND  
JOE WAINRIGHT

We would like to thank them for agreeing to serve and when they ask for your help please say yes.

This club only works when all of the members contribute their time and talents.

#### PROGRAMS FOR 1994

Art has been busy lining up programs for 1994 and Dec. 1993.

In January Jon Hall consultant to the The Bartley Collection will be talking on Bartley's Gel Varnish and Stains, this will be an advanced seminar, next month we will publish a list of some the questions he will answer on Bartley's finish. He will also be fielding questions from the members.

In February Lou Schamble and Tom Coleman of the Stanley Tool Works of New Britain, Conn. will be our guest speakers, not only will they be answering questions like vials and the vial covers replacement in Stanley's mahogany level, but will have door prizes for those members present.

In March Mike the bandsaw blade wizard of Falcon -Auger will speak on bandsaw blades. If you missed the field trip that we took to his shop, don't miss this one.

#### SAFETY

By Zatis Murphy

Extension cords a necessary evil, we all hate to use them but some times you can't get by without using one or more. Some suggestions on the proper use of extension cords.

Check the amps on tools you will be using the

extension cord and use a larger gauge than recommended.

Do not use a frayed extension cord, fix it or throw it away.

Trip hazard--keep that cord out of the way.

If that tool has a 3 prong plug do not remove that third plug use a grounded adapter.

Do not overload that extension cord with too many tools.

You can purchase a 6 outlet adapter that contains an on and off switch, a breaker and some even come equipped with a surg protector.

You can make your own power cords with outlet boxes that will hold two recepticals or more. You must be carefull when you wire them. An inexpensive tester can be purchased at the Hardware store that you plug into the outlet, it will light up and tell you if you have wired it correctly. Zatis used one of these testers to check all of the outlets in his house and found one outlet incorrectly wired.

Zatis has agreed to continue doing the safety programs for 1994 but would like your suggestions on safety subjects.

#### PROBLEMS AND SOLUTIONS

One of the members needed a way to reproduce antique legs--fluting or reeding. He was refered to an article in Fine Woodworkir. on a lathe attachment built to allow the router to travel over the box with an indexing head.

Andy Anderson has a problem with a Sears router in the switch, no one knew of anybody but Sears who would work on it.

Ed Caesar is looking for plans for a Valet chair.

Are peel off strippers any good? They are expensive and do not work that well was the conclusion. Jimmie Harp has found that the new strippers do not work as well as the old ones did.

#### SHOW AND TELL

Ken Wallis made a Maple cradle from plans in Wood October 1987.

He revised the slats from 3/4 inch to 1 inch wide. The cradle swings on bearings and he added a stop to keep the cradle from rocking, by adding a t-nut and knob. Ken finished the cradle with four coats of Bartley's.

Ken also showed us a stave bowl made out of Walnut and Maple which does not look like a stave bowl.

A diagonal design bowl of Walnut and Maple

## Houston's Most Complete Woodworking Supply

- Henry Taylor Carving & Turning Tools
- Woodworking Machinery by Jet, Bosch, Porter-Cable, Foredom, Sugingo, Carba-Tec & Others
- Accessories, supplies, books and videos
- European & Japanese-Style Hand & Edge Tools
- Woodworking Instruction In Our 600 sq. ft. Shop

Woodworking Solutions<sup>®</sup>

12/94



The  
**CUTTING** **EDGE**, Inc.

Woodworker's Tool & Supply

7123 SW Fwy @ Bellaire Blvd. (713) 981-9228

### DECEMBER'S FEATURE PROJECT DESK TOPPERS

Any items made of wood that you would find on a desk top. Pencil cups, stamp holders, name plates, desk trays, etc.

### LATE VIDEO TAPES AND LIBRARY BOOKS

Some of the members have failed to return those tapes and books. We need to get them back by the end of the year. Be sure and check that you haven't forgotten to return them. Bill Woods and Denis Muras has a list and would like to remove your name from it.

### NEW ADVERTISER

We would like to welcome a new advertiser to our newsletter. The Cutting Edge, Inc. Woodworkers Tool and Supply at 7123 S. W. Freeway at Bellaire Blvd. See above ad for a sampling of what they carry.

### WOODWORKING CLUB BAR-B-QUE AND DEMONSTRATIONS AND DOOR PRIZES

To start the year off we are having a Bar-B-Que get together.

Here's whats on the program:

Saturday March 19th Noon we will have Bar-B-Que lunch, followed by Woodworking Demonstrations for woodworkers and for the ladies. We will have Door prizes for the woodworkers and Door prizes for the Ladies.

Cost of the meal has not yet been nailed down but will not exceed \$10.00 per person. I already have some volunteers for demonstrations but will be asking for more volunteers. Next month we will have more details and start collecting for those who would like to attend. If you would like to volunteer your talents or have any ideas for demonstrations let me know ( Sharon that is).

### NEW LOCATION

Houston Hardwoods has moved to a new location --see there ad for the details.

**A Purpleheart and Birdseye Maple bowl.**

Ken discovered a better way to apply Bartley's on the lathe. After applying the Bartley's to the piece on the lathe let the lathe continue to run a little while, then use a cloth as if you were buffing shoes just don't get the cloth caught, you can get the same results with six coats as with eight coats.

Terry Mc Cafferty showed us some bowls turned with green wood.

He turned a bowl from a Pine Burl, Maple Burl, a Spalted Bowl and a green bowl of Walnut that he left on the shelf for six months to dry to determine the final shape.

Terry said that he did not like using PEG as it left the wood waxy and plastic.

To glue up stave bowls, Terry lays out a piece of masking tape, sticky side up, places half of the pieces on the tape end to end, adds glue and pulls the tape around, he now has half of the bowl and does the other half. He matches the two halves together and makes any angle adjustment to the two halves on a sander.

Terry is a relatively new member who was active in the Woodworking Club in Tulsa, Oklahoma.

**SHOP TIPS**

One of the tips that we learned from our field trip to Falcon-Auger bandsaw blades was to reduce the build up of resin on your bandsaw blade use Ivory or Lye soap. While the bandsaw is running touch the blade with the soap. Art has tried it with Ivory soap and says that it works great. Use only these types of soap not a cosmetic soap because they contain lanolin and other chemicals that will defeat what you are trying to accomplish.

**FOR SALE OR WANT TO BUY**

For Sale 20 inch Grizzly Planer, 2 speed 3Hp. 220 volt . Contact Sharon Buckley 99 1-3860.

TO JOIN W.W.C. OF HOUSTON FOR 1994, BRING TO THE REGULAR MEETINGS OR SEND YOUR DUES TO WOODWORKERS CLUB OF HOUSTON P.O. BOX 34481, HOUSTON, TEXAS 77234. MAKE CHECKS PAYABLE TO WOODWORKERS CLUB OF HOUSTON. SEE FORM BELOW FOR DUES INFORMATION.

Cut off and complete

---

LAST NAME \_\_\_\_\_ FIRST NAME \_\_\_\_\_

HOME PHONE \_\_\_\_\_ WORK PHONE \_\_\_\_\_

ADDRESS \_\_\_\_\_ CITY \_\_\_\_\_

STATE \_\_\_\_\_ ZIP \_\_\_\_\_ SPOUSE'S NAME \_\_\_\_\_

**DUES FOR 1994**

Dues for 1994 will be due by the January 8th Meeting. If your dues are not paid by then your name will not appear in the membership book that we put out each year and we also make name badges at the same time.

Remember renewal dues are \$18.00 a year no matter what month you join in 1994. Prorated dues are only for new members. So get those dues in on time, because we want to get that new membership book and new name badges out in February.

**DECEMBER MEETING**

WHEN: DECEMBER 11, 1994 9:00 A. M.

WHERE: BAYLAND COMMUNITY CENTER  
HILLCROFT AT BISSONETT

PROGRAM: Dale Zimmerman of Franklin International, Technical Service Representative, Construction Adhesives and Sealants will answering questions which are frequently asked about wood glues, for some of these questions, the answers may vary depending on the glue involved, but for most, the same answer applies regardless of the specific glue being used.

1. What is the shelf life of the glue?
2. How can I tell if the glue is too old?
3. Will freezing harm wood glue?
4. Will Franklin's Titebond II work with bisquits?
5. Is the moisture content of the wood I am gluing important?
6. What causes sunken joints to appear several days after I have completed my gluing and finishing?
7. Why does the glue I've been using successfully for months suddenly fail to work?
8. Why are my glue joints turning white?
9. How long do I need to clamp my joints?
10. When has the glue reached full strength?

# Pasadena Industrial Supply

**Last Chance This Year!**



Delta has announced that they will stop selling this special edition unisaw after Dec 1993. So this offer is only good while our supply lasts!

This special edition 3 hp unisaw is the same model we have been selling for years with a small difference, this version does not have the LVC control. 52" uniface is std equipment as is the motor cover and all the other quality items that make a Unisaw the most desired table saw in the U.S. Table boards not included.

**\$1399**

*Merry Christmas from everyone at Pasadena Industrial*

Delta #36-820 3hp unisaw 230v with 52" uniface This price is restricted to members of the H.W.C only!  
 222 West Pasadena Freeway, Pasadena Texas 77506 472-5588



4910 West 34th St, Houston, Texas 77092

Hours: M-F 7:30-5:00 SAT 8:30-12:30

(713) 686-6176 Phone

(713) 686-3217 Fax

## DOMESTIC & IMPORTED HARDWOODS

Ash, Basswood, Birch, Cherry, Mahogany, Maple, Red Oak, White Oak, Poplar, Walnut Etc.

High Quality Domestic & Imported  
 Plywoods, Softwoods, Hardwood Veneer

**We've Moved**

**Please Visit Us At Our New Location**

**4910 WEST 34th STREET**

**(BETWEEN HWY 290 & MANGUM)**

11/94

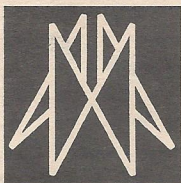

# AUSTIN HARDWOODS

13001 VETERANS MEMORIAL DR.

HOUSTON, TEXAS 77014

**440-0764**

We stock over 80 species of lumber including rare exotics and turning stock. Plywood, Veneer, Moulding, Flooring, Tools, Millwork, Paneling Etc. also available

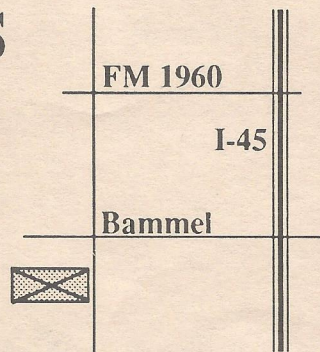

2/94

# WOODWORKING • UNLIMITED™

THE EQUIPMENT, THE TOOLS, THE ACCESSORIES, THE WOOD, THE HOW-TO INFORMATION, AND MOST IMPORTANTLY, THE ENCOURAGEMENT. THE WORKS.

**Service  
 Selection  
 Quality  
 Value  
 Education**

- ◆ FREE Woodworking Classes
- ◆ Frequent Shopper Discount for Wood
- ◆ Large selection of hardwoods & exotic woods
- ◆ Make your own sawdust - try out the equipment
- ◆ Expert advice and instruction

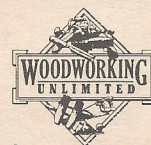

Mon-Fri: 10-8  
 Sat: 10-6  
 Sun: Noon-5

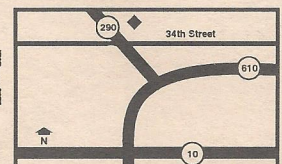

Northbrook Shopping Center  
 5360 West 34th St. • Houston, TX  
 (713) 681-5200

# HARDWOOD LUMBER CO.

700 E. 51/2 St. (In The Heights)  
Houston, Texas 77007  
(713) 862-6628  
Hours: M-F 7:30-5:00, Sat. 8:30-1:30

We stock over 65 species of lumber including  
hard to find exotics!

**Also:** Plywood, Veneer, Moulding, Formica,  
Custom Milling, Woodworking Tools, Books, etc.

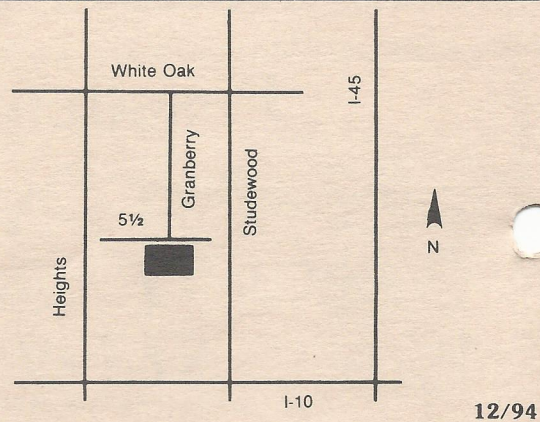

## Send Today for the Most Complete Catalog Selection of Woodworking Supplies

Please Enclose \$1.00 (3rd class) or \$2.00 (1st class)

Name \_\_\_\_\_  
Address \_\_\_\_\_  
City \_\_\_\_\_ State \_\_\_\_\_ Zip \_\_\_\_\_

*Orders Shipped Within 48 Hours*

7/94

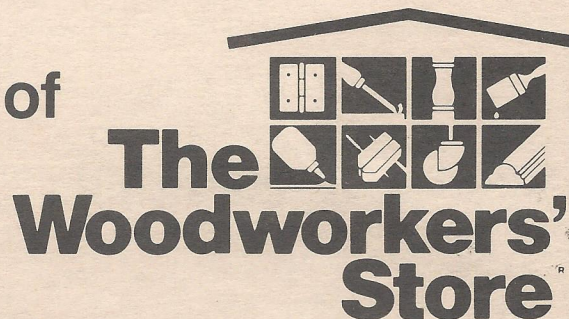

21801 Industrial Blvd., Rogers, MN 55374

PRINTED BY SPEEDY PRINTING SERVICE OF TEXAS 3433 WEST ALABAMA, SUITE C • HOUSTON, TEXAS 77027 • 713-877-8466

Woodworkers Club of Houston  
P.O. Box 34481  
Houston, Tx 77234

