

Woodworkers Club of Houston

Volume 12, Number 8, August, 1996

July Meeting

The directories will be mailed out to the members who did not receive their copy at the meeting. Name tags and membership cards are coming soon.

Visitors:

We had one return visitor and several new visitors. I apologize for not getting all your names. We invite you to join the club. The dues are \$24.00 per year and are prorated for first year members to the end of the year.

Safety:

Clamp your work in a vise if you are going to do any drilling or drive screws into it with a screw driver. It may save you from stabbing yourself in the hand.

Want Ads:

Mike Turner has a friend looking for a 10" Delta Contractor Saw.

Steve Proctor is looking for someone to build jigs and fixtures to cut parts for display kits. Equipment and materials are supplied.

New Books:

"The Picture Frame Book" by Pete Bingham
"Restoring, Tuning, & Using Classic Woodworking Tools" by Michael Dunbar. Donated by Dean Hemphill.

New Videos:

"Wood Turning Projects" by Richard Raffin.
"Wood Carving Caricatures" by Tom Wolfe.

Charity Project:

Approved by the membership. The Board will

seek a charity that needs our services and present their findings at the next meeting. If you have any suggestions, contact Saul Harris or your favorite board member. A thank you letter from last years project is included in the newsletter.

Problem:

What is the best method of cutting a taper on a long board?

Solution:

Draw a line on the board and cut to the line.

If you have more than one board and want them to be the same, make a carrier board with alignment pins and clamps.

Check out "Jigs & Workshop Furniture" from the WwCH library. It has plans for a taper jig in it. Thank you Denis.

Don Richardson has a data base of magazine articles in his computer. If you need information on something you want to build, he can run a search and tell you which magazines have the information you need.

Raffle:

Some lucky person won the dovetail saw donated by Woodcraft Supply.

Dean Hemphill won the C-clamps donated by Woodcraft Supply.

Lewis Vallette won the Handihone donated by Woodcraft Supply.

David Smith won the Gripmate donated by Brad Hartman.

George Fletcher won the Caster foot donated by Brad Hartman.

Gus Reyes won the shaft & pulley assembly donated by Brad Hartman.

A Craftsman Flex Shaft Grinder was donated by Brad Hartman.

Show and Tell:

Larry Barnes had the table saw miter jig for cutting edge banding to length and the gage for marking the corner for the miter cut. He buys his plastic from Woodworker's Supply and A-1 Plastics. He buys his T-nuts from Bruss and he says they are the best made. He used the suggestions in the last issue of "Fine Woodworking Magazine" to make the jig.

Lewis Vallette showed his segmented bowl and plate. The bowl was made from 192 pieces of cherry, maple and walnut. The plate had 25 segments. He cuts the pieces on a table saw, using a jig for the angles and glues them together in rings and then glues the rings together to make the bowl.

Chuck Maxwell showed why you need a centering pin to line your router up when doing inlays.

Guy Meaders showed his router bit cabinet made from plans in Woodsmith No. 105. He also showed his jig for cutting dovetail keys.

Luna Ford showed his green wood hollow vessel turnings. He said to be sure to wear a mask when turning Chinese tallow. He had multi-centered turnings, lidded boxes and minitures. He uses a slow speed for sanding and sands against the rotation of the part. He starts with a 240 grit paper and works up to 600 grit. He finishes with a polishing compound.

New Members:

Derek Kincaid
1430 Pambrooke Ln.
Houston, Texas 77094
(713) 579-6854

Scott Boyden
10419 Pearl Drive
Houston, Texas 77064
(713) 890-3119

Welcome to the club.

Changes:

Gus Reyes should be Gus O. Reyes.

David Whittaker's address should be 6819
Lakemont Dr.

If you want to put an article in the newsletter, my
Fax No. is 868-3561. Anytime.

Program:

Woodturning by Luna Ford

Luna Ford is one of the best known woodturners in Texas and has demonstrated all over the country.

He started his program by showing how to use a shearing technique with a skew. He recommends that beginners use a dead cup center for a driver. If you have a catch, your wood will stop instead of flying out of the lathe. He also showed how to properly use skews, scrapers and gouges.

As he demonstrated, he gave many helpful hints. When turning long grain, cut from the large diameter to the small diameter. When turning cross grain, turn from the small diameter to the large diameter. Always keep the bevel on the wood to keep from getting a catch. The proper RPM creates less heat on your tools.

Luna explained the proper way to grind your tools for different kinds of woods.

He then demonstrated the difference between shearing and scraping. He showed how to turn beads using skews and gouges. He showed the right way to turn small diameters using his finger as a backup. He says to keep the pressure to the tail stock or the head stock, not against the wood or it will break.

Luna gave a very interesting and informative program. He recommends tapes by Richard Raffin which we have in our library. I look forward to seeing Luna do another program.

Official WwCH Knit Shirts can now be ordered in small quantities. If you order your shirt at the August meeting, it should be ready at the September meeting.

Prices are:

Small, Med., Lg., XLg.-----	\$24.36
XXLg. -----	\$25.38
XXXLg. -----	\$25.98
XXXXLg. -----	\$27.06

These shirts are embroidered, not printed.

Treasurer's Report:

The balance as of June 28, 1996 was \$5858.36.
The video and book fund was \$625.67.

August Meeting

When: August 10, 1996 9:00 AM

Where: Bayland Community Center
on Bissonnet at Hillcroft

Program: The Dynamics of Joints
by **Don Richardson**

Raffle: Items to be announced

August Program:

The Dynamics of Joints by Don Richardson

A year ago, we discussed "The Dynamics of Wood". Now, after a brief refresher, we will build a table and discuss the dynamics of joints as we go.

What woodcut makes the tightest mortises and tenons? How do mortise and tenon joints work? How do box and dovetail joints work? How should you place the grain in frames and drawers?

The forgoing questions plus how to fix some "oops" are included in the program.

Items Of Interest:

The "Full Moon Saloon" and other Caricature carvings by renowned carvers will be on display at Woodcraft during August.

Woodcraft has "Sawdust Sessions" on Thursday nights from 7:00 - 8:00 PM. Free to the public.

Country at Heart Arts and Crafts Show will be at the Pasadena Convention Center August 24 - 25.

Southern Lady Arts & Crafts Show will be at the Pasadena Convention Center October 12- 13.

Back To Grandma's Attic Craft Show will Be at the Pasadena Convention Center October 19 - 20.

The Wooden Boat Festival at Madisonville Louisiana September 28-29. The largest gathering of historic, antique, classic, and contemporary wooden sail, power, rowing, and steam watercraft in the South.

Bayou Bend is a must see if you like antique furniture, antiques and gardens. They have a large collection of antique furniture and they were featured on "America's Castles" on July 21. There will be a color bulletin of the collection, plus other information in the library. The front page of their press release is in the newsletter.

Jimmie's Corner:

The Northside Splinter Group meets on the first and third Monday of each month from 7:00 - 9:00 P.M. at Jimmie Harp's shop. The address is 848 1/2 West 24th Street. 862-7222. See calendar for dates.

We need a new project now that the workbench and dresser are finished.

Saturday, July 27, Jimmie and I went to see David Cobb's shop. David has a very nice and very clean shop in his garage. David has some very nice tools and they are well maintained. We had a good time talking about his tools and woodworking projects and then David and his wife cooked us a good lunch Thank you David.

About Our Members:

Zatis Murphy is taking chemotherapy treatments for cancer.

Ken Wallis had his leg amputated.

Your suport and prayers would be appreciated.

Officers

President	Saul Harris	341-5373
Vice President	Charles Sylvester	774-6551
Sec'y/Treas.	Clara Pitts	694-7195

Services

Book Library	Bob Gilbertson	869-7081
Video Library	Dennis Muras	943-7745
Literature Search	Don Richardson	661-1365
Name Tags	Mike Turner	988-1485
Coffee	Loretta Buckley	944-6739
	Bill Hochmuth	774-1733

Directors

Andy Anderson	723-1030
Art Chester	469-1990
Jimmie Harp	683-9033
Lee Palfreyman	497-7085
By Reed	980-9793
Mike Turner	988-1485

Newsletter Editor

Bob Gilbertson	869-7081
----------------	----------

Newsletter Distribution

Thad Brown	522-8364
------------	----------

Prince of Peace Catholic Community



19222 Tomball Parkway • Houston, TX 77070-3510 • 713/469-2686 • Fax: 713/469-8418

Art Chester
Wood Workers Club of Houston
14111 Cleobrook Drive
Houston, Texas 77070

May 28, 1996

Dear Art:

I would like to thank you and the Wood Workers of Houston once again for your support and the donation of so many finely crafted toys. As best my memory serves me and my records help, you gave us:

- 101 "Dooley" cars
- 33 other cars
- 5 three legged stools
- 10 circus wagons with animals
- 2 puzzle boxes
- 4 slide boxes
- 10 tic-tac-toe sets
- 2 checker boards
- 4 wagons

In our raffle we raised \$437. We sold some of the toys for a total of \$420. We also gave away many of the toys to area families in need. A few remaining toys we gave to a church in the Denver Harbor area for their poorer families.

All of the money raised through the sale and raffle of the toys you made was used during the Christmas season for families in need of such things as utility and rental assistance and holiday food.

Thank you for giving so generously of you talent and time to brighten Christmas morning for so may children.

May God continue to bless you and those close to your heart.

Sincerely,

S. Linda Jaye Gibler, O.P.
Director, Parish Social Ministry



B A Y O U • B E N D
C O L L E C T I O N A N D G A R D E N S

Media Information:
Michelle L. Dugan
(713) 639-7540

FOR IMMEDIATE RELEASE
Date: July 8, 1996

**BAYOU BEND COLLECTION AND GARDENS
ACQUIRES IMPORTANT PIECES**

Rare joined great chair among major additions to the collection

David Warren, director of Bayou Bend Collection and Gardens, announced the recent acquisition of more than 55 works of art. Acquisitions were made in many areas, including silver, paintings, glassware, furniture and range from as early as 1640 to as late as 1870.

"Bayou Bend is committed to providing an extensive collection of quality American decorative arts," Warren said. "These recent additions greatly enhance the renowned collection and extend Miss Ima Hogg's vision of Bayou Bend as a premiere American decorative arts center."

One of the most important acquisitions was a 17th-century joined great chair (c. 1640-1685), a very rare form of American furniture long sought by Miss Ima Hogg, who gave Bayou Bend to the Museum of Fine Arts, Houston in 1957. Made in coastal Massachusetts in Essex County, this chair is one of six surviving examples and represents the first in Bayou Bend's collection. The chair was produced by a joiner, a craftsman who makes furniture joined with mortise-and-tenon construction held together with pegs. The flat arcaded crest rail and interlocking semicircles with abstract leaf carving relate to the form and decorative vocabulary of furniture produced in the East Anglia section of England, from which many of the New England settlers came. The absence of any applied turned spindles or geometric moldings suggests that these chairs were made by the first generation of craftsmen trained in the earliest style of joined furniture produced in this country. The chair was a museum purchase with funds provided by Miss Ima Hogg, by exchange.

-more-

ADJUSTABLE ALUMINUM ALLOY BAR CLAMPS---ORDER FORM

NAME _____

ADDRESS _____

PHONE _____

QUAN.	SIZE	LIST PRICE	CLUB PRICE	TAX EACH	UNIT PRICE W/TAX	TOTAL
	24 INCH	24.00	16.37	1.35	17.72	
	36 INCH	26.00	17.52	1.46	18.98	
	48 INCH	28.00	18.60	1.53	20.13	
	60 INCH	30.00	19.83	1.64	21.47	
	72 INCH	32.00	20.98	1.73	22.71	
	UC-76 FACE FRAME CLAMP	18.00	14.00	1.16	15.16	
	UC-76A SHELF &CORNER CLAMP	22.00	15.50	1.28	16.78	
	FEATHER BOARD	20.00	14.50	1.20	15.70	

TOTAL _____

PLEASE NOTE THAT OUR ORDER MUST TOTAL SIZES IN MULTIPLES OF TEN.
 IF WE DO NOT HAVE ENOUGH OF ONE SIZE TO MAKE UP A BOX WE WILL
 CALL YOU AND ASK FOR AN ALTERNATE SIZE.

 MAKE CHECK OR MONEY ORDER PAYABLE TO:

TEXAS SAWDUST WOODWORKS 11026 GREEN ARBOR DR. HOUSTON, TEXAS 77089
 SHARON BUCKLEY PHONE 991-3860 BRING YOUR ORDER TO THE JULY
 MEETING OR MAIL.

HARDWOOD LUMBER CO.

700 E. 51/2 St. (In The Heights)
Houston, Texas 77007
(713) 862-6628
Hours: M-F 7:30-5:00, Sat. 8:30-1:30

We stock over 65 species of lumber including hard to find exotics!

Also: Plywood, Veneer, Moulding, Formica, Custom Milling, Woodworking Tools, Books, etc.

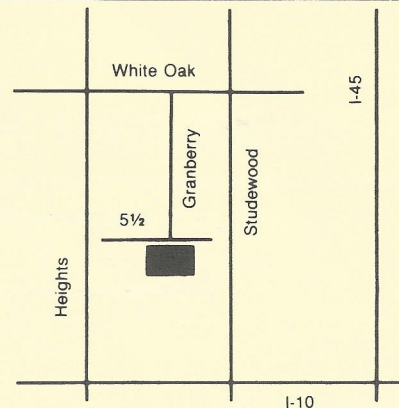

The Lowest Prices On **JET** Machinery Every Day!

All Veritas Tools On Sale Through March
10% Off All JET Dust Control Accessories

EXCEL Polyurethane Glue 250ml : \$7.49

Inkra 16" Ultra Jig System: \$239

NEW JET 13" Planer Moulder: \$789

Makita LS1011 Sliding Mittersaw: \$529

We are an Authorized JET Service Center.

7123 SouthWest Fwy, Just North of Bellaire Blvd. (713) 981-9228

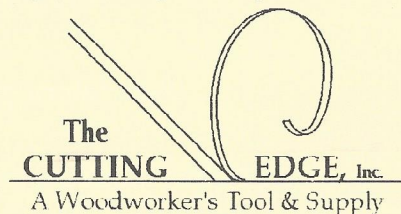

Mon. - Fri. 9 am to 6 pm

Sat. 10 am to 5 pm

Sun. Noon to 4 pm

WwCH Membership

To Join the Woodworkers Club of Houston for 1996, bring this form to a regular meeting or send your dues to:
WOODWORKERS CLUB OF HOUSTON, P.O. BOX 34481, HOUSTON, TEXAS 77234

Make checks payable to Woodworkers Club of Houston.

Renewal Membership \$24.00

New Membership is prorated if 1st year is less than 1 year.

WwCH Membership Form

Last Name _____ First Name _____

Address _____ Spouse's Name _____

City _____ Home Telephone _____

State _____ Zip _____ Work Telephone _____

Renewal Membership \$ _____ New Membership \$ _____

Interests _____



686-6176

FAX: 686-3217

4910 West 34th St, Houston, Texas 77092

Hours: M-F 7:30-5:00 SAT 8:30-12:30

DOMESTIC & IMPORTED HARDWOODS

Ash, Aspen, Basswood, Birch, Aromatic Cedar, Cherry, Cypress, Lacewood, Mahogany, Maple, Oak, Padouk, Pecan, Poplar, Purpleheart, Redwood, Sycamore, Teak, Walnut and more.

- *Quality Domestic & Imported Plywood (Interior & Marine)
- *Edgebanding & Veneer
- *Butcher Block Tops
- *MDF & Melamine
- *Moulding
- *PERSONAL SERVICE
- *PROMPT DELIVERY
- *ON-SITE CUSTOM MILLING

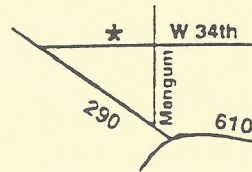

Call 1-800-403-9736 Today!

**FREE!
CATALOG**

You'll find over 4,500
woodworking products —
including many exclusive
and hard-to-find items!

Filled with hardware, wood,
tools and know how from cover to cover.
Call for your FREE catalog today!



Rockler Companies Inc.

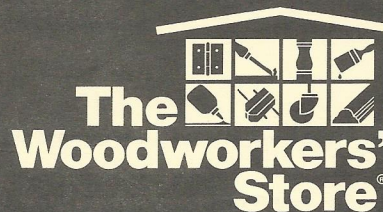

Hardware, Wood, Tools & Know How



WOODCRAFT® Your Most Complete Woodworking Store!

Hand & Power Tools
Sanding & Scraping
Planes
Cabinet Making Supplies
Vises & Clamps
Saws

Carving Tools & Chisels
Wood Boring Tools
Woodburning
Woodturning
Project Kits & Supplies
Shop Accessories
Books & Videos

Hardware
Finishing Supplies
Safety Equipment
Sharpening Supplies
Workbenches
Picture Framing Tools
Classes

Routers & Accessories
Hardwoods & Exotics
Marking & Measuring
Power Tool Accessories
Files & Rasps
Clock Supplies



WOODCRAFT®

Woodworking Tools ■ Books ■ Supplies ■ Since 1928

Woodcraft ■ Northbrook Shopping Center ■ 5360 West 34th Street
Houston, TX 77092 ■ Phone: 713-681-5200

M-W & F: 9AM-7PM ■ TH: 9AM-9PM ■ Sat.: 9AM-6PM ■ Sun.: Noon-5PM

Pasadena Industrial Supply

Porter Cable #9853S 12V Cordless Drill Kit

- Adjustable clutch 10 to 230 in. lbs.
- Two speed ranges: 0-350 & 0-1,000 RPM
- Variable speed, reversing
- Extra battery
- Includes steel carrying case

Must Show Ad
Prices Good For Club
Members Only

\$159

List \$330

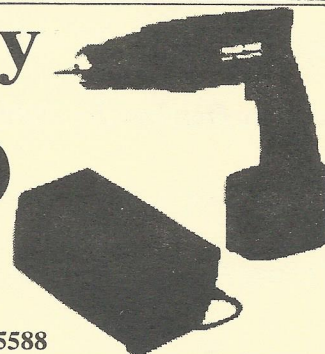

222 West Pasadena Freeway, Pasadena Texas 77506 472-5588

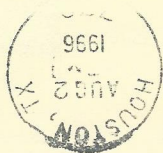

Woodworkers Club of Houston
P.O. Box 34481
Houston, Texas 77234

Printed By: *Speedy Printing Service of Texas*, 3433 West Alabama, Suite C, Houston, Texas, (713) 877-8466

Calendar

(a calendar editor is still needed)

- | | |
|---------------------------|---|
| August 5, 1996 | Northwest Splinter Group at Jimmie & Brian's Shop, 7:00 P.M. |
| August 10, 1996 | Meeting at Bayland Community Center, 9:00 A.M. |
| August 19, 1996 | Northwest Splinter Group at Jimmie and Brian's Shop, 7:00 P.M. |
| September 14, 1996 | Meeting at Bayland Community Center, 9:00 A.M. |
| October 12, 1996 | Meeting at Bayland Community Center, 9:00 A.M. |
| October 26, 1996 | WwCH Bar-b-Q at Jimmie and Brian's Shop |