

Woodworkers Club

OF HOUSTON

VOL. 7, NO. 8

AUGUST, 1991

Officers

Zatis Murphy - President 469-3563
Denis Muras - Vice President 943-7745
Leo Orinderff - Sec./Treasurer 445-5460
Sharon Buckley - Newsletter Editor 944-6739

Board of Directors

Claude Emory - 861-3495
Ted King - 351-6808
Don Richardson - 661-1365
Lewis Vallette - 643-2014

JULY MEETING

The program was presented by Perry Henderson on model building. Perry's background is in heavy equipment where he says people do not share their talents. Ten years ago he began woodworking by making toys and small items.

A few years ago he saw a sheet metal crane that everyone at his work raved about and it wasn't very good---he figured he could make it better out of wood. So he began by taking measurements from original equipment.

He started by making his models out of Oak and in 1/12th scale but he soon realized that he could not get enough detail so he later switched to 1/6th scale.

His models are not toys but used by schools and heavy equipment companies to train their employees without tying up a very expensive piece of equipment.

These models are made one at a time by special order--he does not mass produce them.

Perry had to borrow one of his crane models back from the owner so we could see up close the detail and all of the working parts to his model building.

He also brought along a video tape of some of his work, which included low boys, tractor cabs, concrete trucks, a 50 ton crane complete with outriggers and telescopic boom that extends out and swings.

Perry made a 1980 475 Grove truck crane to demonstrate how to safely use--his model extends to 99 inches.

Because he needed a lot of detail for teaching he switched to 1/6th scale, to include the engine, hydraulic hoses, transmission, hydraulic pumps and 124 inches of boom.

His models are complete with the manufacturers logo and name plates.

On the video he demonstrated a working model of a 1990 F160 Mack Tree Planter complete with the Bulldog Hood Ornament that he carved. This model has stabilizing jacks on each side and the blades that go around the tree and into the ground.

His largest crane weighs 400 pounds, he used 200 board feet of lumber and 188 man hours to build.

Most of his teaching units are at the Texas City School of Cranes.

Perry has even made a 15th Century Crane invented by Leonardo Davinci and powered by hand.

Perry has developed jigs for many of the parts but does not use a lathe duplicator because each time he turns a new part it gets better. The tire treads are made on a indexing jig on the radial arm saw.

He is in the process of building a model with electronic controls, motors that rotate 1/2 RPM and also a motor on the winch.

His models are finished with 6 coats of clear polyurathane.

Because his models are subject to wood expansion and contraction he keeps them in different weather conditions to see how they react.

We would like to thank Perry Henderson for a great program.

OLD BUSINESS

Sam Zeissman reminds us all that the Charity Show is just around the corner and we need lots and lots of Merchandise. In past sales only about 20% of the membership have donated items for sale. If everyone would a least make one item look how much stuff we would have. Of course if you would like to make more than one item, as many members do we would greatly appreciate them.

Bill Hochmuth will be in charge of taking the merchandise to the show--he asks that you start bringing your items in September and if you can bring them to the show yourself it would be greatly appreciated. Don't forget to mark each item with a small tag that includes your member number and price--if you don't want the price discounted include and F after the price.

Guy Meaders chairman of the telephone committee needs one more helper, if your interested please contact him.

WORKSHOPS AND CLINICS

Stuart Murphy has lots of people interested in attending a clinic but needs people to host a clinic--any volunteers.

Ed Burger is hosting a clinic on how to make wood turned pens.

SAFETY

There was no formal presentation planned so Denis asked for suggestions from the members.

One suggestion was to have a separate padlocked circuit box in your shop to protect your children.

One member said to be careful in what you place in your pocket--he forgot and placed a toothpick in his pocket--OUCH.

PROBLEMS AND SOLUTIONS

This month was rare and there were no problems--so no solutions.

At one of the past meetings a member needed a source for tempered masonite--the only place so far suggested is Mc Coy's for 1/4" tempered masonite--any other suggestions?

SHOW AND TELL

This month we had a real assortment of items on display.

Don Sloan made some Gumball/Jelly Bean Dispensers from plans in Wood Magazine. He made 6 for the Charity Show, he said it was just as easy to make 6 as it was to make 1. But be careful when making from plans as the people at Wood made an error which Don wrote them about and got a response. The dowels in his project needed to be colored so he used Rit Dye for a safe color and finished the project with a Salad Bowl finish. Don places the Dry Rit Dye in a stainless steel bowl of hot water, then dips the pieces and set aside to dry.

Stuart says he uses the liquid dye in a bowl, heats the liquid in a Microwave and brushes the color on--any left over dye can be returned to the original container.

Don Richardson made bedside tables to match existing bedroom furniture. Made from Black Walnut with slanted drawers and raised panel doors. Don used his new Inca jig to make the dovetails and the mortises. He finished the project with Bartley's Gel Finishes.

Ed Burger had a display of the wood turned pens that he made after reading the article in American Woodworker Magazine. He said it takes about 35 minutes to make a pen. He also made a Turn of the Century Coal Fired Locomotive from a variety of woods.

Lewis Vallete turned four Bowls, one bowl had

92 pieces, one had 142 pieces one bowl had 168 pieces in the bowl part and 26 pieces in the lid. All finished in 3M.

Bob Gallant made a set of book ends in the shape of books. Plans were in Wood Magazine Dec. 1989.

Stuart Murphy made a Medieval Renaissance musical instrument which was a precursor to the clarinet. He was listed in a magazine from Britain on Early Music and received an order from Japan.

Chuck Maxwell showed how he makes the little molding to hold glass in a frame. He cuts the shape using a rail and stile router bit then he cuts off the molding on a table saw.

FOR SALE OR WANT TO BUY

For Sale: Material and plans to build 7 executive desks and 2 credenzas. Includes photos of finished product, finishing techniques. Desks originally sold wholesale to retailers at \$2400.00 each. Material includes critical pieces: tops, sides, drawerfronts, ribbon stripe sapello (Hon. mahogany) veneer on particle board, with mahogany trim. Additional material required for modesty panel, drawers. Price \$1,000.00. One desk sale pays for all. Steve Procter 728-1459 evenings.

For Sale: Sears Router Table \$10.00 contact Art Chester 469-1990.

AUGUST MEETING

WHEN: AUGUST 10, 1991 9:00 A. M.

WHERE: BAYLAND COMMUNITY CENTER
ON BISSONNET AT HILLCROFT

PROGRAM: Dan Durham with Rice Aviation School will discuss the use of wood in Aircraft Construction.

Shopsmith will be available to demonstrate the Sawsmith 2000 after the General Meeting.

ROSTER CHANGES

New Home phone number for George Pierce is 669-9060.

Steve Procter's office phone number is 937-0101.

If there are any changes to your address or phone numbers please let Sharon Buckley know or you won't get your newsletter and we can't reach you by phone.

SEE YOU AT THE NEXT MEETING!!!!!!!!!!!!!!!!!!!!!!!!!!!!

Pasadena Industrial Supply



\$119

Milwaukee 44` Magnum Go ahead, make your day!

Even Dirty Harry would be pleased! Powerful variable speed reversing 4.2 amp motor runs the 1/2" chuck from 0-750 rpm. Quick connect power cord can be removed in seconds. Changing brushes in the field is a no tool required snap with the spares provided. Reversible side handle provided for extra control. Extremely high quality tool!
Milwaukee# 0244-1 Magnum Hole-Shooter

222 West Pasadena Freeway, Pasadena Texas 77506 472-5588

Hardwood Lumber Co. Lawndale Division Imported and Domestic

Quality
Hardwoods - Softwoods - Plywoods
Mouldings & Squares

A COMPLETE SELECTION OF FINISHING SUPPLIES.

Marine Plywood
Parana Pine
Teak

Honduran Mahogany
Exotic Hardwoods
Domestic Hardwoods
WALNUT - BIRCH - ASH - CHERRY
CYPRESS - RED AND WHITE OAK
AND OTHERS

MON. - FRI. 7:30 TO 4:30
SAT. 8:00 TO 1:00

5401 Lawndale
(713) 921-6131

Exp. 12/90

Your Complete Woodworking Center Check Out Our Hardwoods, Our Prices Are Low

Hours:
Monday to Friday:
10:00 a.m. to 8:00 p.m.
Saturday
9:00 a.m. to 5:00 p.m.

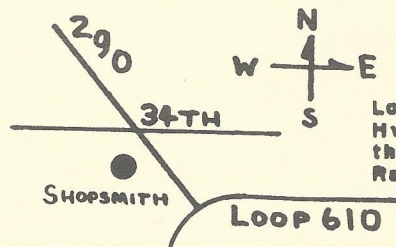

Shopsmith Inc.

Located at 34th St. &
Hwy. 290 to Austin on
the West side in the
Randalle Strip Center.

Northway Shopping Center
10965A Northwest Frwy.
Houston, TX 77092
Phone: (713) 681-5200

Exp. 1/91



AUSTIN HARDWOODS

13001 VETERANS MEMORIAL DR.
HOUSTON, TEXAS 77014

440-0764

We stock over 80 species of lumber including rare exotics and turning stock. Plywood, Veneer, Moulding, Flooring, Tools, Millwork, Paneling Etc. also available

Exp. 8/89

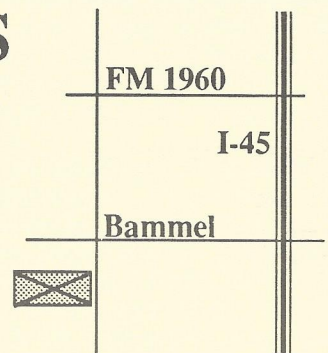

HARDWOOD LUMBER CO.

700 E. 51/2 St. (In The Heights)
Houston, Texas 77007
(713) 862-6628
Hours: M-F 7:30-5:00, Sat. 8:30-1:30

We stock over 65 species of lumber including
hard to find exotics!

Also: Plywood, Veneer, Moulding, Formica,
Custom Milling, Woodworking Tools, Books, etc.

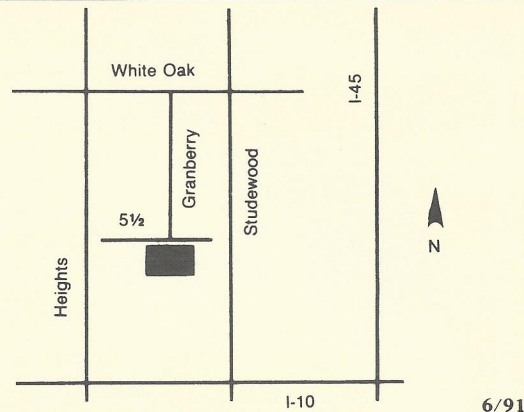

Send Today for the Most Complete Catalog Selection of Woodworking Supplies

Please Enclose \$1.00 (3rd class) or \$2.00 (1st class)

Name _____

Address _____

City _____ State _____ Zip _____

Orders Shipped Within 48 Hours

1/92

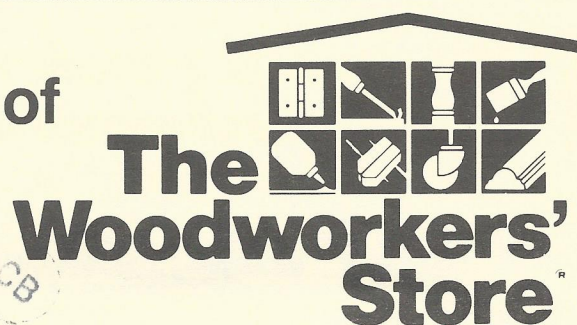

21801 Industrial Blvd., Rogers, MN 55374

PRINTED BY SPEEDY PRINTING SERVICE OF TEXAS 3727 W. ALABAMA, HOUSTON, TX. 77027 (713) 877-8466



5117 April Lane, Houston, Texas 77092
Hours: M-F 7:30-5:00 SAT 8:30-12:30
(713) 686-6176 Phone
(713) 686-3217 Fax

DOMESTIC & IMPORTED HARDWOODS

Ash, Basswood, Birch, Cherry, Mahogany, Maple, Red Oak, White Oak,
Poplar, Walnut Etc.

High Quality Domestic & Imported
Plywoods, Softwoods, Hardwood Veneer
Edgebanding & Hardwood Pliable Veneers
Excellent Service & Competitive Prices!

ON SITE CUSTOM MILLING
TO YOUR SPECIFICATIONS,
S2S, S2SIE, S4S
(No order too large or small)

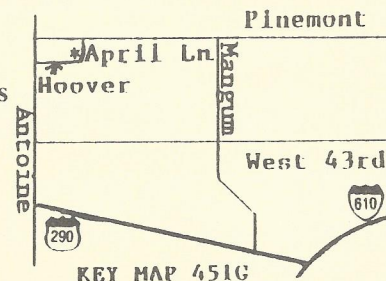

Expires 8/91

Woodworkers Club of Houston
P.O. Box 34481
Houston, Tx 77234

