

# Woodworkers Club

## OF HOUSTON

VOL. 9, NO. 7

JULY, 1993

### Officers

Bud Froelich - President 859-6620  
Ted Kurland - Vice President 729-4693  
Joe Wainright - Sec./Treasurer 666-8475

### Board of Directors

Art Chester - 469-1990  
Jack Conry - 463-7352  
Denis Muras - 943-7745  
Bill Smith - 356-6509

Sharon Buckley - Newsletter Editor 944-6739

### JUNE MEETING

Steve Procter was our guest speaker for the June meeting. Steve gave us an interesting talk on his experiences building a Victorian style playhouse for his daughter.

He started by studying books on Victorian homes, he chose a house that was stereotypical of the Victorian houses built in the mid 1800's.

Similar to his cabinet work he goes into great detail on paper. Making full size drawings, if only of the details, like corners, and parts of doors.

He then makes cut lists, which is remarkably fast and speeds things up when you get to the workshop. Its alot easier to make mistakes with paper and pencil and much cheaper to correct.

Steve says a craftsman knows when to break the rules.

Some people call his playhouse a doll house but there is a big difference between a playhouse and a doll house. A doll house is a perfect scale model, based on a real structure based on people size.

Playhouses are built for little human beings, distorted scale--Disneyesque scale. Which means items are scaled down but still large enough to enter. The scale must fool the eye.

Steve's playhouse has a usable second floor because of the Mansard roof.

Because of the limited size Steve could not build with 2 x 4 studs so he built it in sections in his workshop using 1 1/8" tongue and groove plywood floor sheeting. You can nail into it with out going through to the other side. To cover the outside Steve made his own beaded cedar lap siding. Inside to make the walls look like plaster and be smooth like plaster, Steve put on a skim coat, sanded and primed, so that it would not look like plywood.

To make the outside clapboards, Steve resawed 7/8" thick cedar to 3/8" thick, then used a molding head on his tablesaw, to make a tablesaw bead. Steve then primed and painted the clapboards before installing.

Next he had to make the window sash, he used a rail and stile cutter to make the window material. He had to make his own frames--rabbet for the glass and a window sile that drains, he used a combination router and tablesaw.

Because of lack of scale, To make the playhouse realistic Steve made many changes as he went along, he had to experiment as he went along because some items look good on paper but not on your finished product.

Steve made many of the moldings, but also purchased some. He made all of his own gingerbread using a template and router.

To top it off Steve made 1493 shingles of resawed cedar using a thin kerf blade. Using a shop made gauge to set the shingle, he attached them using a 5/8 " nail gun.

For authenticity he formed his own copper roof sections.

Thanks Steve for an unusual and interesting program, even if you never make a playhouse Steve had some good ideas that could be used for other woodwork.

### SAFETY

By Zatis Murphy

Zatis stressed that what you wear in the shop can be very important to your safety. No loose clothing, if you wear long sleeves roll them up or button them down. No watches or rings, because they can snag and cause an injury. Always wear substantial shoes, no sandals or barefeet. If you wear an apron be sure to tie it in the back not in the front. Gloves should be worn when handling bandsaw blades and tablesaws. Safety glasses are a must and its a good idea to have side shields. In some applications goggles are a must. When using a face shield always wear safety glasses. Use that ear protection when in the shop. When using solvents wear a respirator. For dusty operations use a dust mask and a cap to protect your hair or scalp.



---

## **JULY'S FEATURE PROJECT**

Sit upons--anything that you can sit yourself upon--stools, chairs, benches-etc.

## **SHOW AND TELL**

Chuck Maxwell showed us how he made compound angle cuts. He made a jig that was featured in issue #87 in Woodsmith. He first made some masonite templates to set his miter gauge and tablesaw blade. He also purchased a Woodowrkers guide to compound miters for \$6.50 postage include from Garret Wade.

Bill Hochmuth made a flower stand for his church. Constructed of Red Oak and Walnut, he made a bending jig for the curved legs.

Denis Muras gave us a progress report on his front loader.

Guy Meaders built an entertainment center out of Cherry out of plans from the New Yankee Workshop.

## **LOS AMIGOS DE MESQUITE SHOW AND SALE**

We thought that there might be enough interest in the members participating in a sale for their own profit at the Mesquite show in September, but it seems that there is no interest at all. If you are interested and were not at the last meeting get in touch with Bud, right now it looks like we just will forget it this time.

## **NAME TAG BOARD**

Jack Conry has been in charge of the name tag board, but Jack is retiring to the frozen North----PITTSBURG--so we need some one to be responsible for bringing the name tag board to the meeting--its not a difficult task but an important one--if you would like to help us out please talk to Bud. We would like to Thank Jack for serving the club as Vice-President, a Board of Director and for hauling around the name tag board--we wish you well in Pittsburg and hope when you need a place to thaw out you will visit us some time.

## **LIBRARY**

Ed Smith has been hauling around the library for quite a few years and has to give it up because of back problems. We need someone with a covered truck to be in charge of the library. If you would like to be the first to see the new books, please speak to Bud.

## **BOOKS ON SALE**

Sterling Publishing has offered the members a 40% discount on the books that they publish,

---

we have to order a minimum of 5 books and they must be ordered in one order thru the club. A catalog of their woodworking books will be available at the meeting, if you are interested bring your checkbook.

#### FOR SALE

Magna-set for setting jointer knives on jointer. Original cost \$39.95 Selling \$25.00

Tuara wood from the Mahogany family: clear, knot free stock:

78 pieces of 1 x 6 x 6 foot 1 Lot---\$351.00

42 pieces of 1 x 8 x 6 foot 1 Lot---\$252.00

\$1.50 a board foot or .75 cent a linear ft for the 1 x 6 and \$1.00 a linear ft for the 1 x 8's.

330 plus board feet of Maple, full 1" thick x 4", not 3/4 x 3 1/2". Random length's longest 44" shortest 8". \$300.00

Original Strong Jointmatic with 1/2" Bosch Router includes stand with miter gauge and 45 degree miter gauge and instruction book. Steel and cast Aluminum not the new resin model. \$200.00

20" RBI Hawk Scroll saw on stand with removable Maple stool includes extra blade holders, 2 blade setting gauges and instruction manual. Original cost \$798.00 Selling \$450.00.

Beall Wood Threader, will cut 1/2", 3/4" and 1" inside and outside threads, includes dowel sizing plate. Never used still in original box. \$150.00.

Wagner Safe-T- Planer model DP-1 Never used still in original box. Absolutely safe-impossible to grab or kick back. Can be used on drill press or radial arm saw to cut rabbets, tenons, raised panels and picture frames. \$30.00

Freud Raised Panel Set #94-100 --Used once 1/2" shank 5 bits-- includes Door Lip Cutter, Glue Joint Cutter, Raised Door Panel Cutter, Stile Cutting Bit and Rail cutting Bit---\$125.00  
Contact Sharon Buckley at 991-3860 for further information on any of the above items.

#### JULY MEETING

WHEN: JULY 10, 1993 9:00 A. M.

WHERE: BAYLAND COMMUNITY CENTER  
ON BISSONNET AT HILLCROFT

PROGRAM: The July program will be on Finishing--The Old solvent finishes verses the New Water-Based finishes. Our Speaker will be Susan Neptune of Susan Neptune Heritage Restorations. Susan has been very gracious with sharing her knowledge of finishing. She has also hosted a tour of her shop and answered all questions. If you have a question or problem, bring them with you to the meeting and speak up.



# Pasadena Industrial Supply

## Delta Unisaw Special Edition

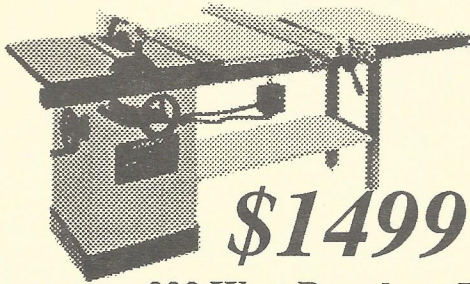

**\$1499**

LIMITED QUANTITY!! This special edition 3 hp unisaw is the same model we have been selling for year with a small difference, this version **does not** have the LVC control. 52" uniface is std equipment as is the motor cover and all the other quality items that make a Unisaw the most desired table saw in the U.S.

Delta #36-820 3hp unisaw 230v with 52" uniface  
Table boards not included

222 West Pasadena Freeway, Pasadena Texas 77506 472-5588



5117 April Lane, Houston, Texas 77092  
Hours: M-F 7:30-5:00 SAT 8:30-12:30  
**(713) 686-6176 Phone**  
**(713) 686-3217 Fax**

### DOMESTIC & IMPORTED HARDWOODS

Ash, Basswood, Birch, Cedar, Cherry, Cypress, Mahogany, Maple, Red Oak, White Oak, Padouk, Poplar, Purpleheart, Redwood, Sycamore, Teak, Virola, White Pine, Walnut, and More.

High Quality Domestic & Imported Plywoods, Softwoods, Hardwood Veneer Edgeworking & Hardwood Veneers  
**Excellent Service & Competitive Prices!**

ON SITE CUSTOM MILLING TO YOUR SPECIFICATIONS, S2S, S2S1E, S4S  
(No order too large or too small)

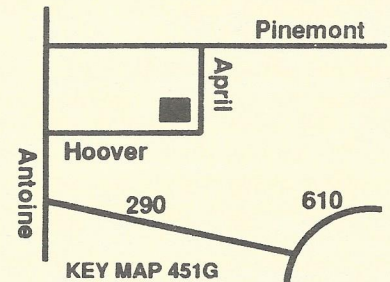

10/93

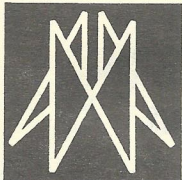

## AUSTIN HARDWOODS

13001 VETERANS MEMORIAL DR.  
HOUSTON, TEXAS 77014

**440-0764**

We stock over 80 species of lumber including rare exotics and turning stock. Plywood, Veneer, Moulding, Flooring, Tools, Millwork, Paneling Etc. also available

Exp. 2/93

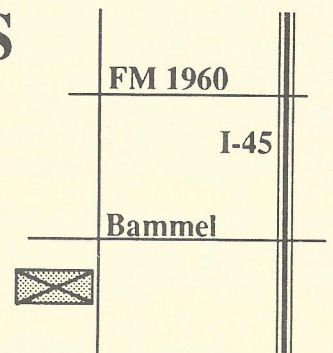

# WOODWORKING • UNLIMITED™

THE EQUIPMENT, THE TOOLS, THE ACCESSORIES, THE WOOD, THE HOW-TO INFORMATION, AND MOST IMPORTANTLY, THE ENCOURAGEMENT. THE WORKS.

Service  
Selection  
Quality  
Value  
Education

- ◆ FREE Woodworking Classes
- ◆ Frequent Shopper Discount for Wood
- ◆ Large selection of hardwoods & exotic woods
- ◆ Make your own sawdust - try out the equipment
- ◆ Expert advice and instruction

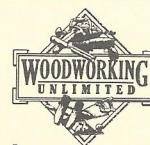

Mon-Fri: 10-8  
Sat: 10-6  
Sun: Noon-5

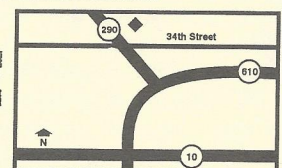

Northbrook Shopping Center  
5360 West 34th St. • Houston, TX  
(713) 681-5200



# HARDWOOD LUMBER CO.

700 E. 51/2 St. (In The Heights)  
Houston, Texas 77007  
(713) 862-6628  
Hours: M-F 7:30-5:00, Sat. 8:30-1:30

We stock over 65 species of lumber including  
hard to find exotics!

**Also:** Plywood, Veneer, Moulding, Formica,  
Custom Milling, Woodworking Tools, Books, etc.

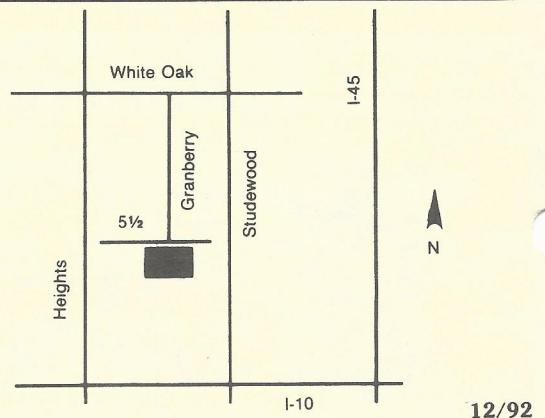

12/92

## Send Today for the Most Complete Catalog Selection of Woodworking Supplies

Please Enclose \$1.00 (3rd class) or \$2.00 (1st class)

Name \_\_\_\_\_

Address \_\_\_\_\_

City \_\_\_\_\_ State \_\_\_\_\_ Zip \_\_\_\_\_

**Orders Shipped Within 48 Hours**

7/93

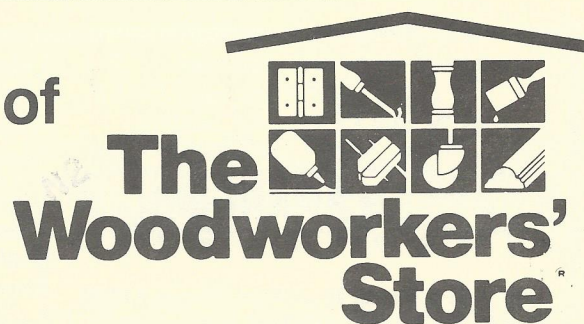

21801 Industrial Blvd., Rogers, MN 55374

PRINTED BY SPEEDY PRINTING SERVICE OF TEXAS 3433 WEST ALABAMA, SUITE C • HOUSTON, TEXAS 77027 • 713-877-8466

Woodworkers Club of Houston  
P.O. Box 34481  
Houston, Tx 77234

