

Woodworkers Club of Houston Newsletter

Volume 17, Number 2, February 2001
wwch.org

Field Trip

On Saturday, March 17th, we will be taking a field trip to Brandle's sawmill in Montgomery. Tom Brandle has agreed to demonstrate how to mill a log into lumber.

He has also donated a log to the club to be raffled off. We will hold the raffle on the day of the field trip and hold the drawing at the sawmill. The winner will select the log of his or her choice (pine, red oak, cedar or cypress) and Tom will then mill it into lumber so that the winner will be able to take his lumber home.

Look for more info at the February and March meetings and

in the March newsletter.

February Program

This month's program will be on the construction and use of a router table.

David Reiss will display a homemade router table and discuss its various features.

He will also show just how versatile it can be and the various bits used.

Membership Changes

Please forward any changes in your membership info to:
Richard Hash
~~713-981-0508~~
richard.hash@openspirit.com

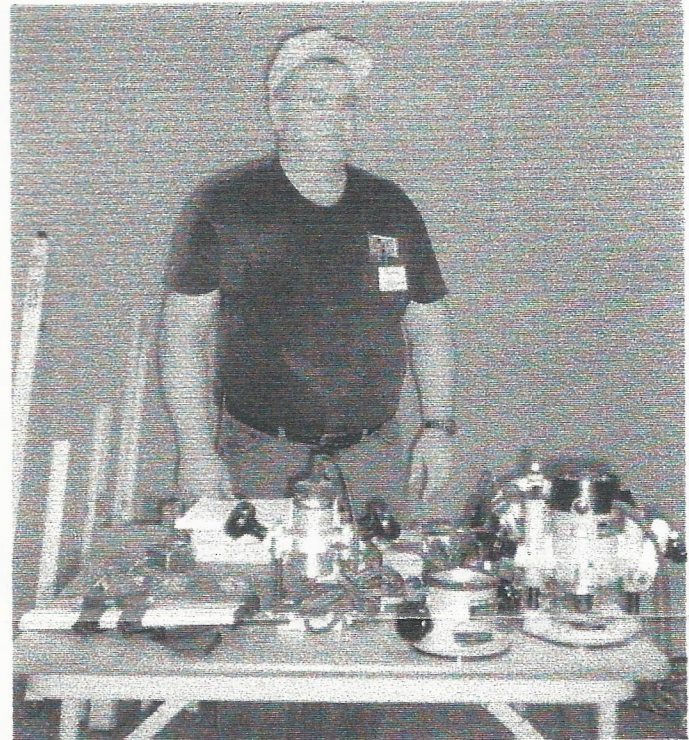

Below - Another great intarsia piece by John Hanna. It was made using carefully selected western red cedar.

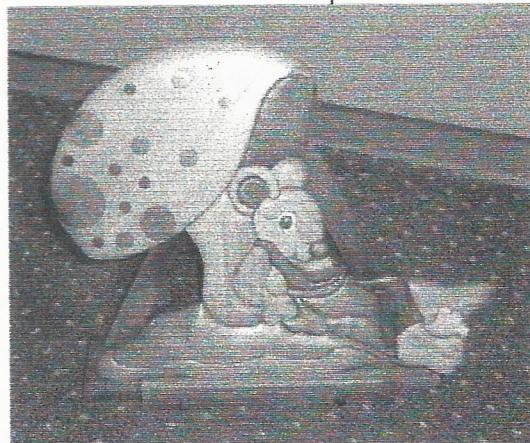

Above - Would you buy a tool from this man? All kidding aside, Mike Turner ready to present the January program on

hand held routers.

**DO NOT PUT THIS
NEWSLETTER
DOWN UNTIL YOU
HAVE READ THIS:**

Can you manage the video library? Can you lug around the book library? Don't have any room for the tool library? Don't want to take home the name tag box? Have a fear of getting up in front of people and presenting? Don't like holding a political office? If your answer to any (or all...) of these is YES, then does the Woodworker's Club of Houston have a deal for you!! We've put together a contest that even the most armchair woodworker can't resist. And what will you win?

**What else? M O R E
T O O L S !!**

Starting in January of this year, we started a membership drive contest. "Why?", you ask yawning. TO GET MORE MEMBERS!!! To make the club a better club for all of us. And who knows, maybe one of these new members will LIKE to present, or they won't mind hauling club stuff home every month. Maybe they will be the one we've all been waiting our natural lives to meet... maybe they'll just bring donuts...

This contest is easier than a cake walk to win. What do you

have to do? Not much at all. All you have to do is to tell someone about the club. Oh, and you have to get them to show up at a meeting too! We're so sure they will like our club, getting them to sign up will be a no-brainer. Why, with all the fun we've been having at our meetings lately, paying \$2 a month for one of the best comedy shows on the circuit is a deal that most will not want to pass up.

Did you know that the majority of the Houston populous doesn't even KNOW that our organization exists? Yes, I know, it's a down right crying shame. But we
(continued pg. 3)

**LAETSCH'S
SERVICE
CENTER**

713-462-2894

**"Servicing
Shopsmith
Headstocks"**

**Not affiliated with
Shopsmith.**

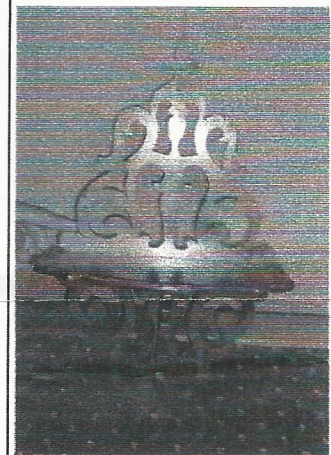

**Above - Don Parker
made this scroll-
sawed shelf out of
birch plywood and
colored it with red
oak stain.**

Featuring the Finest Tools The World Has To Offer

English Hand Tools By Record, Stanley, Henry Taylor, & Robt. Sorby.
Japanese Saws, Chisels & Stones By Gyokucho, Matsumura, and King.
Biesemeyer, Makita, Bosch, Starrett, Irwin, Olson, Jorgensen,
Magna-Set, Freeborn, Lie-Nielsen, & Inca: All Made In The USA.
Canadian Chucks and Hand Tools By OneWay & Veritas.
European Tools by Freud, Tormek, Sjöberg, Stern, & Footprint.

PLUS: The Best Prices On JET Machinery Every Day!

We are an Authorized JET Service Center.

7123 SouthWest Fwy, Just North of Bellaire Blvd. (713) 981-9228

**The
CUTTING EDGE, Inc.**
A Woodworker's Tool & Supply

Mon. - Fri. 9 am to 6 pm
Sat. 10 am to 5 pm
Sun. Noon to 4 pm



713-686-6176

FAX: 713-686-3217

4910 West 34th St, Houston, Texas 77092

Hours: M-F 7:30-5:00 SAT 8:30-12:00

DOMESTIC & IMPORTED HARDWOODS

Ash, Aspen, Basswood, Birch, Aromatic Cedar, Cherry, Cypress, Lacewood, Mahogany, Maple, Oak, Padouk, Pecan, Poplar, Purpleheart, Redwood, Sycamore, Teak, Walnut and more.

*Quality Domestic & Imported Plywood (Interior & Marine)

*Edgebanding & Veneer

*Butcher Block Tops

*MDF & Melamine

*Moulding

*PERSONAL SERVICE

*PROMPT DELIVERY

*ON-SITE CUSTOM MILLING

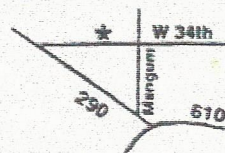

only have ourselves to blame. So help us fix it! Hey, Johnny, tell them what they'll win!

That's right Todd, you can win yourself a BRAND SPANKING NEW, NEVER REMOVED FROM THE BOX DELTA 2 SPEED SCROLL SAW. That's a prize worth winning enough to even sign up your neighbor as a new member out of your own pocket!

So, do you still need incentive? Don't know where to find

another soul interested in woodwork-ing? Here's some help. Next time you go to your local home center, spend a few minutes troll-ing around the lum-ber department (not in a rain coat

though). I would bet you that within 5 minutes, you will see someone looking at lumber with a glazed look in their eyes, trying to tell poplar from pine, or oak from fir. THAT'S YOUR MAN! OR WOMAN!! First, pop a breath mint so

you don't scare them away. Then, ease on over to them and ask them if they are a woodworker, or a wannabe wood-worker.

Show interest in whatever project

they might be work-ing on. Once they decide that you aren't a stalker or mass murderer, they might just strike up a conversation with you. DON'T BLOW IT HERE!! Only tell them enough to get them to the meeting. Don't go on and on

about how you al-ways screw up your projects. Emphasize the "support-group" aspects of our club.

If you haven't no-ticed, or nobody has ever told you, wood-workers are cheap!

That's right, Ke-mo-sabe, cheap. Don't tell them how much membership costs, just tell them how much they can save, because we make bulk purchases all the time. Our club is a place that they can get FREE video training, (continued pg. 4)

**Looking for great quality Power & Hand Tools?
Pasadena Industrial Supply**



222 West Pasadena Freeway, Pasadena Texas 77506 472-5588



3503 EL JAMES

SPRING, TX 77388

(281)350-3005

Laser Engraving for Club Members at Wholesale Prices!!!

Examples: Pens \$ 2.50 each for one side as many characters as will fit.

Rosewood Pen Boxes are just \$ 8.00 engraved (box included)

Need something other than pens engraved? Call me for a quote.

book lessons, FREE help building their shop, FREE harassment and abuse, and a whole lot more.

Once they sign up as a club member, and you've put your gun back in its holster, be sure to tell Todd Burch that YOU and YOU alone got the new member to sign up. If you don't tell him, he won't know, and you won't win. Tell the new member that they will also be eligible for the SCROLL SAW too. the more you sign up, the more chances you will have to win. The contest will conclude at the break in the July meeting, so you only have a few

to act.

So, GO FIND NEW MEMBERS!!! Make YOUR club the best it can be!

Thanks, Todd Burch

Right - A great looking rocker, made from "bowling alley maple". The craftsman was Dan Shaklovitz.

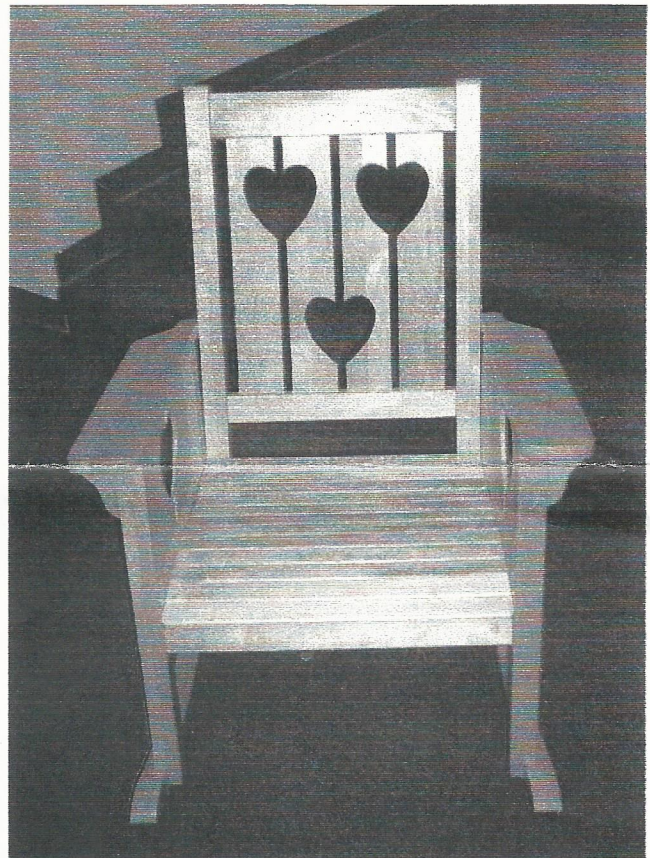

Right - Henry Glenn made this toilet paper holder out of various pieces of scrap wood. He thinks he might be able to real in a whopper!

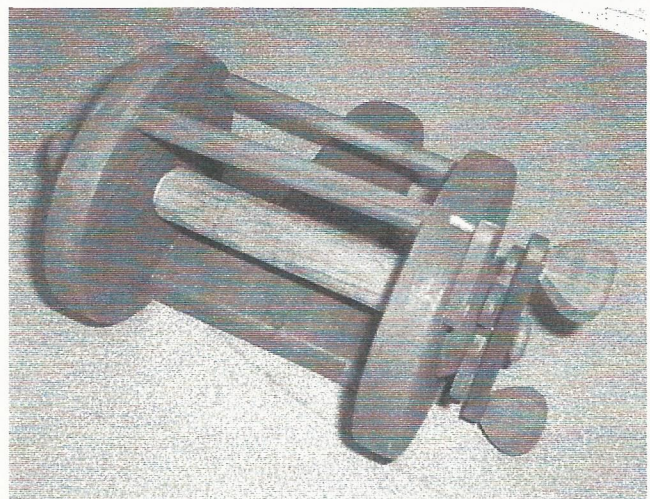

At Your Service

President:
David Reiss
~~409-925-0854~~

Vice-president:
Ricky Givens
~~281-856-9406~~

Secretary/Treasurer:
Brian Honey
~~281-529-8403~~

Directors:
Todd Burch
~~713-973-2778~~

Mike Turner
~~281-346-1544~~

Roy Gilbert
~~281-499-6157~~

Ken Kooser
~~409-293-1676~~

Book Librarian:
Timothy Hendrickson
~~409-266-0120~~

Video Librarian:
Michael Kelly
~~281-357-0127~~

Article Search:
Saul Harris
~~281-341-5373~~

Name Tags:
Joe Edelen
~~281-437-5937~~

Coffee:
Loretta Buckley
&
Bill Hochmuth

Web Master:
Gary Rowen
~~281-486-2015~~
cgrowen@pdq.net

Newsletter Editor:
David Reiss
~~409-925-0854~~
drtty@wt.net

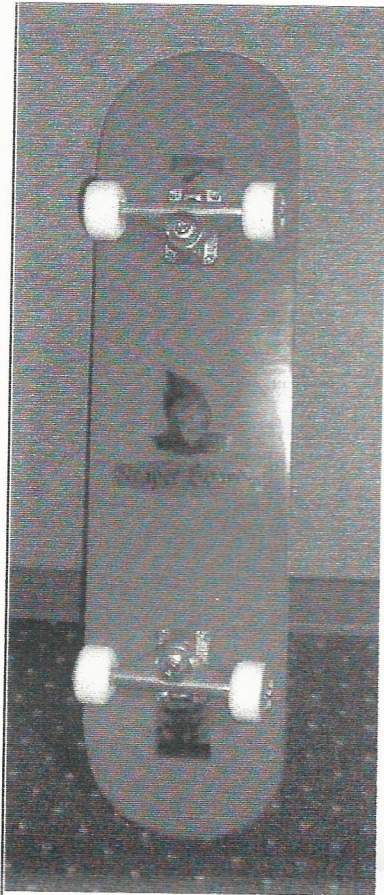

Above - A skate-board made by David Reiss and his son, Kyle.

Right - Slant front desk made by Rob Brayton. This is Rob's second project. It is made of red oak. Great job Rob!!!!!!

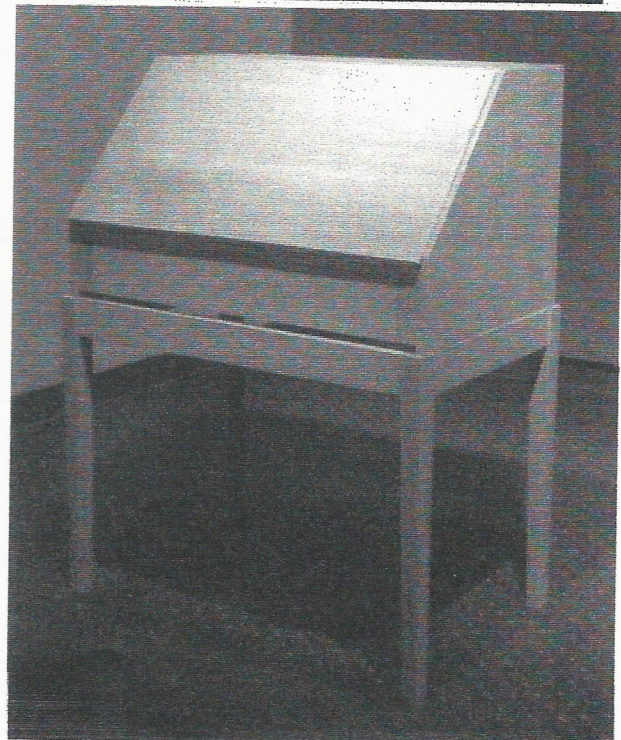

**Brandle's
Sawmill**

**Rough Sawn
Pine and Hardwoods**

**Custom Sawing
Available
Logs up to 36" dia. X
24' long**

**13868 Lakeland Dr.
Montgomery, Texas
77356
409-597-4575**



Woodworkers Club
of Houston
12206 Young Circle
Santa Fe, Texas 77510



[REDACTED ADDRESS]

77062-2622 15



Calendar of Events
for: February

10th - Meeting at
the Bayland
Community Center-
9:00 am



THREE HOUSTON LOCATIONS:

440 HWY. 6 SOUTH
HOUSTON
281-496-0811

5900 N. FRWY.
HOUSTON
713-697-9909

120 GULF FRWY.
LEAGUE CITY
281-332-9201

DEWALT ~ PORTER CABLE ~ DELTA
JET ~ MILWAUKEE ~ MAKITA
HITACHI ~ BOSCH ~ BESSEY ~ RYOBI
"PROUD SUPPORTER OF THE WWCH"